

# GN 134 | Two-way connecting clamps

Aluminium



## MATERIAL

Aluminium, matte finish.  
AISI 304 stainless steel screws and nuts.

## STANDARD EXECUTIONS

- **GN 134-BL:** natural aluminium.
- **GN 134-SW:** aluminium, epoxy resin coating, RAL 9005 black colour.

## FEATURES AND APPLICATIONS

The assembly holes of GN 134 connecting clamps allow an excellent match with tubes GN 990 (see page 1778).

Within the same nominal size the connecting clamp may be supplied with the holes  $d_1$  and  $d_2$ , square holes  $s_1$  and  $s_2$  or in combination with round and square holes.

The clamping screws  $d_3$  may be replaced by clamping kits GN 911 (see page 1782).

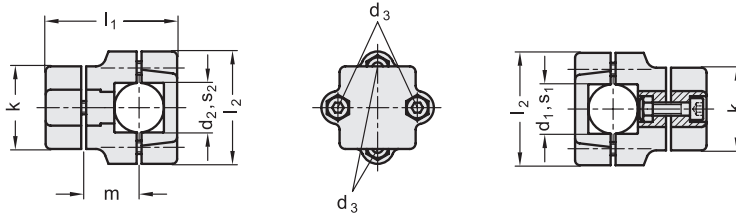
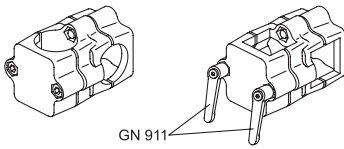

Code BL	Code SW	Description	d1 Hole	s1 Square hole	d2 Hole	s2 Square hole	d3	k	l1	l2	m	d3 Clamping kit	
GN.43811	GN.43816	GN 134-B20-B20-50-2-*	20	-	20	-	M8	50	79.5	68	33.5	GN 911-M8-35	355
GN.43851	GN.43856	GN 134-B25-B25-50-2-*	25	-	25	-	M8	50	79.5	68	33.5	GN 911-M8-35	330
GN.43891	GN.43896	GN 134-B30-B30-50-2-*	30	-	30	-	M8	50	79.5	68	33.5	GN 911-M8-35	320
GN.43911	GN.43916	GN 134-B30-B30-60-2-*	30	-	30	-	M8	60	109	79	50	GN 911-M8-55	700
GN.43971	GN.43976	GN 134-B32-B32-60-2-*	32	-	32	-	M8	60	109	79	50	GN 911-M8-55	690
GN.43991	GN.43996	GN 134-B35-B35-60-2-*	35	-	35	-	M8	60	109	79	50	GN 911-M8-55	680
GN.44031	GN.44036	GN 134-B40-B40-60-2-*	40	-	40	-	M8	60	109	79	50	GN 911-M8-55	620
GN.44051	GN.44056	GN 134-B40-B40-76-2-*	40	-	40	-	M10	76	125	98	55	GN 911-M10-63	890
GN.44111	GN.44116	GN 134-B42-B42-76-2-*	42	-	42	-	M10	76	125	98	55	GN 911-M10-63	945
GN.44131	GN.44136	GN 134-B45-B45-76-2-*	45	-	45	-	M10	76	125	98	55	GN 911-M10-63	915
GN.44171	GN.44176	GN 134-B48-B48-76-2-*	48	-	48	-	M10	76	125	98	55	GN 911-M10-63	915
GN.44191	GN.44196	GN 134-B50-B50-76-2-*	50	-	50	-	M10	76	125	98	55	GN 911-M10-63	885
GN.43831	GN.43836	GN 134-B20-V20-50-2-*	20	-	-	20x20	M8	50	79.5	68	33.5	GN 911-M8-35	350
GN.43871	GN.43876	GN 134-B25-V25-50-2-*	25	-	-	25x25	M8	50	79.5	68	33.5	GN 911-M8-35	330
GN.43931	GN.43936	GN 134-B30-V30-50-2-*	30	-	-	30x30	M8	50	79.5	68	33.5	GN 911-M8-35	310
GN.43951	GN.43956	GN 134-B30-V30-60-2-*	30	-	-	30x30	M8	60	109	79	50	GN 911-M8-55	680
GN.44011	GN.44016	GN 134-B35-V35-60-2-*	35	-	-	35x35	M8	60	109	79	50	GN 911-M8-55	640
GN.44071	GN.44076	GN 134-B40-V40-60-2-*	40	-	-	40x40	M8	60	109	79	50	GN 911-M8-55	580
GN.44091	GN.44096	GN 134-B40-V40-76-2-*	40	-	-	40x40	M10	76	125	98	55	GN 911-M10-63	890
GN.44151	GN.44156	GN 134-B45-V45-76-2-*	45	-	-	45x45	M10	76	125	98	55	GN 911-M10-63	835
GN.44211	GN.44216	GN 134-B50-V50-76-2-*	50	-	-	50x50	M10	76	125	98	55	GN 911-M10-63	770
GN.44231	GN.44236	GN 134-V20-V20-50-2-*	-	20x20	-	20x20	M8	50	79.5	68	33.5	GN 911-M8-35	350
GN.44251	GN.44256	GN 134-V25-V25-50-2-*	-	25x25	-	25x25	M8	50	79.5	68	33.5	GN 911-M8-35	325
GN.44271	GN.44276	GN 134-V30-V30-50-2-*	-	30x30	-	30x30	M8	50	79.5	68	33.5	GN 911-M8-35	300
GN.44291	GN.44296	GN 134-V30-V30-60-2-*	-	30x30	-	30x30	M8	60	109	79	50	GN 911-M8-55	660
GN.44311	GN.44316	GN 134-V35-V35-60-2-*	-	35x35	-	35x35	M8	60	109	79	50	GN 911-M8-55	620
GN.44331	GN.44336	GN 134-V40-V40-60-2-*	-	40x40	-	40x40	M8	60	109	79	50	GN 911-M8-55	560
GN.44351	GN.44356	GN 134-V40-V40-76-2-*	-	40x40	-	40x40	M10	76	125	98	55	GN 911-M10-63	945
GN.44371	GN.44376	GN 134-V45-V45-76-2-*	-	45x45	-	45x45	M10	76	125	98	55	GN 911-M10-63	825
GN.44391	GN.44396	GN 134-V50-V50-76-2-*	-	50x50	-	50x50	M10	76	125	98	55	GN 911-M10-63	825

\* Complete the description of the standard item needed by adding the finish of the connector clamps: BL (blank) or SW (black).

