

# MUELLER®

**MODEL: BU-P3846**

**BNC Panel Mount Connector (Female to Female)**

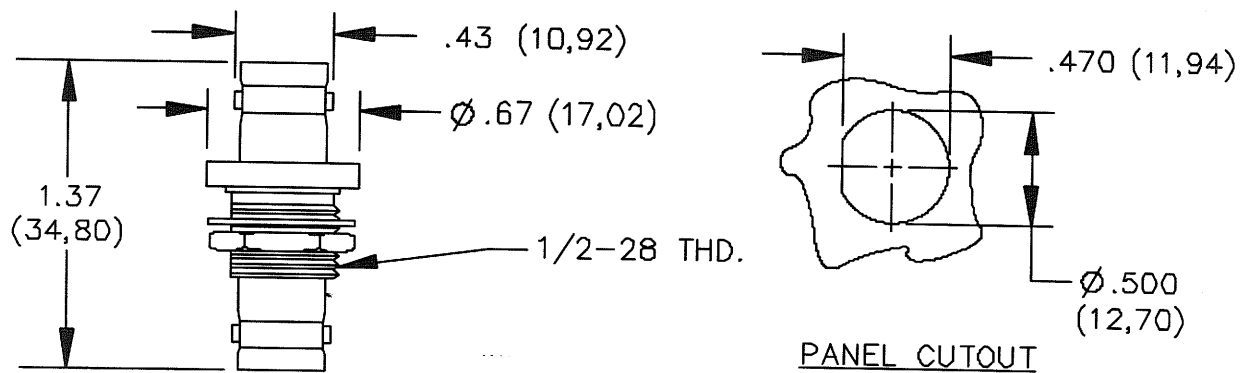

BNC Body is isolated from the mounting flange

Mounts in panels up to .175" (4.45) thick

#### MATERIALS:

Body – Nickel Plated Brass

Contacts – Gold plated Beryllium Copper

Insulator – PTFE

#### RATING:

Voltage: Shield/Contact: 500VRMS Max.

Temperature: -50°C to 170°C

Impedance: 50 Ohms