

Distinctive Characteristics

Fully illuminated toggle for highly visible status indication with LED in red, green, or amber for single color and red/green for bicolor.

Ultra-miniature size allows high density mounting, and extremely light weight makes these switches ideal for handheld equipment.

Totally sealed body construction prevents contact contamination and allows time- and money-saving automated soldering and cleaning.

Molded-in, epoxy sealed terminals lock out flux, solvents, and other contaminants.

Award-winning STC contact mechanism with benefits unavailable in conventional mechanisms: smooth, positive detent actuation, increased contact stability, and unparalleled logic-level reliability. (Additional STC details in Terms & Acronyms; see Supplement section.)

.100" x .100" (2.54mm x 2.54mm) terminal spacing conforms to standard PC board grid spacing. Round terminals facilitate easier through-hole mounting on PC boards.

Nonilluminated toggles available and shown in the Toggle section.

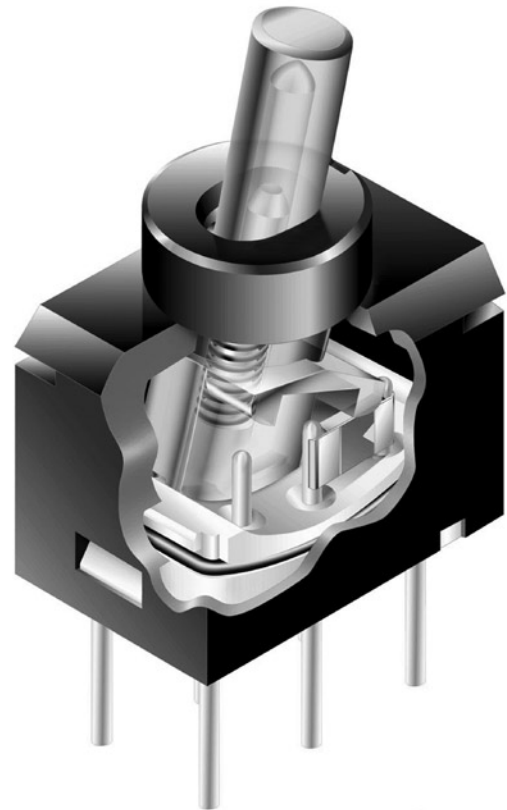

Actual Size

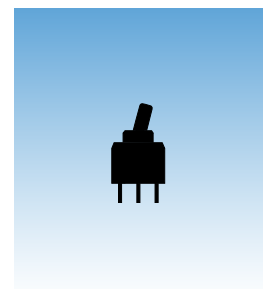

General Specifications

Electrical Capacity (Resistive Load)

Logic Level:

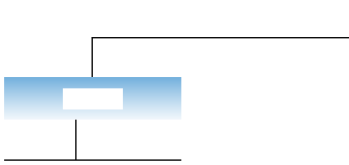

PC TERMINALS

P Straight

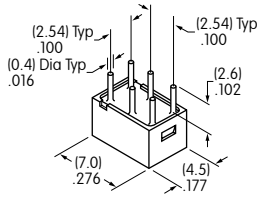

H Right Angle

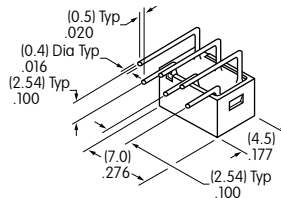

V Vertical

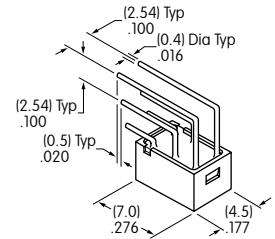

TYPICAL SWITCH DIMENSIONS

Straight PC

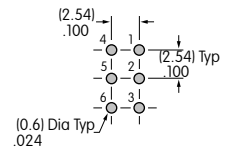
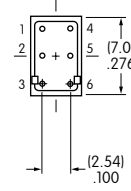
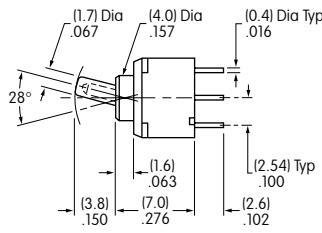
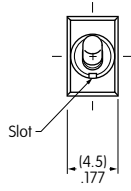

G12JPC

5 & 6 are LED terminals; 4 is a support pin on single color models & an LED terminal on bicolor models.

Right Angle PC

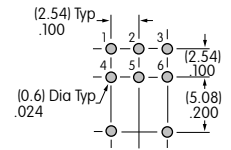
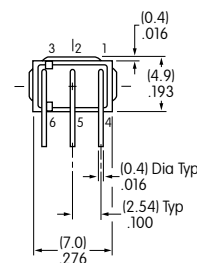
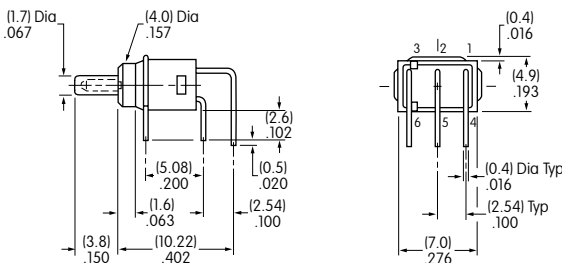
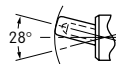
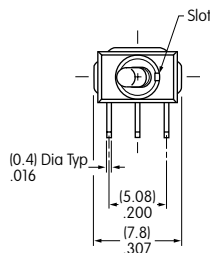

G12JHD

5 & 6 are LED terminals; 4 is a support pin on single color models & an LED terminal on bicolor models.

Vertical PC

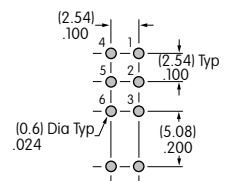
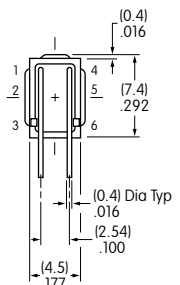
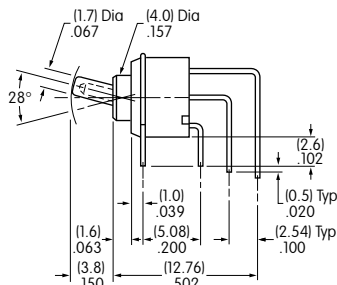
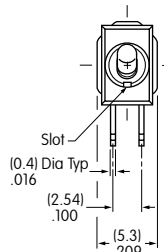
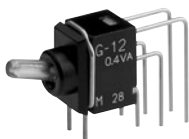

G12JVCF

5 & 6 are LED terminals; 4 is a support pin on single color models & an LED terminal on bicolor models.