

Steckerstifte

Fiches de goupille

Seamless pins

Werkstoff:

MS = Messing

Matière:

MS = laiton

Material:

MS = brass

Oberflächenbehandlung:

Code

bl = blank

(0)

ag = versilbert

(1)

au = vergoldet

(2)

ni = vernickelt

(5)

sn = verzinkt

(8)

Traitements de surface:

Code

bl = brut

(0)

ag = argenté

(1)

au = doré

(2)

ni = nickelé

(5)

sn = étamé

(8)

Surface-plating:

Code

bl = clean

(0)

ag = silver-plated

(1)

au = gold-plated

(2)

ni = nickel-plated

(5)

sn = tin-plated

(8)

Bestellbeispiel:

Exemple de commande:

Example of order:

1364A.68

(1364 A MS sn)

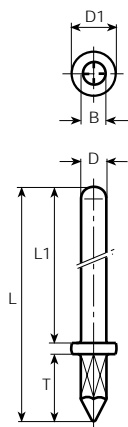

Print Trou Hole	D mm	L mm	T mm	L1 mm	D1 mm	B mm	Werkstoff Matière Material	Stand- Packg. 2'000	Artikel-Nr. Numéro d'article Part-No.	Werkzeug Outils Tools		
Ø 1	Ø 1	9.5	2.4	6.6	Ø 1.8	1.05	MS	•	1364A.6()	1035/85		
		10	3.5	6	Ø 1.8	1.05	MS	•	1364E.6()	1035/85		
		14.1	3	10.6	Ø 1.8	1.05	MS	•	1364S.6()	1035/86		
		10.8	4.5	5.8	Ø 1.8	1.05	MS	•	1364C.6()	1035/85		
		11	4.5	6	Ø 1.8	1.05	MS	•	1364G.6()	1035/85		
		11.5	3	8	Ø 1.8	1.05	MS	•	1364B.6()	1035/86		
		12.5	5	7	Ø 1.8	1.05	MS	•	1364F.6()	1035/85		
		15.5	3	12	Ø 1.8	1.05	MS	•	1364D.6()	1035/86		
		20	3.5	16	Ø 1.8	1.05	MS	•	1364T.6()	1035/86		
		18	6	11.5	Ø 1.8	1.05	MS	•	1364R.6()	1035/86		
		Ø 1.3	Ø 1.3	11	4.5	6	Ø 2.5	1.4	MS	•	1365A.6()	1035/84
				12.5	3.8	8.1	Ø 2.5	1.4	MS	•	1365F.6()	1035/83
				13.5	5	8	Ø 2.5	1.4	MS	•	1365B.6()	1035/83
13.5	5.5			7.5	Ø 2.5	1.4	MS	•	1365C.6()	1035/83		
14.7	2.5			11.7	Ø 2.5	1.4	MS	•	1365D.6()	1035/83		
15.9	5.7			9.7	Ø 2.5	1.4	MS	•	1365E.6()	1035/83		
16	3			12.5	Ø 2.5	1.4	MS	•	1365M.6()	1035/83		
Ø 1.33	9.5			3.5	5.5	Ø 2.5	1.43	MS	•	1365.6()	1035/84	

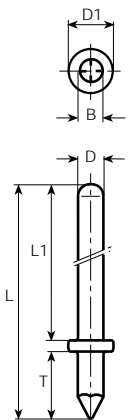

D mm	L mm	T mm	L1 mm	D1 mm	B mm	Werkstoff Matière Material	Stand- Packg. 2'000	Artikel-Nr. Numéro d'article Part-No.	Werkzeug Outils Tools
Ø 1	10	3.5	6	Ø 1.8	Ø 1	MS	•	1364P.6()	1035/85
	11	4.5	6	Ø 1.8	Ø 1	MS	•	1364K.6()	1035/85
	15	8.5	6	Ø 1.8	Ø 1	MS	•	1364M.6()	1035/85
	15.4	6	8.9	Ø 1.8	Ø 1	MS	•	1364H.6()	1035/86
	15.4	9	5.9	Ø 1.8	Ø 1	MS	•	1364L.6()	1035/85
Ø 1.3	16.2	5.9	9.8	Ø 2.5	Ø 1.3	MS	•	1365L.6()	1035/83

Andere Abmessungen auf Anfrage
Autres dimensions sur demande
Further dimensions on request