

- Home
- About Us
- Products
- Technical Assistance
- Distributors & Reps
- Distributors Login
- Contact Us
- Job Opportunities
- Newsletters

**NEWS**

**Series 110**    **DIL - Solder tail**  
2.54 mm, Solder tail

Open frame standard low profile DIL Sockets

**Technical specs.:**

Insulator:                      Black glass filled polyester PCT-GF30-FR  
 Flammability:                UL 94V-O  
 Sleeve:                        Brass CuZn36Pb3 (C36000)  
 Contact :                      Clip (4 finger): Beryllium copper (C17200)  
 Accepted pin Ø:              0.40 to 0.56 mm  
 Insertion Forces:            2 N typ.  
 Withdrawal Forces:        1 N typ.  
                                       (polished steel gauge Ø 0.43 mm)  
 Mechanical life:              Min. 100 cycles  
 Rated current:                1 A  
 Contact resistance:         Max. 10 m  
 Dielectric strength:        Min. 1000 V RMS

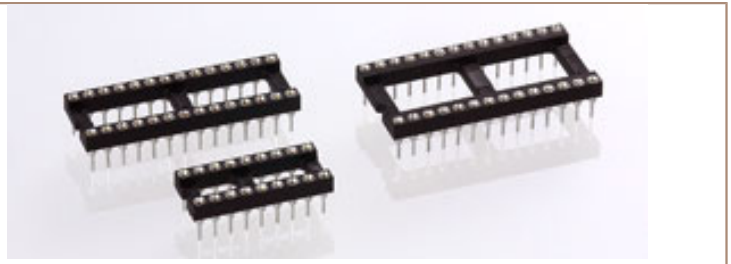

**Ordering information RoHS-compliant parts**

PP Plating code	Sleeve	Clip
<b>87</b>	<b>Tin</b>	<b>Gold flash</b>
83	Tin	Gold 0.75 µm

[General technical specs. ...](#)

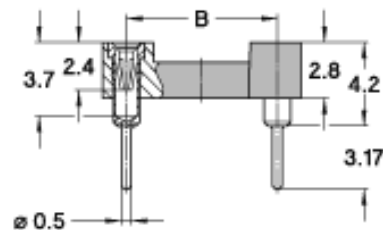

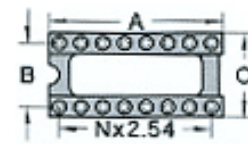

**Options:**

- 1** Insulators without center bar \*  
Open frame insulators 318, 320, 322, 324, 624, 628, 632, 640 and 648 available on special request without center bars; add suffix 151 to the part number. Example  
110-83-628-41-001101 becomes  
110-83-628-41-001**151**
- 2** Sockets with increased solder tail length of 4.2 mm allowing application on multilayer PCBs up to 3.4 mm thickness replace **110-.....** by **111-.....**
- 3** Sockets with soft brass pin series 110-.....-**005101**, please consult
- 4** For DIL Sockets with closed frame insulators replace **110-...** by **210-...**  
Please consult for available pin numbers



	Poles	A	B	C	D	E	See	Order Codes
	10	12.6	5.08	7.6				<b>110-PP-210-41-001101</b>
	4	5.0	7.62	10.1				<b>110-PP-304-41-001101</b>
	6	7.6	7.62	10.1				<b>110-PP-306-41-001101</b>
	8	10.1	7.62	10.1				<b>110-PP-308-41-001101</b>
	10	12.6	7.62	10.1				<b>110-PP-310-41-001101</b>
	12	15.2	7.62	10.1				<b>110-PP-312-41-001101</b>
	14	17.7	7.62	10.1				<b>110-PP-314-41-001101</b>
	16	20.3	7.62	10.1				<b>110-PP-316-41-001101</b>
	18*	22.8	7.62	10.1				<b>110-PP-318-41-001101</b>
	20*	25.3	7.62	10.1				<b>110-PP-320-41-001101</b>
	22*	27.8	7.62	10.1				<b>110-PP-322-41-001101</b>
	24*	30.4	7.62	10.1				<b>110-PP-324-41-001101</b>
	28	35.5	7.62	10.1				<b>110-PP-328-41-001101</b>
	20	25.4	10.16	12.6				<b>110-PP-420-41-001101</b>
	22	27.8	10.16	12.6				<b>110-PP-422-41-001101</b>
	24	30.4	10.16	12.6				<b>110-PP-424-41-001101</b>
	28	35.5	10.16	12.6				<b>110-PP-428-41-001101</b>
	32	40.6	10.16	12.6				<b>110-PP-432-41-001101</b>
	10	12.7	15.24	17.7				<b>110-PP-610-41-001101</b>
	24*	30.5	15.24	17.7				<b>110-PP-624-41-001101</b>
	28*	35.5	15.24	17.7				<b>110-PP-628-41-001101</b>
	32*	40.6	15.24	17.7				<b>110-PP-632-41-001101</b>
	36	45.7	15.24	17.7				<b>110-PP-636-41-001101</b>
	40*	50.8	15.24	17.7				<b>110-PP-640-41-001101</b>
	42	53.3	15.24	17.7				<b>110-PP-642-41-001101</b>
	48*	60.9	15.24	17.7				<b>110-PP-648-41-001101</b>
	50	63.5	15.24	17.7				<b>110-PP-650-41-001101</b>
	52	66.0	15.24	17.7				<b>110-PP-652-41-001101</b>

	50	63.5	22.86	25.3
	52	66.0	22.86	25.3
	64	81.2	22.86	25.3

**110-PP-950-41-001101**

**110-PP-952-41-001101**

**110-PP-964-41-001101**