

- 1
- 2
- 3
- 4
- 5
- 6
- 7
- 8
- 9
- 10
- 11
- 12
- 13
- 14
- 15
- 16
- 17
- 18

BASE AND STEM
AISI 304 stainless steel.

ELASTIC RING
AISI 301 stainless steel.

STANDARD EXECUTIONS

- **GN 6311.6-OS**: base without no-slip disk.
- **GN 6311.6-KR**: base with thermoplastic elastomer (TPE) no-slip coating, black colour.
- **GN 6311.6-KS**: base with acetal based (POM) technopolymer bearing protection, RAL 9001 natural white colour.

FEATURES AND APPLICATIONS

Stainless steel levelling feet GN 6311.6 are used for installing and levelling devices and equipment.
The values listed in the table refer to an axial load in relation to the levelling foot.
Under normal operating conditions, any lateral or angular stresses that may result in a reduction of load capacity must be taken into consideration.



GN 6311.6-OS

**GN 6311.6-KR
GN 6311.6-KS**

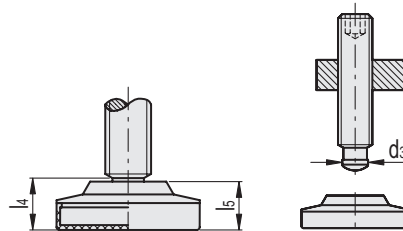
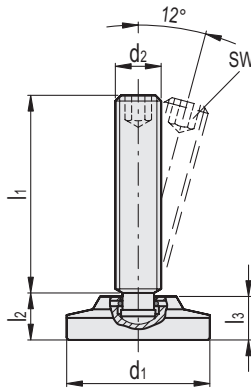

GN 6311.6-OS

INOX STAINLESS STEEL

Code	Description	d1	d2	d3	l1	l2	l3	sw	Static load [KN]	⚖️
GN.16033	GN 6311.6-50-M10-37-OS	50	M10	8	37	12.5	11.5	5	14	160
GN.16036	GN 6311.6-50-M10-47-OS	50	M10	8	47	12.5	11.5	5	14	165
GN.16039	GN 6311.6-50-M10-57-OS	50	M10	8	57	12.5	11.5	5	14	165
GN.16042	GN 6311.6-50-M10-72-OS	50	M10	8	72	12.5	11.5	5	14	179
GN.16047	GN 6311.6-50-M12-41-OS	50	M12	8	41	12.5	11.5	6	14	160
GN.16050	GN 6311.6-50-M12-51-OS	50	M12	8	51	12.5	11.5	6	14	180
GN.16053	GN 6311.6-50-M12-61-OS	50	M12	8	61	12.5	11.5	6	14	180
GN.16056	GN 6311.6-50-M12-71-OS	50	M12	8	71	12.5	11.5	6	14	185
GN.16059	GN 6311.6-50-M12-91-OS	50	M12	8	91	12.5	11.5	6	14	201
GN.16062	GN 6311.6-50-M16-59-OS	50	M16	12	59	14.5	13.5	8	33	227
GN.16065	GN 6311.6-50-M16-69-OS	50	M16	12	69	14.5	13.5	8	33	236
GN.16068	GN 6311.6-50-M16-89-OS	50	M16	12	89	14.5	13.5	8	33	260
GN.16071	GN 6311.6-50-M16-114-OS	50	M16	12	114	14.5	13.5	8	33	295
GN.16074	GN 6311.6-60-M16-59-OS	60	M16	12	59	14.5	13.5	8	33	313
GN.16077	GN 6311.6-60-M16-69-OS	60	M16	12	69	14.5	13.5	8	33	322
GN.16080	GN 6311.6-60-M16-89-OS	60	M16	12	89	14.5	13.5	8	33	346
GN.16083	GN 6311.6-60-M16-114-OS	60	M16	12	114	14.5	13.5	8	33	381
GN.16087	GN 6311.6-60-M20-78-OS	60	M20	15.5	78	16.5	15.5	10	55	409
GN.16090	GN 6311.6-60-M20-88-OS	60	M20	15.5	88	16.5	15.5	10	55	427
GN.16093	GN 6311.6-60-M20-113-OS	60	M20	15.5	113	16.5	15.5	10	55	472
GN.16096	GN 6311.6-60-M20-138-OS	60	M20	15.5	138	16.5	15.5	10	55	523

GN 6311.6-KR

INOX STAINLESS STEEL

Code	Description	d1	d2	d3	l1	l4	l5	sw	Static load [kN]	⚖️
GN.16031	GN 6311.6-50-M10-37-KR	50	M10	8	37	14	13	5	14	120
GN.16034	GN 6311.6-50-M10-47-KR	50	M10	8	47	14	13	5	14	163
GN.16037	GN 6311.6-50-M10-57-KR	50	M10	8	57	14	13	5	14	148
GN.16040	GN 6311.6-50-M10-72-KR	50	M10	8	72	14	13	5	14	163
GN.16045	GN 6311.6-50-M12-41-KR	50	M12	8	41	14	13	5	14	140
GN.16048	GN 6311.6-50-M12-51-KR	50	M12	8	51	14	13	5	14	160
GN.16051	GN 6311.6-50-M12-61-KR	50	M12	8	61	14	13	5	14	160
GN.16054	GN 6311.6-50-M12-71-KR	50	M12	8	71	14	13	5	14	168
GN.16057	GN 6311.6-50-M12-91-KR	50	M12	8	91	14	13	5	14	184
GN.16060	GN 6311.6-50-M16-59-KR	50	M16	12	59	16	15	8	33	207
GN.16063	GN 6311.6-50-M16-69-KR	50	M16	12	69	16	15	8	33	216
GN.16066	GN 6311.6-50-M16-89-KR	50	M16	12	89	16	15	8	33	240
GN.16069	GN 6311.6-50-M16-114-KR	50	M16	12	114	16	15	8	33	275
GN.16072	GN 6311.6-60-M16-59-KR	60	M16	12	59	16	15	8	33	284
GN.16075	GN 6311.6-60-M16-69-KR	60	M16	12	69	16	15	8	33	293
GN.16078	GN 6311.6-60-M16-89-KR	60	M16	12	89	16	15	8	33	317
GN.16081	GN 6311.6-60-M16-114-KR	60	M16	12	114	16	15	8	33	352
GN.16085	GN 6311.6-60-M20-78-KR	60	M20	15.5	78	18	17	10	55	379
GN.16088	GN 6311.6-60-M20-88-KR	60	M20	15.5	88	18	17	10	55	397
GN.16091	GN 6311.6-60-M20-113-KR	60	M20	15.5	113	18	17	10	55	442
GN.16094	GN 6311.6-60-M20-138-KR	60	M20	15.5	138	18	17	10	55	493

GN 6311.6-KS

INOX STAINLESS STEEL

Code	Description	d1	d2	d3	l1	l4	l5	sw	Static load [kN]	⚖️
GN.16032	GN 6311.6-50-M10-37-KS	50	M10	8	37	14	13	5	14	100
GN.16035	GN 6311.6-50-M10-47-KS	50	M10	8	47	14	13	5	14	163
GN.16038	GN 6311.6-50-M10-57-KS	50	M10	8	57	14	13	5	14	160
GN.16041	GN 6311.6-50-M10-72-KS	50	M10	8	72	14	13	5	14	174
GN.16046	GN 6311.6-50-M12-41-KS	50	M12	8	41	14	13	6	14	133
GN.16049	GN 6311.6-50-M12-51-KS	50	M12	8	51	14	13	6	14	162
GN.16052	GN 6311.6-50-M12-61-KS	50	M12	8	61	14	13	6	14	168
GN.16055	GN 6311.6-50-M12-71-KS	50	M12	8	71	14	13	6	14	180
GN.16058	GN 6311.6-50-M12-91-KS	50	M12	8	91	14	13	6	14	196
GN.16061	GN 6311.6-50-M16-59-KS	50	M16	12	59	16	15	8	33	217
GN.16064	GN 6311.6-50-M16-69-KS	50	M16	12	69	16	15	8	33	226
GN.16067	GN 6311.6-50-M16-89-KS	50	M16	12	89	16	15	8	33	250
GN.16070	GN 6311.6-50-M16-114-KS	50	M16	12	114	16	15	8	33	285
GN.16073	GN 6311.6-60-M16-59-KS	60	M16	12	59	16	15	8	33	304
GN.16076	GN 6311.6-60-M16-69-KS	60	M16	12	69	16	15	8	33	313
GN.16079	GN 6311.6-60-M16-89-KS	60	M16	12	89	16	15	8	33	337
GN.16082	GN 6311.6-60-M16-114-KS	60	M16	12	114	16	15	8	33	372
GN.16086	GN 6311.6-60-M20-78-KS	60	M20	15.5	78	18	17	10	55	400
GN.16089	GN 6311.6-60-M20-88-KS	60	M20	15.5	88	18	17	10	55	418
GN.16092	GN 6311.6-60-M20-113-KS	60	M20	15.5	113	18	17	10	55	463
GN.16095	GN 6311.6-60-M20-138-KS	60	M20	15.5	138	18	17	10	55	514