



BUILT-IN FUSE BASE WITH SIGNAL DETECTOR FOR CYLINDRICAL FUSES SIZE 14X51 MM 50 A, 1-POLE+N

Figure similar

**Model**

product brand name	SENTRON
--------------------	---------

**General technical data**

Number of poles	1
-----------------	---

**Mechanical Design**

Height	mm	90
Width	mm	54
Depth	mm	70

**Certificates**

<b>Equipment marking</b>		
<ul style="list-style-type: none"> <li>• acc. to DIN EN 61346-2</li> <li>• acc. to DIN EN 81346-2</li> </ul>	F	F

**General Product Approval** **Declaration of Conformity**



**Further information**

**Information- and Downloadcenter (Catalogs, Brochures,...)**  
<http://www.siemens.com/lowvoltage/catalogs>

**Industry Mall (Online ordering system)**  
<https://eb.automation.siemens.com/mall/en/WW/Catalog/Product/3NW7152>

**Service&Support (Manuals, Certificates, Characteristics, FAQs,...)**  
<http://support.automation.siemens.com/WW/view/en/3NW7152/all>

Image database (product images, 2D dimension drawings, 3D models, device circuit diagrams, ...)  
[http://www.automation.siemens.com/bilddb/cax\\_en.aspx?mlfb=3NW7152](http://www.automation.siemens.com/bilddb/cax_en.aspx?mlfb=3NW7152)

CAX-Online-Generator  
<http://www.siemens.com/cax>

Tender specifications  
<http://ausschreibungstexte.siemens.com/tiplv>

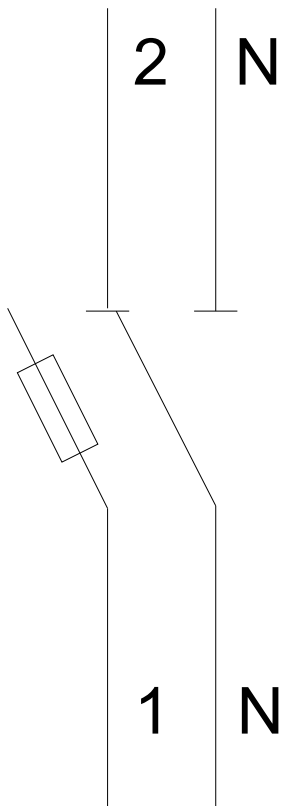
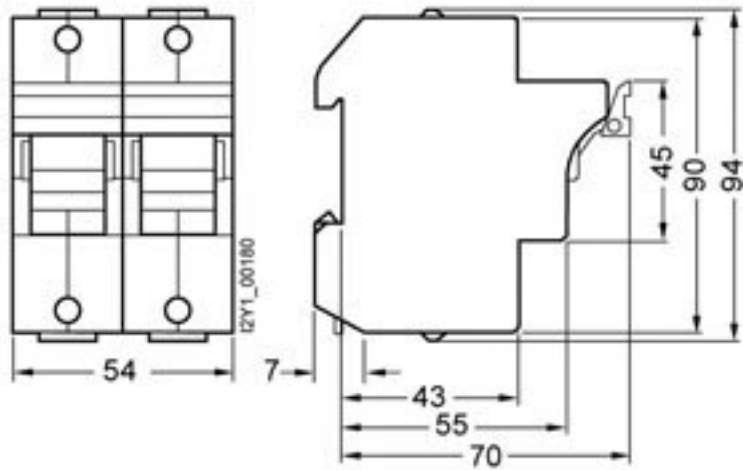

last modified:

11.03.2015