

Ferrite core

$\varnothing \leq 8 \text{ mm}$

FEATURES:

SPECIFICATION:

For cable size	$\varnothing \leq 8 \text{ mm}$
A	14.2 mm
C	8 mm
D	28.5 mm
Impedance @ 25 MHz	98 Ω
Impedance @ 100 MHz	128 Ω

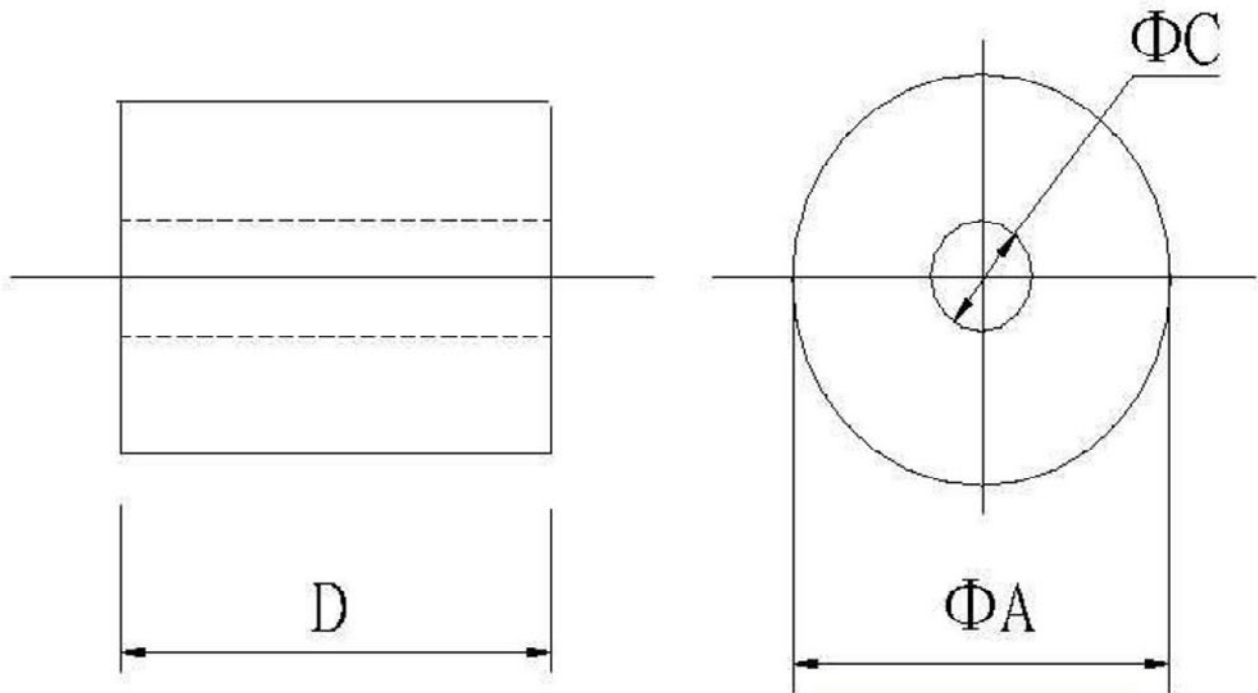

Ferrite core

$\varnothing \leq 8 \text{ mm}$



Frequency Graph

1. TEST INSTRUMENT: HP4286A
2. WINDING: 0.8 Φ X100 mm 2 U.E.W 1TS

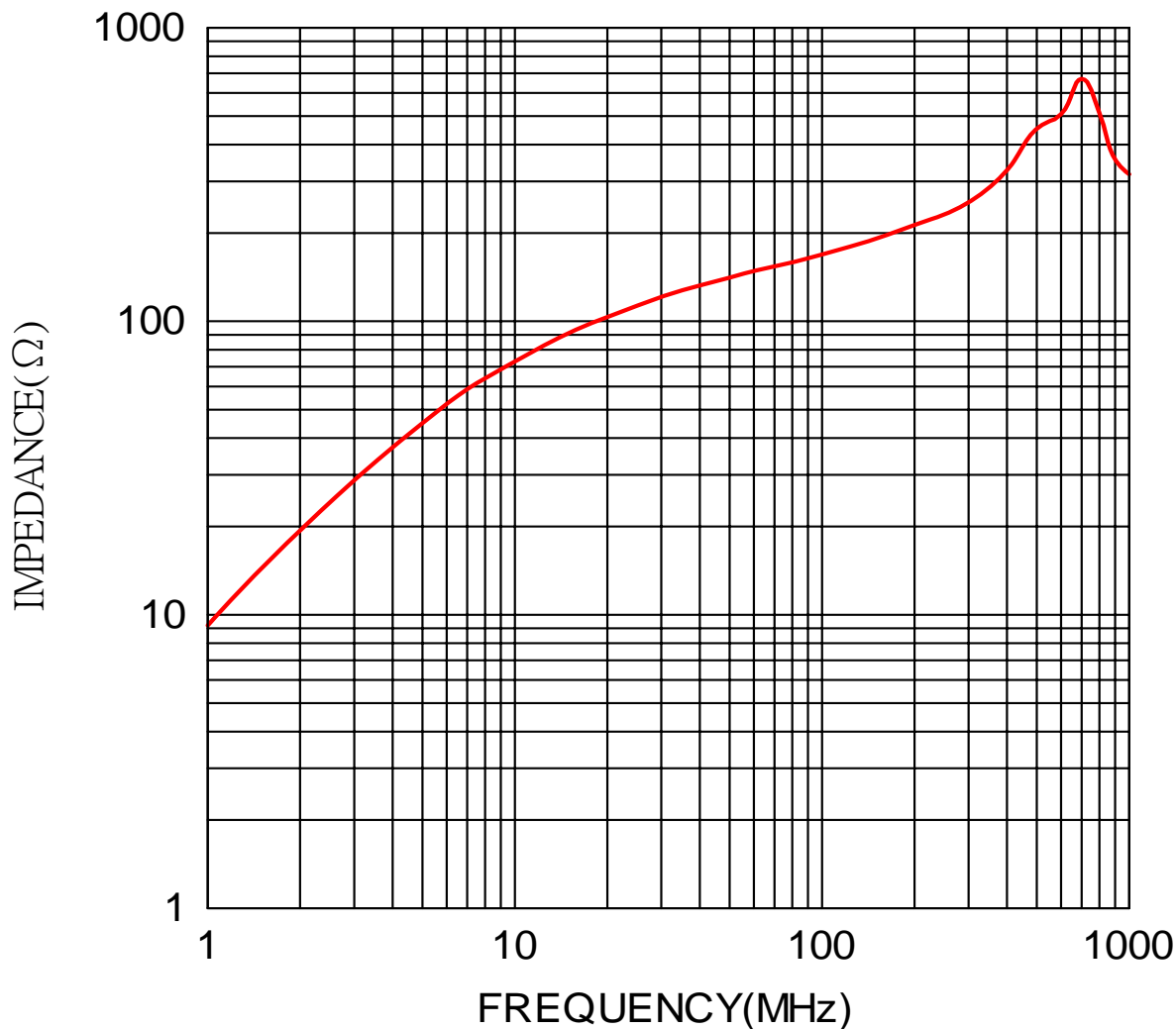

	1	5	10	25	50	100	200	300	400	500	600	700	800	900	1000
Z —	9.2	45	73	113	141	169	213	255	328	453	508	670	512	356	317

(DATA BETWEEN 500MHz AND 1000MHz ARE FOR REFERENCE ONLY)

Art. Nr.
RND 165-00020