

Container strip

Execution:

- Smooth or slotted shelves: The adjustable shelves are equipped with a stop bar on a long side. The adjustable shelves can be mounted with the stop bar either at the front or rear. Slotted for adjustable shelves: Slot spacing 15 mm for partitioning with dividers. With 2 brackets, the adjustable shelves can be mounted on the support pillars without screws, horizontally or 15 degrees inclined. Carrying capacity 50 kg. Shelf height 25 mm + 17 mm stop bar. Each includes 2 brackets. Design: Sheet steel. Colour: according to colour chart.

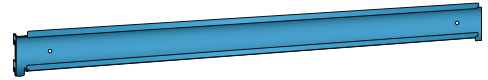

Art. no.	50305 107
Brand	LISTA
Manufacturer Part Number	65.235.010
Colour	Light blue RAL 5012
Module width	1330 mm
Effective width	1325 mm
Gross Weight	2.800 kg
Product Group	5AN