

**Specifications:**

Current rating:	0.5A/pin max.
Voltage rating:	30V (DC)
Dielectric withstanding voltage:	100VAC 1 minute Contact
resistance:	50mΩ max.
Insulation resistance:	100MΩ min.
Temperature range:	-20°C to +70°C

**Materials:**

Housing:	High temperature plastic
Shell:	Copper alloy
Contact:	Copper alloy

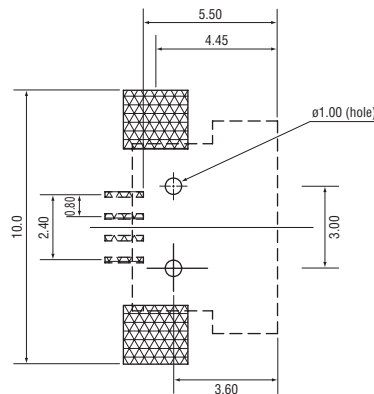
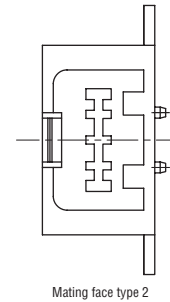
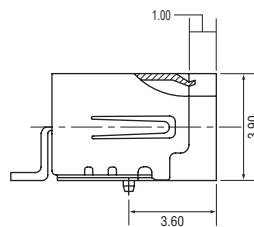
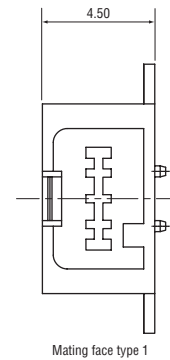
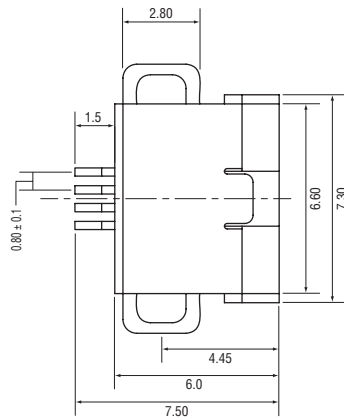
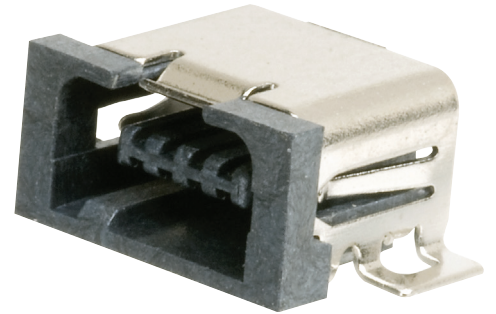

Recommend PCB Layout (tolerance = ±0.05)