

**RoHS  
Compliant**



## Features:

- For Surface Mounted Applications
- Low Profile Package
- Built-In Strain Relief
- Metal Silicon Junction, Majority Carrier Conduction
- High Surge Capability
- Low Power Loss, High Efficiency
- For Use In Low Voltage High Frequency Inverters, Free Wheeling And Polarity Protection Applications
- Guard Ring for over voltage protection
- High Temperature Soldering Guaranteed : 250°C/10 Seconds At Terminals

## Mechanical Data

- Case: JEDEC DO-214AC, molded plastic over passivated chip
- Terminals : Solder plated, solderable per MIL-STD-750, Method 2026
- Polarity : Colour band denotes cathode end
- Weight : 0.002oz, 0.064g

## Maximum Ratings and Thermal Characteristics

Ratings at 25°C ambient temperature unless otherwise specified

Characteristic	Symbol	B120-13-F	B130-13-F	B140-13-F	Units
Maximum repetitive peak reverse voltage	$V_{RRM}$	20	30	40	V
Maximum RMS voltage	$V_{RWS}$	14	21	28	V
Maximum DC blocking voltage	$V_{DC}$	20	30	40	V
Maximum average forward rectified current at $T_L = \text{See Fig. 1.}$	$I_{F(AV)}$	1			A
Peak forward surge current 8.3ms single half-sine-wave	$I_{FSM}$	30			A
Maximum instantaneous forward voltage at $I_{FM} = 1A$ (Note 1)	$V_F$	0.5			V
Maximum DC reverse current (Note 1) $T_A = 25^\circ C$ at rated DC blocking voltage $T_A = 100^\circ C$	$I_R$	0.5 10			mA
Typical thermal resistance (Note 2)	$R_{\theta JA}$ $R_{\theta JL}$	88 20			$^\circ C/W$
Operating junction and storage temperature range	$T_J, T_{STG}$	-55 to +125			$^\circ C$

### Notes:

- (1) Pulse test: 300µs pulse width, 1% duty cycle.
- (2) PCB mounted with 0.2" x 0.2" (5 x 5mm<sup>2</sup>) copper pad areas.

**FIG.1 – FORWARD DERATING CURVE**

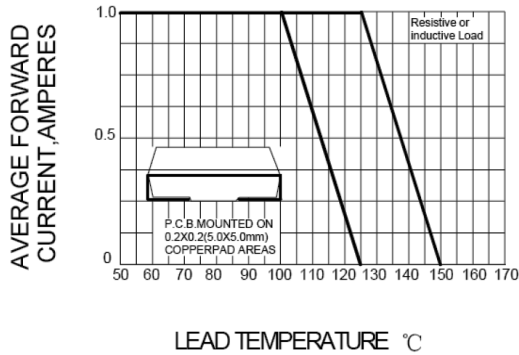

**FIG.2– PEAK FORWARD SURGE CURRENT**

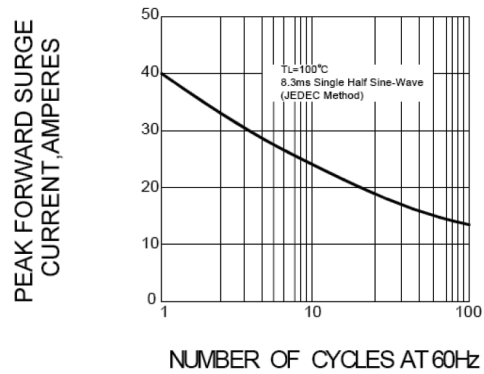

**FIG.3 – TYPICAL FORWARD CHARACTERISTICS**

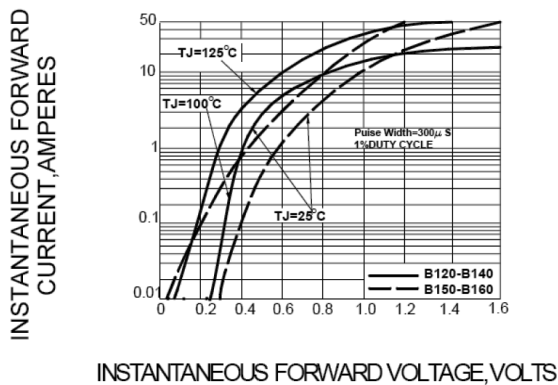

**FIG.4 -- TYPICAL REVERSE CHARACTERISTICS**

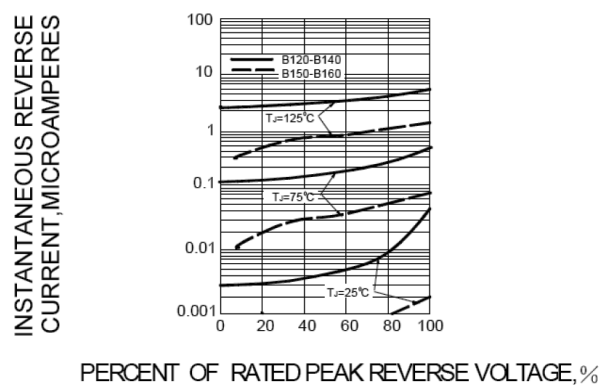

**FIG.5–TYPICAL JUNCTION CAPACITANCE**

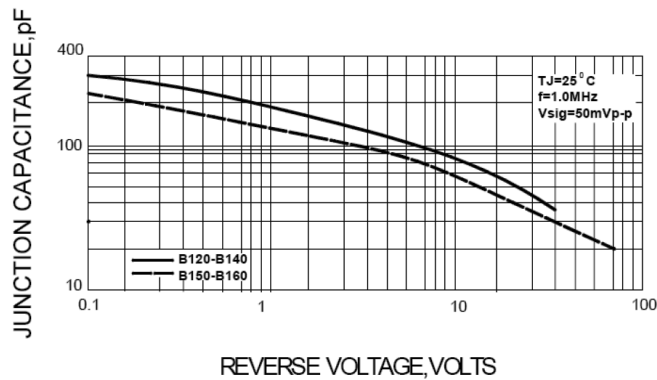

## Package Outline Dimensions

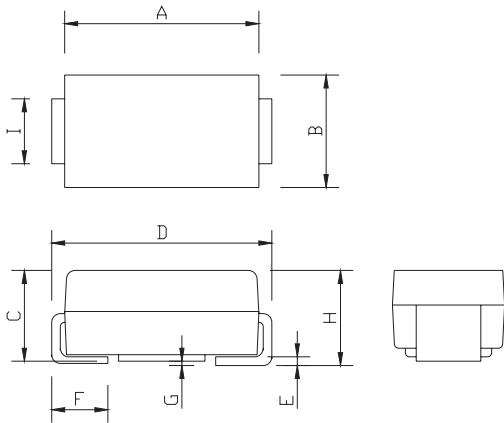

DO-214AC(SMA)		
Dim.	Min.	Max.
A	4.25	4.65
B	2.4	2.8
C	1.85	2.15
D	4.85	5.35
E	0.2 Typ.	
F	0.9	1.5
G	0.2 Max.	
H	1.9	2.3
I	1.35	1.65

Dimensions : Millimetres

## Soldering Footprint

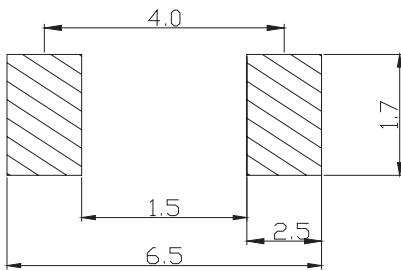

Dimensions : Millimetres

## Package Information

Device	Package	Shipping
B120 -13-F B130 -13-F B140 -13-F	DO-214AC(SMA)	5,000 / Tape & Reel

## Part Number Table

Description	Part Number
Schottky Barrier Rectifier	B120-13-F
	B130-13-F
	B140-13-F

**Important Notice :** This data sheet and its contents (the "Information") belong to the members of the AVNET group of companies (the "Group") or are licensed to it. No licence is granted for the use of it other than for information purposes in connection with the products to which it relates. No licence of any intellectual property rights is granted. The Information is subject to change without notice and replaces all data sheets previously supplied. The Information supplied is believed to be accurate but the Group assumes no responsibility for its accuracy or completeness, any error in or omission from it or for any use made of it. Users of this data sheet should check for themselves the Information and the suitability of the products for their purpose and not make any assumptions based on information included or omitted. Liability for loss or damage resulting from any reliance on the Information or use of it (including liability resulting from negligence or where the Group was aware of the possibility of such loss or damage arising) is excluded. This will not operate to limit or restrict the Group's liability for death or personal injury resulting from its negligence. Multicomp Pro is the registered trademark of Premier Farnell Limited 2019.