

The supplier acknowledges that, with the acceptance of the drawing, he is in a position to manufacture the illustrated part in accordance with the drawing in reproducible form and series production. Through the selected manufacturing processes no impairments will arise in the material and structure which could subsequently lead to an impairment of the component. Verbal agreements over and above that are not valid. Deviations from this rule must be signed by the purchaser.

This drawing may not be copied, reproduced or made available to third parties in any way without the written approval of the manufacturer.

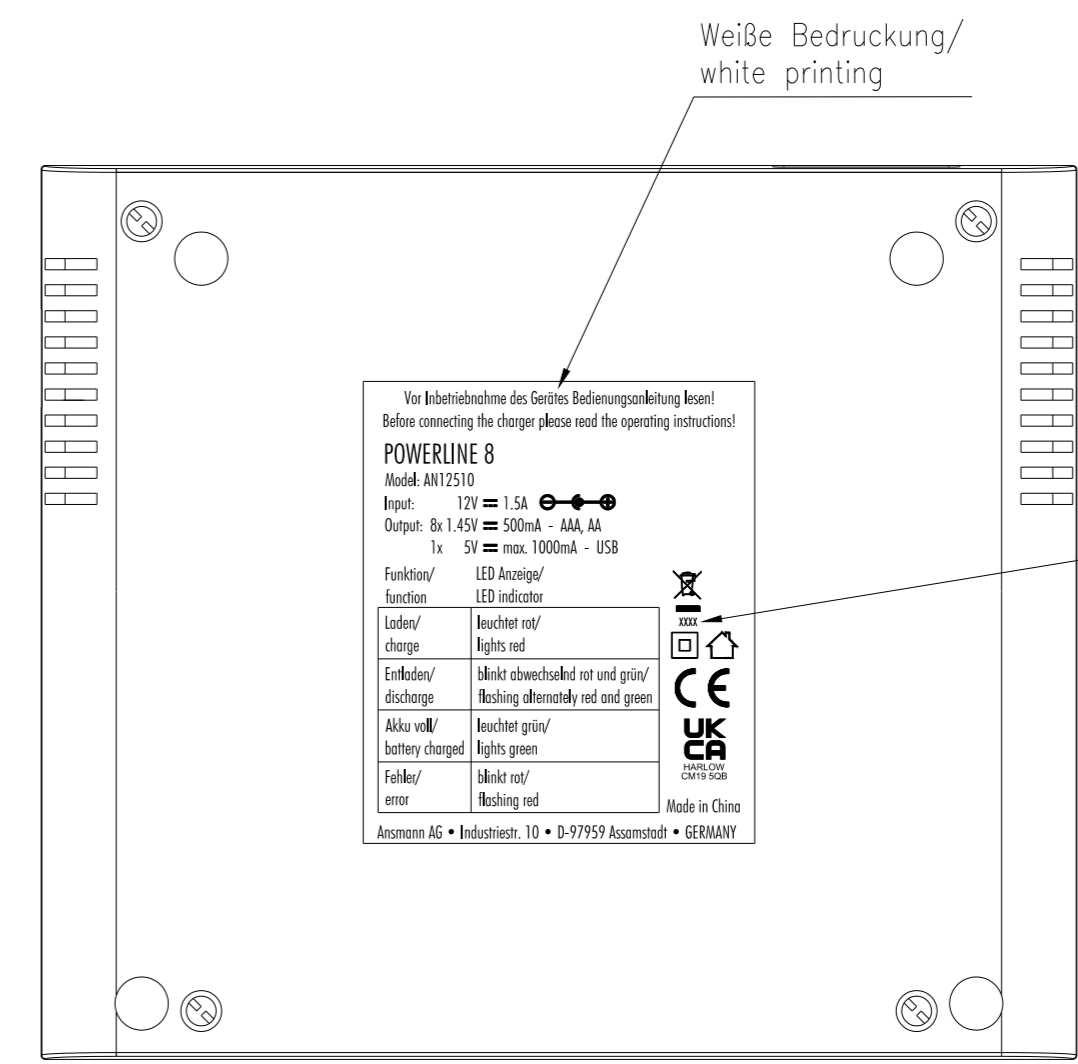
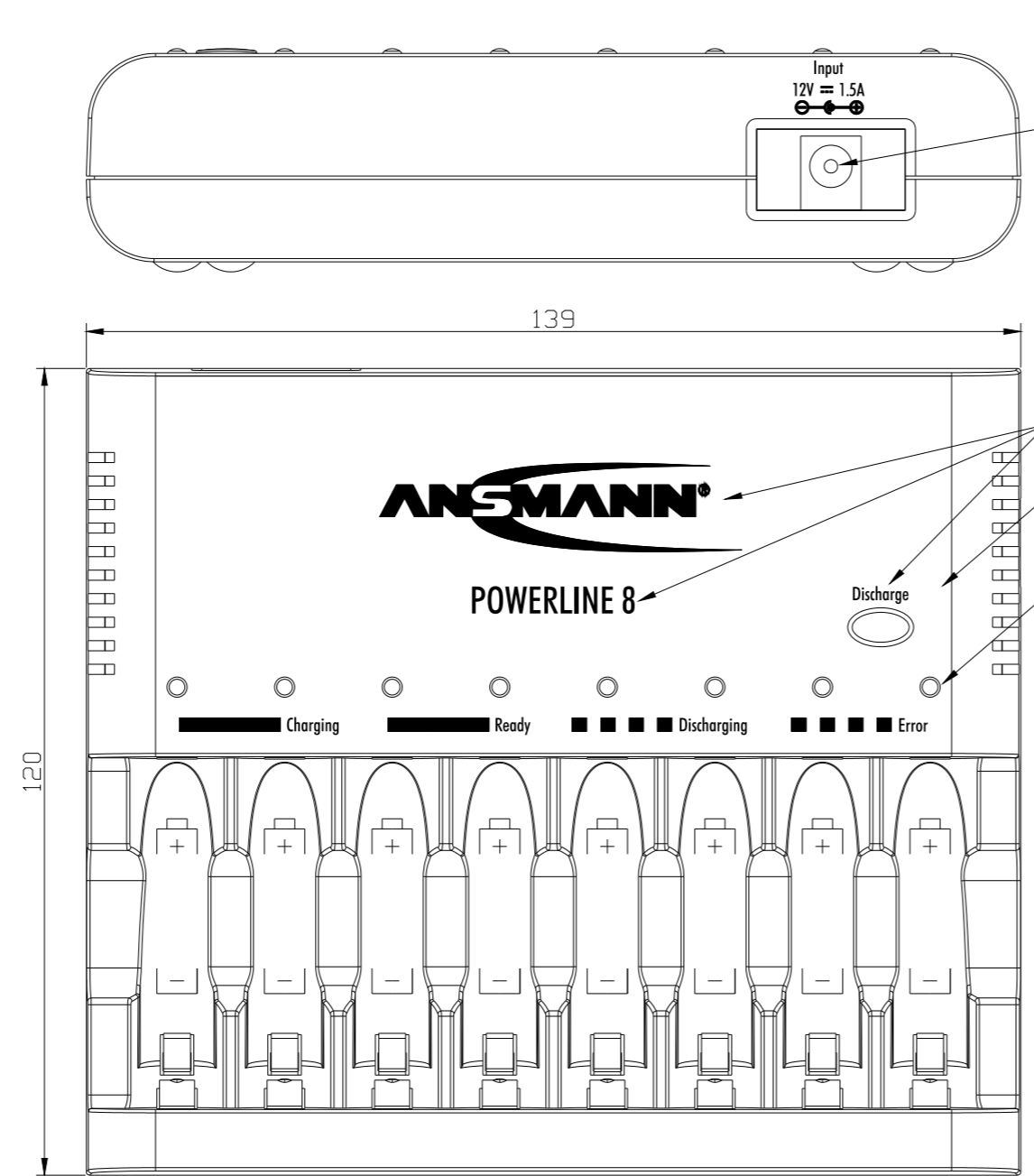
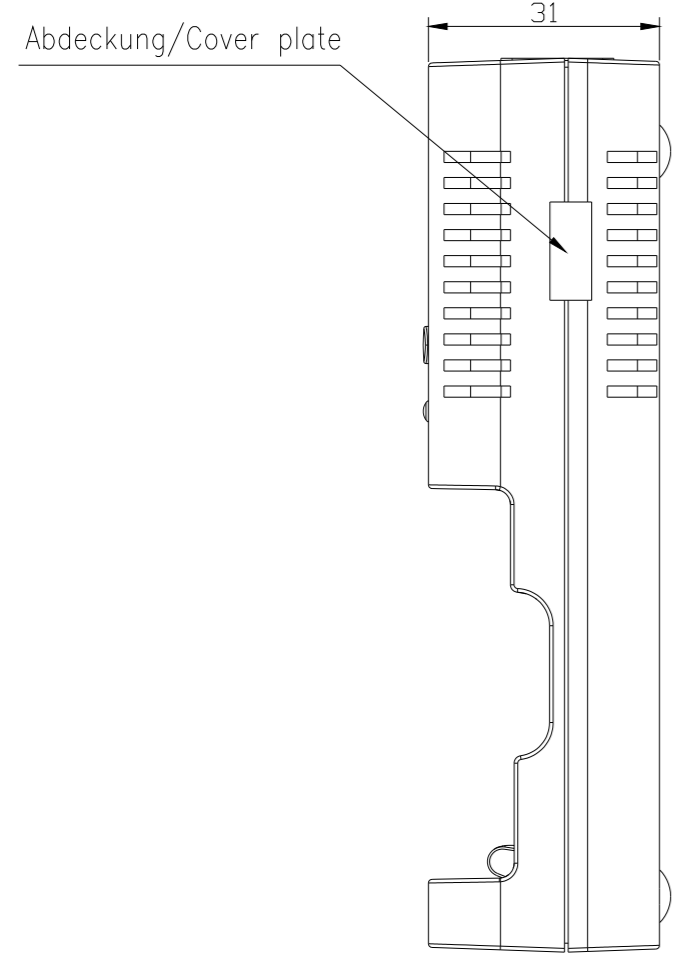

Vor Inbetriebnahme des Gerätes Bedienungsanleitung lesen!  
Before connecting the charger please read the operating instructions!

**POWERLINE 8**  
Modell: AN12510  
Input: 12V = 1.5A  
Output: 8x 1.45V = 500mA - AAA, AA  
1x 5V = max. 1000mA - USB

Funktion/ function	LED Anzeige/ LED indicator
Laden/ charge	leuchtet rot/ lights red
Entladen/ discharge	blinkt abwechselnd rot und grün/ flashing alternately red and green
Akku voll/ battery charged	leuchtet grün/ lights green
Fehler/ error	blinkt rot/ flashing red

Ansmann AG • Industriest. 10 • D-97959 Assmannshausen • GERMANY

Technische Daten Ladegerät/ technical data charger		Technische Daten Netzteil/ technical data power supply	
Eingangsdaten/ input data	: 12V DC 1.5A	Eingangsdaten/ input data	: 100 - 240V AC ±10% 50/60Hz 350mA
Ausgangsdaten/ output data	: 8 x 1.45V = Rundzellen AA oder AAA/ cylindrical batteries AA or AAA	Ausgangsdaten/ output data	: 12V DC 1.5A
Ladestrom/ charging current	: 8x 500mA ±20%	Gehäuse/ housing	: schwarzes Steckergehäuse mit weißer Bedruckung/ black plug-in housing with white printing
Entladestrom/ discharging current	: 8x 200mA ±20%	Gehäusematerial/ housing material	: UL94V-0
Vollerkennung/ battery full detection	: -dU	LED Anzeige/ LED indication	
Erhaltungsladung/ trickle charge	: 25mA ±20%	Laden/ charging	: rote LED leuchtet dauerhaft/ red LED lights steady
Entladeschlussspannung/ discharge end voltage	: 1V ±5%	Erhaltungsladung/ trickle charge	: grüne LED leuchtet dauerhaft/ green LED lights steady
max. Spannung/ max. Voltage	: für Rundzellen/ for cylindric cells 1.75V +10%	Entladen/ discharging	: LED blinkt abwechselnd rot und grün/ LED flashing alternately red and green
Sicherheitstimer/ safety timer	: 8h ±15% für Rundzellen/ for roundcells	Fehler/ error	: LED blinkt rot/ LED flashing red
Ausgangsschutz/ output protection	: mechanischer Verpolschutz/ mechanical reverse-connection protection		
Schutzart/ protection	: IP20		
Betriebstemperatur/ operating temperature	: 0°C.....+25°C		
Lagertemperatur/ storage temperature	: -25°C.....+70°C		
Approbation/ approval	: CE		
Gehäuse/ housing	: Tischladegerät/ desktop charger		
Gehäusematerial/ housing material	: ABS		
Gewicht/ weight	: 480g		
Verpackung/ packaging	: weiße Faltschachtel inkl. mehrsprachiger Bedienungsanleitung/ white folding box incl. multilingual operating instruction		

LED Anzeige/ LED indication	
Laden/ charging	: rote LED leuchtet dauerhaft/ red LED lights steady
Erhaltungsladung/ trickle charge	: grüne LED leuchtet dauerhaft/ green LED lights steady
Entladen/ discharging	: LED blinkt abwechselnd rot und grün/ LED flashing alternately red and green
Fehler/ error	: LED blinkt rot/ LED flashing red

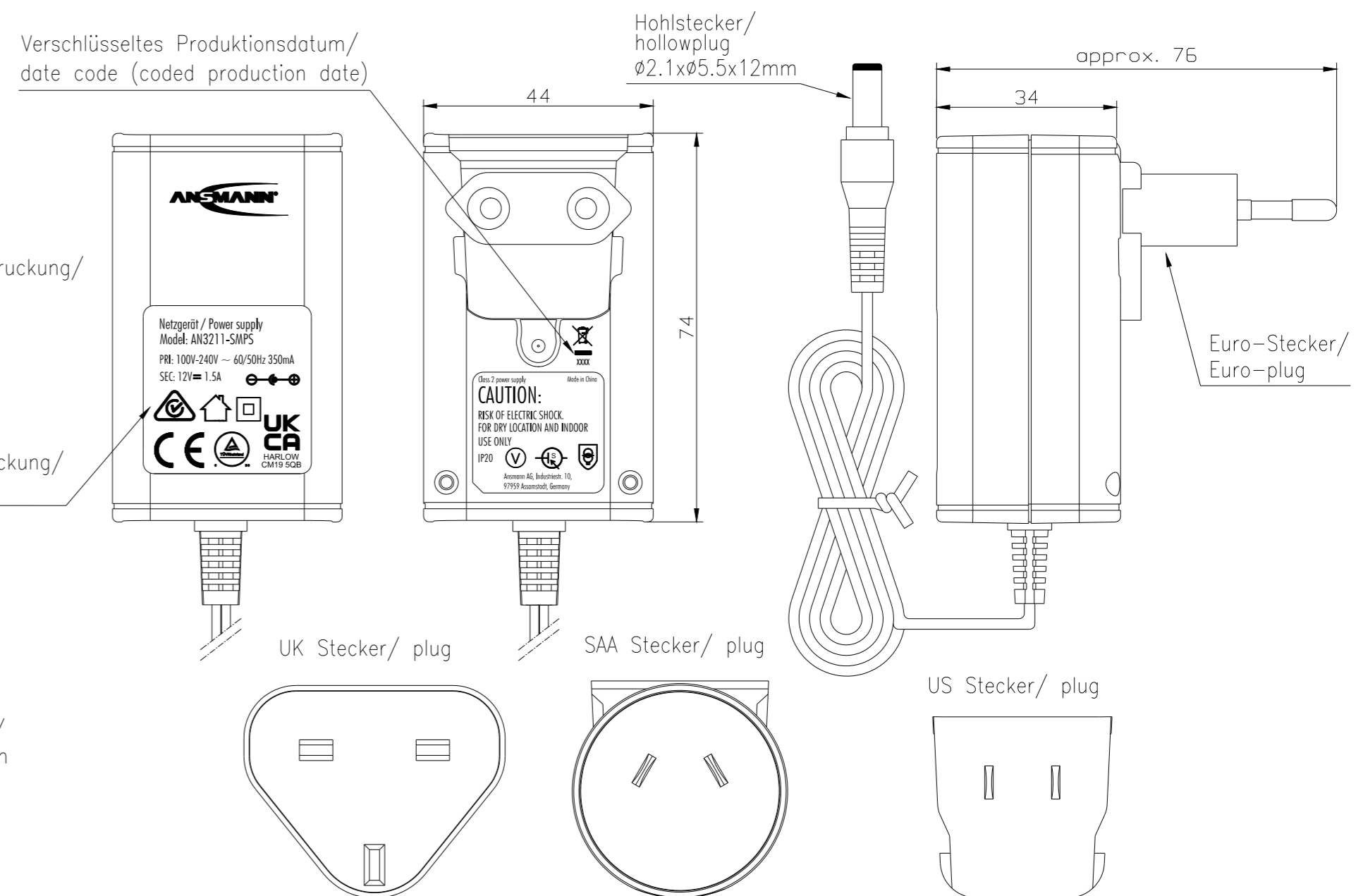
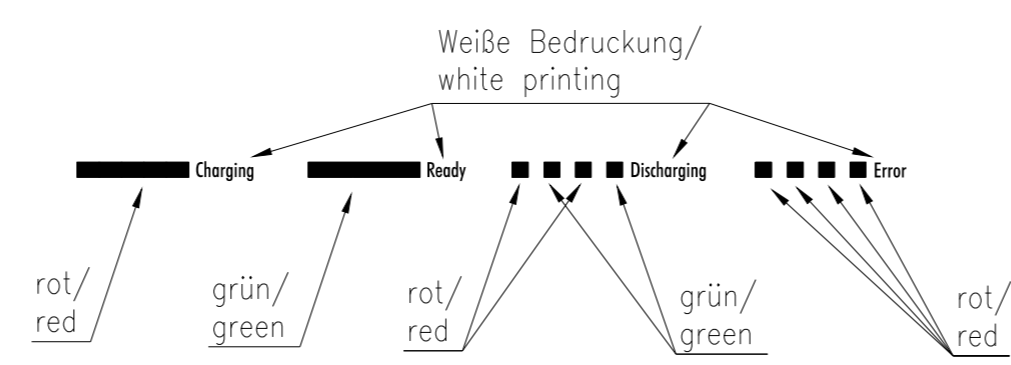

Allowable deviation general tolerances		Surface:		Material:		Weight	
DIN ISO 2768-m				Scale (DIN A2): 1:1		Projection method 1	
Date 10.01.2014		Name SK		Product name: NiBC-Powerline8-W-EU-np/RS			
Changed by				Part number 1001-0006-520		Project: IS-00499	
Version Change		Date Name		Application range for inquiry XXX/XX		Sheet 1/1	
V2	UKCA updated, USB Port removed	30.06.2022	DS	<b>ANSMANN</b>			
V1	label updated	07.05.2019	DS				
V0	---	12.02.2016	SK				