

IN5460

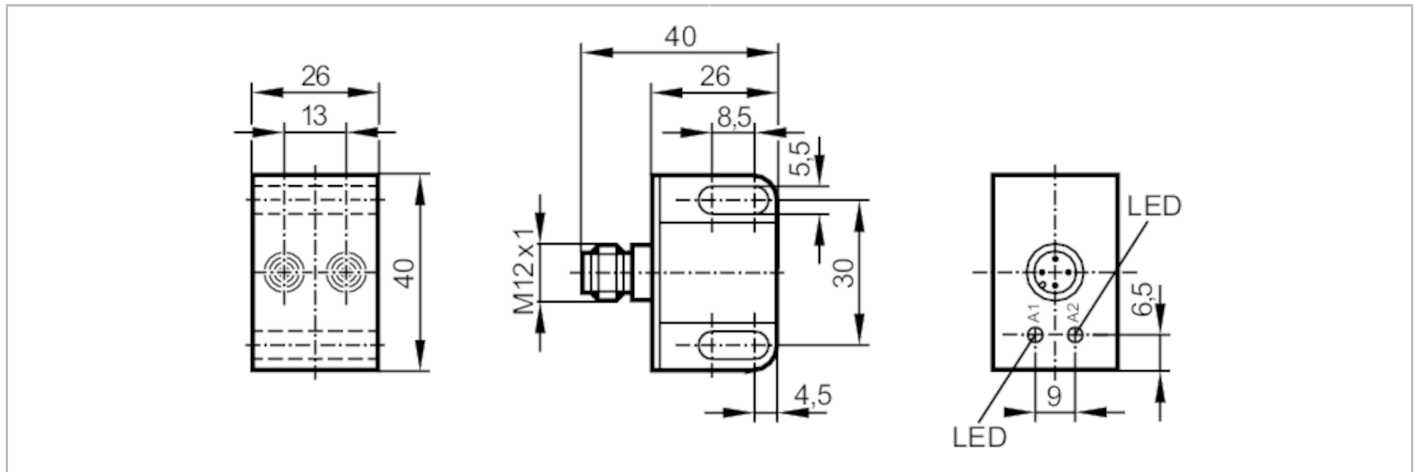

Inductive dual sensor for valve actuators

IND3007DBPKG/US-100-DPV



Product characteristics

Electrical design		PNP
Output function		2 x normally open
Sensing range	[mm]	7
Housing		rectangular
Dimensions	[mm]	40 x 26 x 26

Electrical data

Operating voltage	[V]	10...36 DC
Current consumption	[mA]	< 15
Protection class		II
Reverse polarity protection		yes

Outputs

Electrical design		PNP
Output function		2 x normally open
Max. voltage drop switching output DC	[V]	2.5
Permanent current rating of switching output DC	[mA]	250
Switching frequency DC	[Hz]	600
Short-circuit protection		yes
Type of short-circuit protection		pulsed
Overload protection		yes

Detection zone

Sensing range	[mm]	7
Real sensing range Sr	[mm]	7 ± 10 %
Operating distance	[mm]	0...5.7

IN5460



Inductive dual sensor for valve actuators

IND3007DBPKG/US-100-DPV

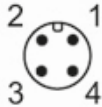
Accuracy / deviations		
Correction factor	steel: 1 / stainless steel: 0.7 / brass: 0.5 / aluminium: 0.4 / copper: 0.3	
Hysteresis [% of Sr]	3...15	
Switch point drift [% of Sr]	-10...10	
Operating conditions		
Ambient temperature [°C]	-40...70	
Protection	IP 67	
Tests / approvals		
EMC	EN 60947-5-2	
	EN 55011	class B
MTTF [years]	990	
Mechanical data		
Weight [g]	42.2	
Housing	rectangular	
Mounting	non-flush mountable	
Dimensions [mm]	40 x 26 x 26	
Materials	PC	
Tightening torque [Nm]	0.6...1.5; (Lock nut)	
Displays / operating elements		
Display	switching status	2 x LED, yellow
Remarks		
Pack quantity	1 pcs.	
Electrical connection - plug		
Connector: 1 x M12		
		

IN5460



Inductive dual sensor for valve actuators

IND3007DBPKG/US-100-DPV

Connection

