

EMPTY MODULES

"Series 10 000"

Features

A series 10 000 module is made of three parts:

- body of molded polyamide (holding the terminals),
- two polyamide end plates of different thickness, which, snapped onto the body, protect the electronic components and determine the overall spacing.

End plate type **PFN 1**
Thickness 3,5 mm

Grey	PFN 1.G	0113 091.00
Orange	PFN 1.O	0103 259.13
Blue (1)	PFN 1.B	0123 091.02

Spacing	Components	
	Body	End plate
18	1 x EB...	2 x PFN 1
23	1 x EB...	(1 x PFN 1) + (1 x PFN 2)
28	1 x EB...	2 x PFN 2

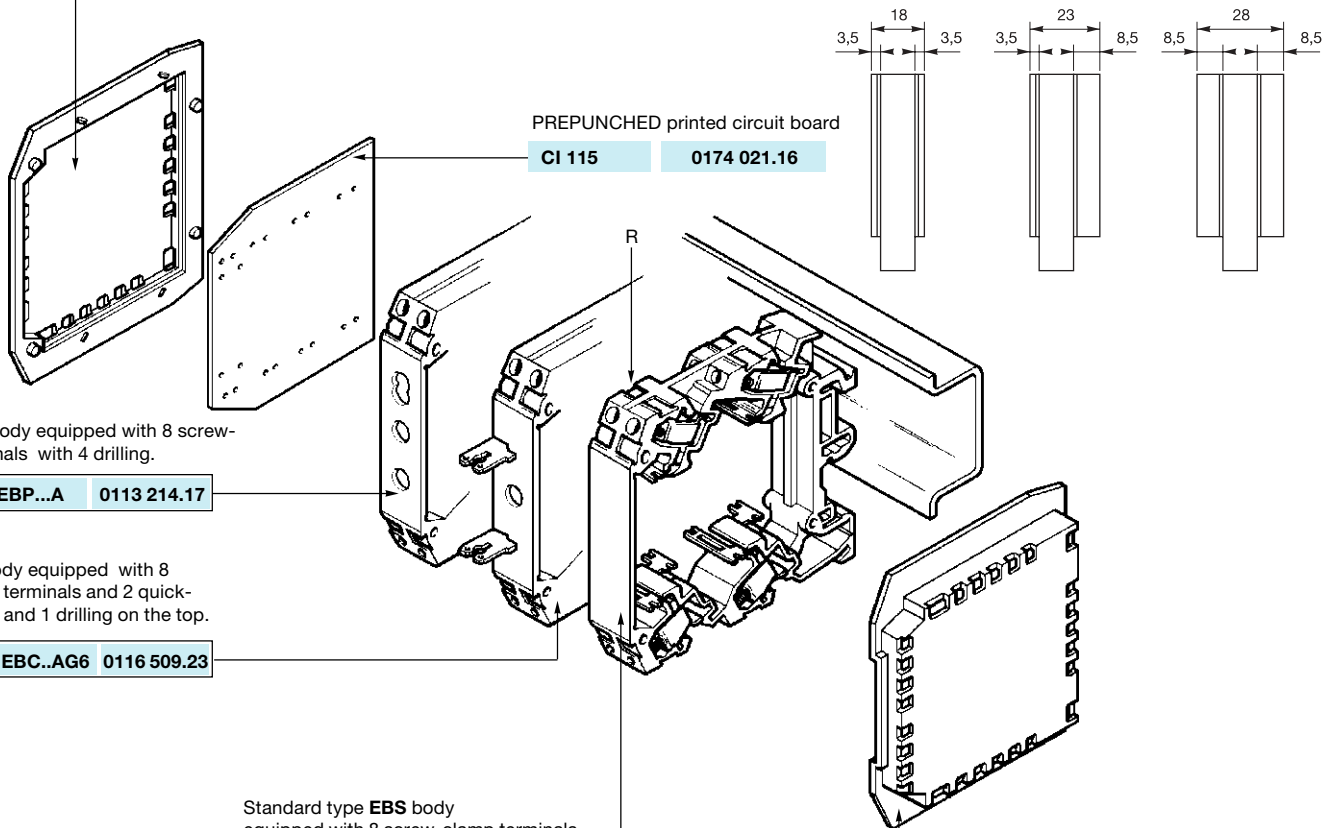

Type **EBP** body equipped with 8 screw-clamp terminals with 4 drilling.

Grey	EBP...A	0113 214.17
------	----------------	--------------------

Type **EBC** body equipped with 8 screw-clamp terminals and 2 quick-connect tabs and 1 drilling on the top.

Grey	EBC...AG6	0116 509.23
------	------------------	--------------------

Standard type **EBS** body equipped with 8 screw-clamp terminals.

Grey	EBS...A	0114 533.00
Orange	EBS...A	0103 305.02
Blue (1)	EBS...A	0124 533.02

End plate type **PFN 2**
Thickness 8,5 mm

Grey	PFN 2.G	0113 095.04
Orange	PFN 2.O	0103 260.10
Blue (1)	PFN 2.B	0123 095.06

(1) Material not kept in stock

R See section on marking.

Marking method

① ⑤ and ⑯

Type of body

Standard "EBS" body

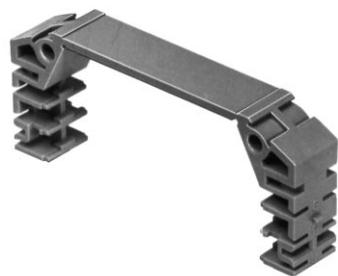

Type EBC body with 2 quick-connect tabs

1 hole for an indicator or potentiometer, etc...

2 quick-connect tabs compatible with 1 quick-connect female tab series 250 (6,3 x 0,8 mm) or 2 quick-connect female tabs series 110 (2,8 x 0,8 mm)



Type EBP body with 4 holes

for indicator or potentiometers, etc...

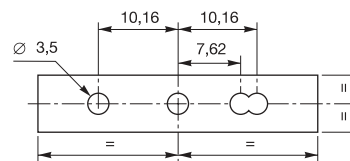
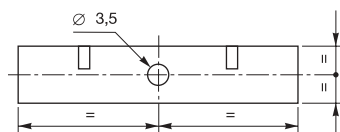

Spacing

Component holder spacing is determined by required internal volume for component packaging.

* Max. height of components

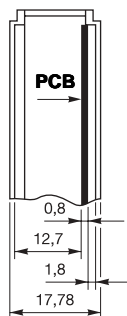

2 end plates

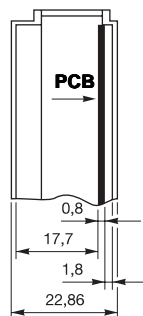

1 end plate 3,5
1 end plate 8,5

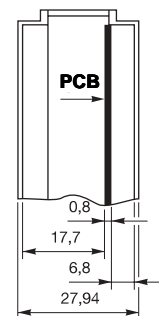
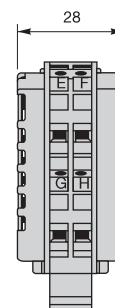

2 end plates 8,5

3,5

Position of terminals

Mold identification allows identification of terminals.

screw-clamp terminals on both sides

Right side

Left side

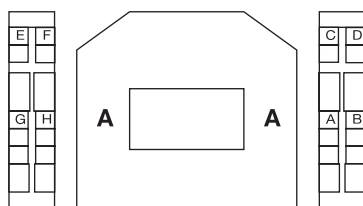

Quick-connect tab on top (code G6)

(2 tabs marked 1 and 2 on the unit). On the EBC units only.

2 tabs compatible for 1 x series 250 (6,3 x 0,8 mm) or 2 x series 110 (2,8 x 0,8mm) quick-connect female tabs.

Dimensions

Dimensions of standard modules

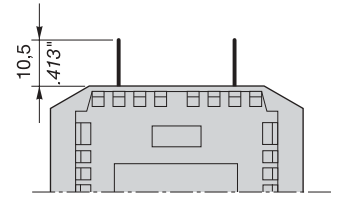
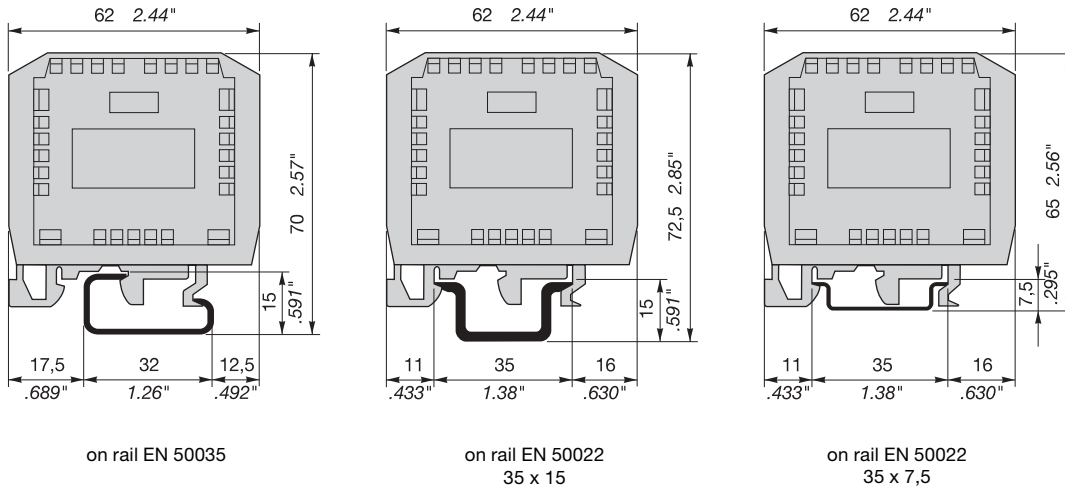

Type EBC module equipped with a quick-connect tab series 250 (6,3 x 0,8 mm) or 2 quick-connect tabs series 110 (2,8 x 0,8 mm)

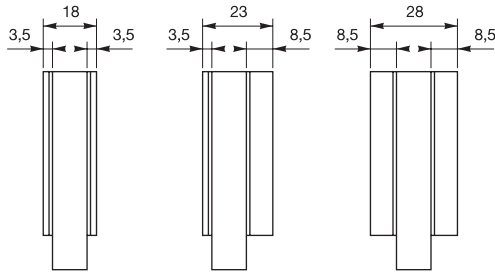

Electrical and mechanical characteristics

1. Electrical

Type of connection		Screw-clamp A	2 x quick-connect series 110 2,8 x 0,8 2 x quick-connect series 110 2,8 x 0,5
Wire size	Solid wire	0 to 4 mm ²	
	Stranded wire	0 to 2,5 mm ²	0,3 to 1,5 mm ²
	AWG	20 to 12 AWG	22 to 16 AWG
Rated voltage	DIN Gr.C	250 V ~ and 300 V =	60 V ~ and 75 V = (1) 30 V ~ and 36 V = (2)
	NFC Cat. C	250 V ~ and =	50 V ~ and 75 V =
Remarks	CSA		
		wire stripping length 7 mm recommended screwdriver 3,5 mm	(1) insulated quick-connect tabs (2) red pre-insulated quick-connect tabs

The quick-connect tabs can be used for soldering.

2. Mechanical

Body: polyamide UL 94.V2.
Working temperature: - 40°C to + 100°C.

Arc creepage index: KB 600.
Storage temperature: - 55°C to + 110°C.

How to order

Indicate the part numbers of an insulator and the 2 end plates (see page 556).

Example: for a 23 mm spacing module equipped with 8 screw-clamp connections, you must order:

- 1 grey insulator **P/N 0114 533.00**
- 1 grey end plate 3,5 **P/N 0113 091.00**
- 1 grey end plate 8,5 **P/N 0113 095.04**

Accessories

CI Printed circuit boards

2 types of PCB's are available:

- all copper plates fo small series,
- prepunched plates for small series.

Material: Epoxy resin UL94 VO

Thickness of circuit: 0,8 mm

Thickness of copper: 35 µm

Screw-clamp/screw-clamp

copper plated boards

CI 114 **0174 020.21**

prepunched boards

CI 115 **0174 021.16**

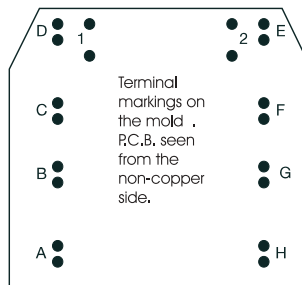
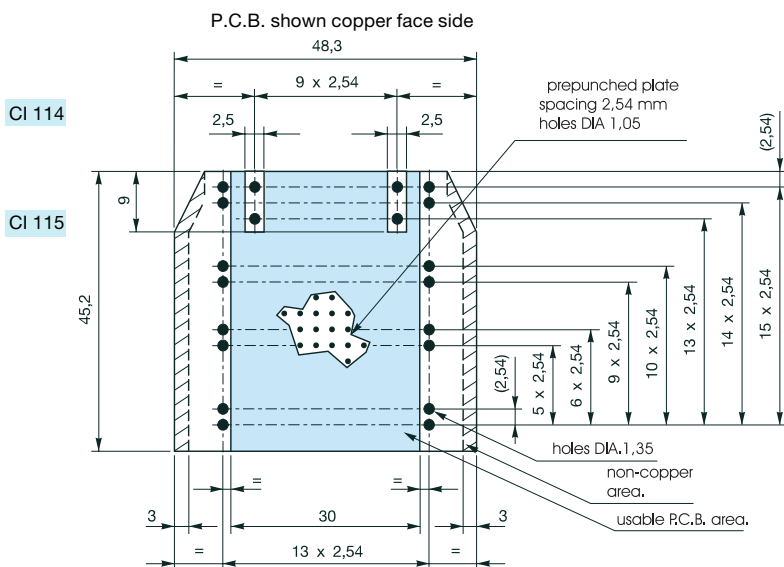

Thermal characteristics

- For maximum reliability, the mounting method must be determined according to the power dissipated in the interface module, and the ambient temperature around the modules.

- Inversely, knowing the type of mounting, A or B, and the power dissipated, the curve (left) determines the maximum recommended ambient temperature.

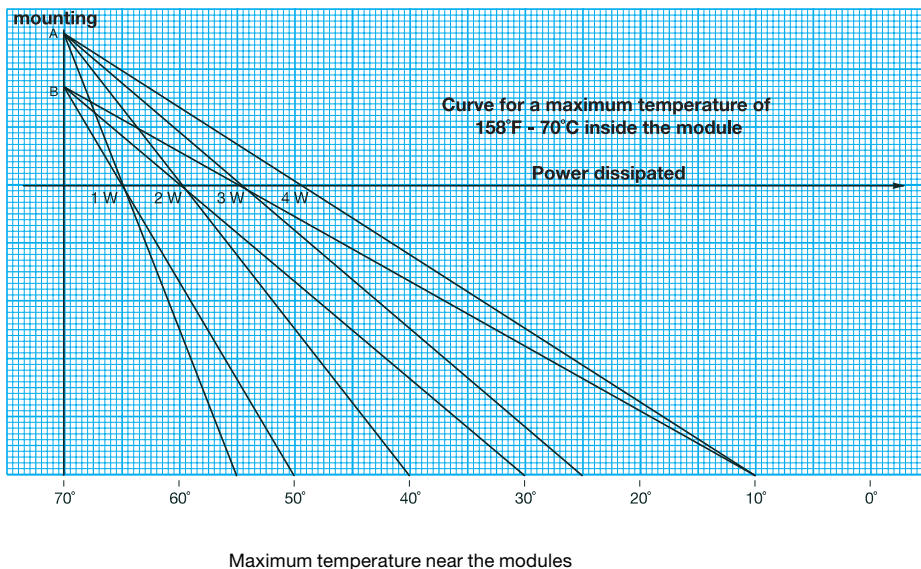

horizontal assembly

vertical assembly

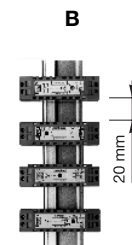
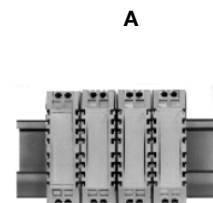

The characteristics shown on the left are given as a guide and may be modified without notice.