



Figure similar

SIGNALING COLUMN AS-INTERFACE ELEMENT WITH EXT. AUX. VOLTAGE OR WITHOUT EXT. AUX. VOLTAGE 24V DC, FOR MAX.4 SIGNAL ELEMENTS

General technical data:

product brand name		SIRIUS
Type of voltage of the operating voltage		DC
Operating voltage		
• for DC Rated value	V	31.6 ... 18.5
• 1 for DC Rated value	V	24
Equipment marking acc. to DIN EN 61346-2		B

Mechanical data:

Outer diameter of the signal column element	mm	70
---	----	----

Ambient conditions:

Ambient temperature during operation	°C	-20 ... +50
Protection class IP		IP65
Design of the interface AS-interface protocol		Yes
Height	mm	65.5
Width	mm	70

Certificates/ approvals:

General Product Approval	EMC	Declaration of Conformity	Shipping Approval
--------------------------	-----	---------------------------	-------------------



## Further information

### Information- and Downloadcenter (Catalogs, Brochures,...)

<http://www.siemens.com/industrial-controls/catalogs>

### Industry Mall (Online ordering system)

<http://www.siemens.com/industrymall>

### Cax online generator

<http://support.automation.siemens.com/WW/CAXorder/default.aspx?lang=en&mfb=8WD44280BE>

### Service&Support (Manuals, Certificates, Characteristics, FAQs,...)

<https://support.industry.siemens.com/cs/ww/en/ps/8WD44280BE>

### Image database (product images, 2D dimension drawings, 3D models, device circuit diagrams, EPLAN macros, ...)

[http://www.automation.siemens.com/bilddb/cax\\_de.aspx?mfb=8WD44280BE&lang=en](http://www.automation.siemens.com/bilddb/cax_de.aspx?mfb=8WD44280BE&lang=en)

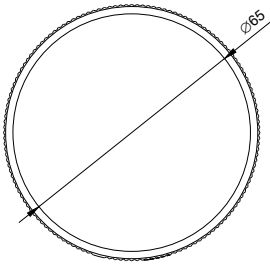
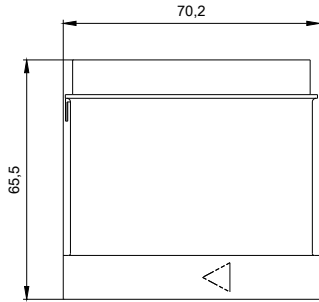

W9 3751 8WD4428-0Bx\_ALL

last modified:

15.01.2015