

## Pozidrive/slotted collar screw



Part no.: 21101-101

## Features:

- For assembly of partial width front panels
- For use of threaded inserts
- For europacPRO and ratiopacPRO

[Add to basket](#)



## Technical Information:

Description	Description	Qty/PU	Application
M2.5 × 12.3, St, nickel-plated	M2.5 × 12.3, St, nickel-plated	100 piece	Assembly of front panel and rear panel on extruded side panel/rear extrusion of side panel

## Downloads:

3D PDF with CAD data (DWG/DXF/PDF/E-DRAWING/STEP) ([Log in](#) required) 

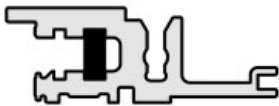
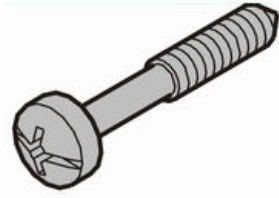
To gain access to the additional information you must [log in](#).  
If you do not yet have a user name, you may [register here](#).



Application: Front panel mounts onto horizontal rail where threaded insert is pushed in at rear

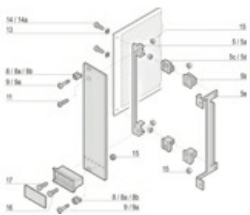

Item 9a, 3 U front panel mounting

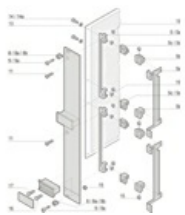

Item 9a, 6 U front panel mounting

Product illustrations are exemplary illustrations and can deviate from supplied products.