

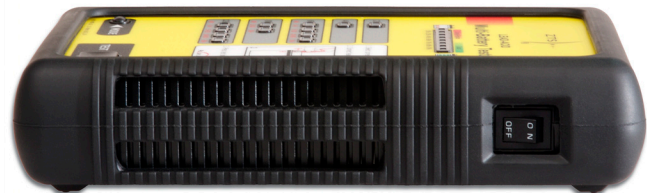

- ZTS, Inc. • Cincinnati, OH
- Toll-free: 888-796-2777
- ztsinc.com

## MBT-LA2 Data Sheet



Rugged NBR rubber sleeve

Internal cooling fan



48" interchangeable test leads

### Features

- Computes State of Charge for lead acid battery types (SLA, AGM, Gel, Flooded)
- Test battery condition - quickly and easily identifies weak or failing batteries
- Patented high accuracy Pulse Load test - battery safe, non-invasive
- Test 2-volt, 4-volt, 6-volt, 8-volt, 12-volt
- Measures battery performance under load, not just voltage or internal resistance
- Ideal for battery management and cell matching - reduce costs and increase reliability
- Made in U.S.A. Patents 6,823,274 - D611851

### Description

The MBT-LA2 provides a comprehensive means of testing the state of charge and battery condition for 2-volt, 4-volt, 6-volt, 8-volt, and 12-volt lead acid battery types (SLA, AGM, Gel, Wet). Lightweight, compact design make it an ideal tool for anyone working with lead acid batteries. This microprocessor-controlled instrument tests popular batteries using a patented, high accuracy pulse load test. After a fully automatic test cycle, percentage of remaining battery capacity is indicated on the LED bar display. Test results are easy to understand. An integrated cooling fan dissipates heat from testing, and the circuit is protected against over-voltage. Rugged NBR rubber sleeve protects against impact. Includes 48" removeable test leads with solid copper clamps. The accessory kit (K-MBTLA2) includes a hanging strap & magnet for hands-free operation, and a protective soft case. *Requires 4AA batteries (not included).*

### Applications

- Fire/security
- UPS
- Medical
- Industrial
- Lighting
- Telecom
- Mobility
- Access control
- Auto/marine/RV
- Inspection
- IT
- Utilities
- Military
- Manufacturing
- Safety
- Service

## Specifications

P/N: MBT-LA2

Testing capability (modes):    2-volt [2-25AH]  
    4-volt [2-25AH]  
    6-volt [1-4AH, 5-15AH, 16-50AH, 50-200AH]  
    8-volt [2-20AH, 21-150AH]  
    12-volt [1-4AH, 5-15AH, 16-50AH, 50-200AH]

Power (internal): 4 x AA batteries

Auto shut-off: After 20 minutes w/o test activity

Display: 8 LEDs - colors green, yellow, red

Pulse Load: magnitude varies according to battery type

Test duration: approx. 15 seconds

Test leads: 48" rubber coated lead wire, solid copper clamps, R/A sheathed banana plugs

Dimensions: 9.25 x 6.25 x 2.00 inches

Weight: approx. 32 oz (908 g)

UPC: 856777000206

## MBT-LA2 Accessory Kit

This accessory kit includes a protective soft case, suspension crown/hanging strap, and strong magnet. The soft case has a secure Velcro® flap and protects against dirt and impact. The hanging strap has a quick release buckle for easy fastening to conduit, pipes, ladder rung, etc., and the magnet enables attachment to metal surfaces such as battery cabinets.

P/N: K-MBTLA2

UPC: 856777000213

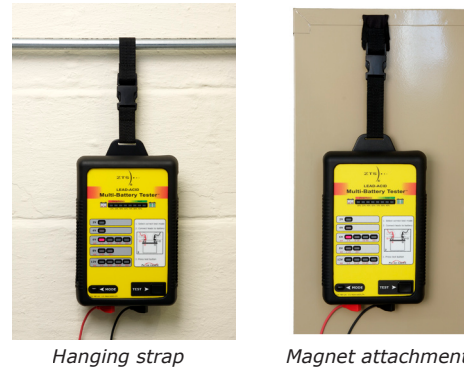
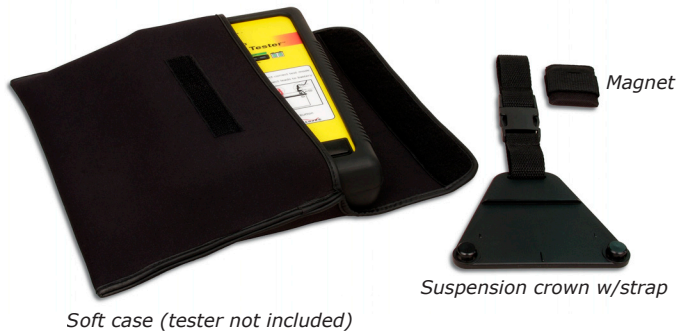

## Lead sets

These flexible 48" lead sets feature high strand count 18AWG rubber coated, kinkless lead wire with R/A sheathed banana plugs. Two styles of solid copper clamps available (Clip-type is standard on MBT-LA2).

### **Clip-type (standard on MBT-LA2)**

P/N: LSC-MBTLA2

Clamp: solid copper - max jaw opening: 0.625"

UPC: 856777000220



*LSC-MBTLA2 (standard on MBT-LA2)*

### **Plier-type (accessory)**

P/N: LSP-MBTLA2

Clamp: solid copper - max opening: 1.125"

UPC: 856777000237



*LSP-MBTLA2 (ideal for large batteries)*