

## Star Knobs GV, similar to DIN 6336, Thermoplast

**Material:** Thermoplast Polyamide PA6 GV,  
glass-fibre reinforced, impact resistant, black matt.  
**Bush:** Steel, zinc-plated, chromated blue.

**Version E** = with tapped blind hole  $d_2$ .

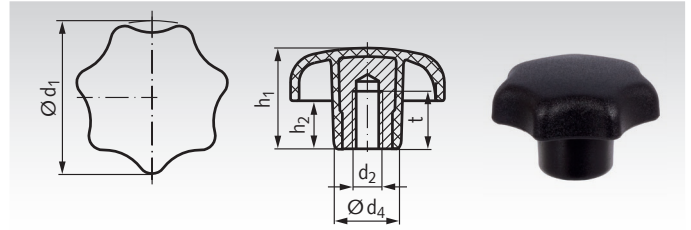

Ordering Details: e.g.: Product No. 661 432 00, Star Knob Thermoplast, 32 mm

Product No. Version E	$d_1$ mm	$d_2$ mm	$d_4$ mm	$h_1$ mm	$h_2$ mm	t min. mm	Weight g
661 432 00	32	M6	14	20	10	9	12
661 440 00	40	M8	18	25	13	12	20
661 450 00	50	M10	22	32	17	15	34
661 463 00	63	M12	26	40	21	18	65
661 480 00	80	M16	35	50	25	24	127

## Star Knob Screws ST and GV, similar to DIN 6336, Thermoplast

**Material Version ST:** Thermoplast Polyamide PA.  
Threaded bolt: Steel, zinc-plated, chromated blue.

**Material Version GV:** Thermoplast Polyamide PA6 GV,  
glass-fibre reinforced, impact resistant, black matt.  
Threaded bolt: Steel, zinc-plated, chromated blue.

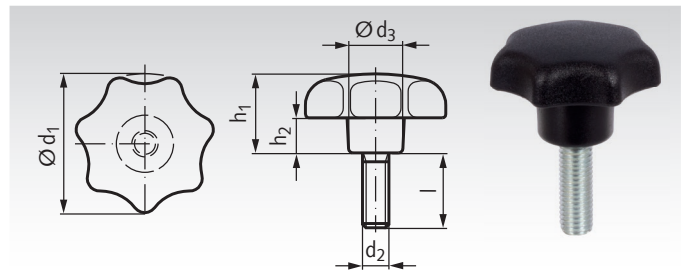

Ordering Details: e.g.: Product No. 661 825 10, Star Knob screw ST, 25 mm, M5x10mm

Product No. Version ST	Product No. Version GV	$d_1$ mm	$d_2$ mm	l mm	$d_3$ mm	$h_1$ mm	$h_2$ mm	Weight g
661 825 10	-	25	M5	10	12	16	8	5
661 825 15	-	25	M5	15	12	16	8	7
661 825 20	-	25	M5	20	12	16	8	8
661 832 10	-	32	M6	10	14	20	10	10
661 832 16	-	32	M6	16	14	20	10	11
661 832 20	661 432 20	32	M6	20	14	20	10	12
661 832 25	-	32	M6	25	14	20	10	13
-	661 432 30	32	M6	30	14	20	10	14
-	661 432 40	32	M6	40	14	20	10	15
661 840 16	-	40	M8	16	18	25	13	21
661 840 20	661 440 20	40	M8	20	18	25	13	22
661 840 25	-	40	M8	25	18	25	13	24
661 840 30	661 440 30	40	M8	30	18	25	13	26
-	661 440 40	40	M8	40	18	25	13	30
-	661 440 50	40	M8	50	18	25	13	34
661 850 20	-	50	M10	20	22	32	17	43
661 850 25	661 450 25	50	M10	25	22	32	17	45
661 850 30	661 450 30	50	M10	30	22	32	17	48
-	661 450 40	50	M10	40	22	32	17	54
661 850 45	-	50	M10	45	22	32	17	58
-	661 450 50	50	M10	50	22	32	17	61
661 863 20	-	63	M12	20	26	40	21	79
661 863 30	661 463 30	63	M12	30	26	40	21	91
661 863 40	661 463 40	63	M12	40	26	40	21	105
-	661 463 50	63	M12	50	26	40	21	110
661 863 60	661 463 60	63	M12	60	26	40	21	115

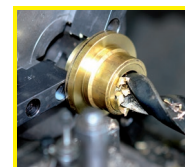

**Reworking within  
24h-service possible.  
Custom made parts  
on request.**