



CIRCUIT-BREAKER SZ S00, FOR TRANSFORMER
 PROT. A-RELEASE 0.55...0.8A, N-RELEASE16A
 SPRING-L. CONNECTION, STANDARD SW.
 CAPACITY

| | | |
|---------------------|--|----------------------|
| product brand name | | SIRIUS |
| Product designation | | 3RV2 circuit breaker |

| General technical data: | | |
|---|----|-------------|
| Active power loss total typical | W | 6 |
| Insulation voltage | | |
| • with degree of pollution 3 Rated value | V | 690 |
| Shock resistance | | |
| • acc. to IEC 60068-2-27 | | 25g / 11 ms |
| Surge voltage resistance Rated value | kV | 6 |
| Mechanical service life (switching cycles) | | |
| • of the main contacts typical | | 100 000 |
| • of the auxiliary contacts typical | | 100 000 |
| Electrical endurance (switching cycles) | | |
| • typical | | 100 000 |
| Temperature compensation | °C | -20 ... +60 |
| Protection class IP | | |
| • on the front | | IP20 |
| • of the terminal | | IP20 |
| Equipment marking | | |
| • acc. to DIN EN 81346-2 | | Q |

| Main circuit: | | |
|--|---|--------------|
| Number of poles for main current circuit | | 3 |
| Adjustable response value current of the current-dependent overload release | A | 0.55 ... 0.8 |
| Operating voltage | | |

| | | |
|--------------------------------------|-----|-----------|
| • Rated value | V | 690 |
| • at AC-3 Rated value maximum | V | 690 |
| Operating frequency Rated value | Hz | 50 ... 60 |
| Operating current Rated value | A | 0.8 |
| Operating current | | |
| • at AC-3 | | |
| — at 400 V Rated value | A | 0.8 |
| Operating power | | |
| • at AC-3 | | |
| — at 230 V Rated value | W | 120 |
| — at 400 V Rated value | W | 180 |
| — at 500 V Rated value | W | 250 |
| — at 690 V Rated value | W | 370 |
| Operating frequency | | |
| • at AC-3 maximum | 1/h | 15 |

Auxiliary circuit:

| | | |
|---|--|-----|
| Number of NC contacts | | |
| • for auxiliary contacts | | 0 |
| Number of NO contacts | | |
| • for auxiliary contacts | | 0 |
| Number of CO contacts | | |
| • for auxiliary contacts | | 0 |
| Product expansion Auxiliary switch | | Yes |

Protective and monitoring functions:

| | | |
|--|----|----------|
| Trip class | | CLASS 10 |
| Design of the overload circuit breaker | | thermal |
| Operational short-circuit current breaking capacity (Ics) with AC | | |
| • at 240 V Rated value | kA | 100 |
| • at 400 V Rated value | kA | 100 |
| • at 500 V Rated value | kA | 100 |
| • at 690 V Rated value | kA | 100 |
| Maximum short-circuit current breaking capacity (Icu) | | |
| • with AC at 240 V Rated value | kA | 100 |
| • with AC at 400 V Rated value | kA | 100 |
| • with AC at 500 V Rated value | kA | 100 |
| • with AC at 690 V Rated value | kA | 100 |
| Breaking capacity short-circuit current (Icn) | | |
| • with 1 current path for DC at 150 V Rated value | kA | 10 |
| • with 2 current paths in series for DC at 300 V Rated value | kA | 10 |

| | | |
|--|----|----|
| <ul style="list-style-type: none"> with 3 current paths in series for DC at 450 V Rated value | kA | 10 |
| Response value current of the instantaneous short-circuit release | A | 16 |

UL/CSA ratings:

| | | |
|--|---|-----|
| Full-load current (FLA) for three-phase AC motor | | |
| <ul style="list-style-type: none"> at 480 V Rated value | A | 0.8 |
| <ul style="list-style-type: none"> at 600 V Rated value | A | 0.8 |

Short-circuit:

| | | |
|--|--|-----------|
| Product function Short circuit protection | | Yes |
| Design of the short-circuit trip | | magnetic |
| Design of the fuse link for IT network for short-circuit protection of the main circuit | | |
| <ul style="list-style-type: none"> at 690 V | | gL/gG 6 A |

Installation/ mounting/ dimensions:

| | | |
|--|----|---|
| mounting position | | any |
| Mounting type | | screw and snap-on mounting onto 35 mm standard mounting rail according to DIN EN 60715 |
| Height | mm | 106 |
| Width | mm | 45 |
| Depth | mm | 96 |
| Required spacing | | |
| <ul style="list-style-type: none"> with side-by-side mounting <ul style="list-style-type: none"> — forwards — Backwards — upwards — downwards — at the side for grounded parts <ul style="list-style-type: none"> — forwards — Backwards — upwards — at the side — downwards for live parts <ul style="list-style-type: none"> — forwards — Backwards — upwards — downwards — at the side | mm | 0 0 50 50 0 0 0 50 30 50 0 0 50 50 30 |

Connections/ Terminals:

| | | |
|--|--|---|
| Type of electrical connection • for main current circuit | | spring-loaded terminals |
| Arrangement of electrical connectors for main current circuit | | Top and bottom |
| Product function • removable terminal for auxiliary and control circuit | | No |
| Type of connectable conductor cross-section • for main contacts — single or multi-stranded — finely stranded with core end processing — finely stranded without core end processing • for AWG conductors for main contacts | | 2x (0,5 ... 4 mm ²) 2x (0.5 ... 2.5 mm ²) 2x (0.5 ... 2.5 mm ²) 2x (20 ... 12) |
| Design of screwdriver shaft | | Diameter 5 to 6 mm |

Safety related data:

| | | |
|--|--------|-------------|
| B10 value with high demand rate acc. to SN 31920 | | 50 000 |
| Proportion of dangerous failures • with low demand rate acc. to SN 31920 • with high demand rate acc. to SN 31920 | % % | 40 40 |
| Failure rate [FIT] with low demand rate acc. to SN 31920 | FIT | 50 |
| T1 value for proof test interval or service life acc. to IEC 61508 | y | 10 |
| Protection against electrical shock | | finger-safe |

Mechanical data:

| | | |
|------------------------------------|--|-----|
| Size of the circuit-breaker | | S00 |
|------------------------------------|--|-----|

Ambient conditions:

| | | |
|--|----------------|---|
| Installation altitude at height above sea level maximum | m | 2 000 |
| Ambient temperature • during operation • during storage • during transport | °C °C °C | -20 ... +60 -50 ... +80 -50 ... +80 |
| Relative humidity during operation | % | 10 ... 95 |





Display:

| | | |
|--|--|--------|
| Display version • for switching status | | Handle |
|--|--|--------|

Certificates/ approvals:

| | | | | | |
|--|--|---|---|--|--|
| General Product Approval | | | Declaration of Conformity | Test Certificates | |
|  CCC |  CSA |  |  EG-Konf. | Special Test Certificate | Type Test Certificates/Test Report |

| | | | | | |
|--|--|---|--|---|--|
| Test Certificates | Shipping Approval | | | | |
| Declaration of the Compliance with the order |  ABS |  BUREAU VERITAS |  DNV |  GL |  LRS |

| | | | | | |
|--|---|---|------------------------------|---|--|
| Shipping Approval | other | | | | |
|  PRS |  RINA |  RMRS | Confirmation | Environmental Confirmations |  VDE |

| |
|-----------------------|
| other |
| other |

Further information

Information- and Downloadcenter (Catalogs, Brochures,...)

<http://www.siemens.com/industrial-controls/catalogs>

Industry Mall (Online ordering system)

<http://www.siemens.com/industrymall>

Cax online generator

<http://support.automation.siemens.com/WW/CAXorder/default.aspx?lang=en&mfb=3RV24110HA20>

Service&Support (Manuals, Certificates, Characteristics, FAQs,...)

<http://support.automation.siemens.com/WW/view/en/3RV24110HA20/all>

Image database (product images, 2D dimension drawings, 3D models, device circuit diagrams, EPLAN macros, ...)

http://www.automation.siemens.com/bilddb/cax_de.aspx?mfb=3RV24110HA20&lang=en

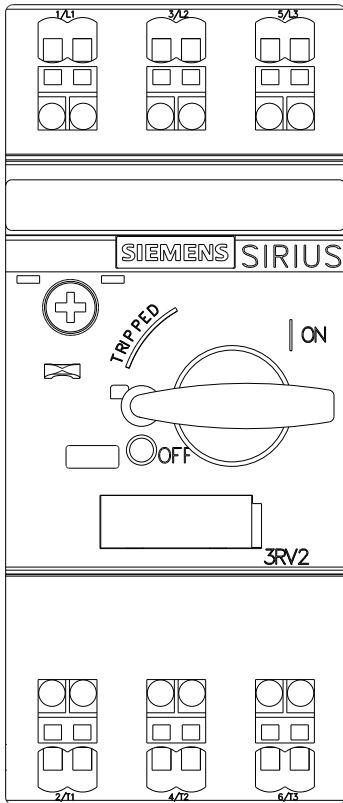
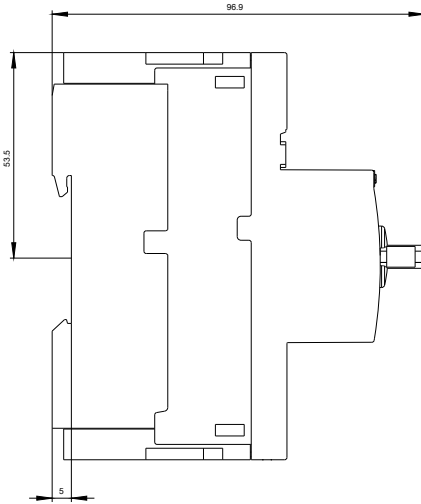
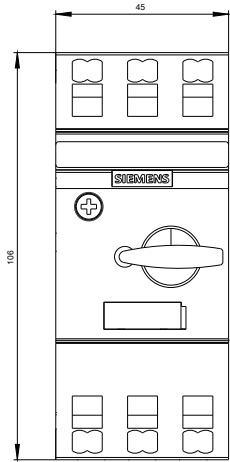



last modified:

11.03.2015