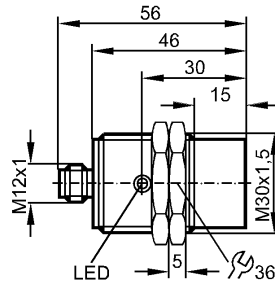

I15430

IIB3015-BPKG/US-100-DPS

Inductive sensors

Product characteristics

Inductive sensor

Metal thread M30 x 1.5

Connector

Sensing range 15 mm; [nf] non-flush mountable

Electrical data

Electrical design	DC PNP
Operating voltage [V]	18...36 DC
Current consumption [mA]	15
Protection class	III
Reverse polarity protection	yes

Outputs

Output function	normally open
Voltage drop [V]	< 2.5
Current rating [mA]	125; 150 (...50 °C)
Short-circuit protection	pulsed
Overload protection	yes
Switching frequency [Hz]	250

Range

Sensing range [mm]	15
Real sensing range (Sr) [mm]	15 ± 10 %
Operating distance [mm]	0...12.15

Accuracy / deviations

Correction factors	mild steel = 1 / stainless steel approx. 0.7 / brass approx. 0.4 / Al approx. 0.3 / Cu approx. 0.2
Hysteresis [% of Sr]	1...15
Switch-point drift [% of Sr]	-10...10

Environment

Ambient temperature [°C]	-25...80
Protection	IP 67

Tests / approvals

I15430

IIB3015-BPKG/US-100-DPS

Inductive sensors

EMC	EN 60947-5-2 EN 55011:	class B
MTTF	[Years]	901

Mechanical data

Mounting	non-flush mountable
Housing materials	Brass white bronze coated; PBT
Weight [kg]	0.115

Displays / operating elements

Output status indication	LED	yellow
--------------------------	-----	--------

Electrical connection

Connection	M12 connector
------------	---------------

Wiring

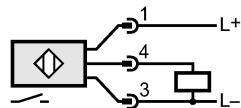

Accessories

Accessories (included)	2 lock nuts
------------------------	-------------

Remarks

Pack quantity	[piece]	1
---------------	---------	---