



MATERIAL

Glass-fibre reinforced polyamide (PA) SUPER-technopolymer, black colour, matte finish.

ROTATING PIN

Self-lubricating glass-fibre reinforced polyamide based (PA) technopolymer, black colour.

STANDARD EXECUTIONS

- Pass-through holes for countersunk head screws.
- **CFMY-D**: rotation pin fitted on the right hinge body.
- **CFMY-S**: rotation pin fitted on the left hinge body.

ROTATION ANGLE (APPROXIMATE VALUE)

Max 270° (-90° and +180° being 0° the condition where the two interconnected surfaces are on the same plane). Do not exceed the rotation angle limit so as not to prejudice the hinge mechanical performance. To choose the convenient type and the right number of hinges for your application, see the Guidelines (see page 1298).

MATERIAL

Die-cast zinc alloy.

COLOUR

Black epoxy resin coating , matte finish.

ROTATING PIN

AISI 303 stainless steel.

WASHER

Polyamide based (PA) technopolymer.

STANDARD EXECUTIONS

- **CMMY-D**: pin fixed to the right body.
- **CMMY-S**: pin fixed to the left body.

ROTATION ANGLE (APPROXIMATE VALUE)

Max 270° (-90° and +180° being 0° the condition where the two interconnected surfaces are on the same plane). Do not exceed the rotation angle limit so as not to prejudice the hinge mechanical performance.

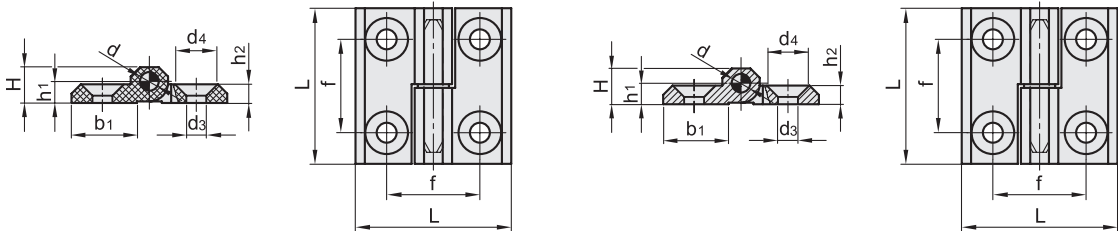
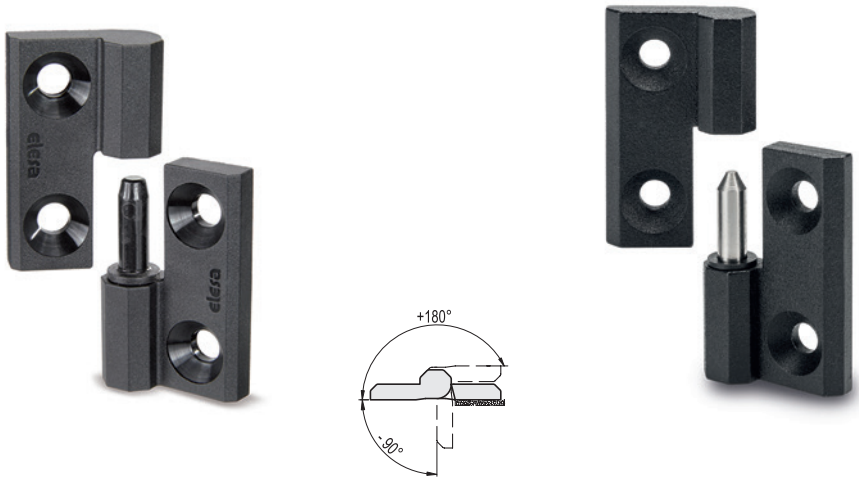

Code	Description	L	f±0.25	H	h1	h2	b1	d	d3	d4	C#	Δ
425981	CFMY.40 SH-4-D	40	25	9	5.5	5	14	4	4.5	8.5	3	14
425982	CFMY.40 SH-4-S	40	25	9	5.5	5	14	4	4.5	8.5	3	14
425971	CFMY.50 SH-6-D	50	30	11.5	6.5	6	18	6	6.5	12.5	5	30
425972	CFMY.50 SH-6-S	50	30	11.5	6.5	6	18	6	6.5	12.5	5	30
425965	CFMY.60 SH-6-D	60	36	15	8.5	8	26	6	6.5	12.5	5	41
425966	CFMY.60 SH-6-S	60	36	15	8.5	8	26	6	6.5	12.5	5	41
425961	CFMY.60-SH-8-D	60	36	15	8.5	8	26	8	8.5	16.5	5	41
425962	CFMY.60-SH-8-S	60	36	15	8.5	8	26	8	8.5	16.5	5	41

Code	Description	L	d3	d4	f	H	h1	h2	b1	d	Δ
428801	CMMY.40-SH-5-D	40	5.3	10.5	25	9	5.5	5	16	4	40
428802	CMMY.40-SH-5-S	40	5.3	10.5	25	9	5.5	5	16	4	41
428811	CMMY.50-SH-6-D	50	6.4	12.5	30	11.5	6.5	6	21	6	80
428812	CMMY.50-SH-6-S	50	6.4	12.5	30	11.5	6.5	6	21	6	83
428821	CMMY.60-SH-8-D	60	8.3	16.5	36	15	8.5	8	26	8	153
428822	CMMY.60-SH-8-S	60	8.3	16.5	36	15	8.5	8	26	8	156

Suggested tightening torque for assembly screws.

