

PLEASE CHECK WWW.MOLEX.COM FOR LATEST PART INFORMATION

Part Number: **0191930233**
Status: **Active**
Overview: VersaKrimp Terminals and Splices
Description: VersaKrimp Ring Tongue Terminal for 6 AWG Wire

Documents:

Drawing (PDF) Product Specification PS-19902-013-001 (PDF)
Product Specification PS-19902-011-001 (PDF) RoHS Certificate of Compliance (PDF)

Agency Certification

CSA LR18689
 UL E32244

General

Product Family Ring and Spade Terminals
 Series 19193
 Crimp Quality Equipment Yes
 Mil-Spec N/A
 Overview VersaKrimp Terminals and Splices
 Product Name VersaKrimp
 Type Ring
 UPC 800755050806

Physical

Barrel Type Closed - Brazed
 Insulation None
 Material - Plating Mating Tin
 Net Weight 5.674/g
 Packaging Type Bag
 Plating min - Mating 2.540µm
 Plating min - Termination 2.540µm
 Stud Size 5/8" (M16)
 Termination Interface: Style Crimp or Compression
 Wire Size AWG 6

Material Info

Engineering Number E-358-58

Reference - Drawing Numbers

Product Specification PS-19902-011-001, PS-19902-013-001
 Sales Drawing SD-19193-005

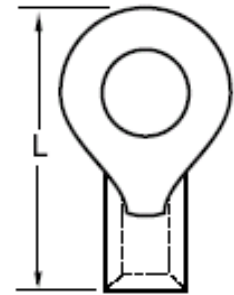

Series image - Reference only

EU ELV

Not Relevant

EU RoHS

Compliant

REACH SVHC

Not Contained Per
 -ED/88/2018 (15
 January 2019)

Halogen-Free

Status

Low-Halogen

For more information, please visit [Contact US](#)

China ROHS

ELV

RoHS Phthalates

China RoHS

Green Image

Not Relevant

Not Contained

Search Parts in this Series

19193 Series

Application Tooling | FAQ

Tooling specifications and manuals are found by selecting the products below. Crimp Height Specifications are then contained in the Application Tooling Specification document.

Global

| Description | Product # |
|---|--------------------------------------|
| Manual Putt Pump Hydraulic System, Die set required | <u>192860117</u> |
| Die Set (large) for the HHLS Hydraulic Crimper | <u>192900004</u> |
| Hydraulic Dieless Crimping Tool | <u>638161700</u> |
| Hand Crimp Tool Square "DIN" style dies for 6 AWG | <u>640013900</u> <u>640037770</u> |
| Crimp Head for the AT-200 Pneumatic Hand Tool | <u>640074300</u> |

This document was generated on 04/03/2019

PLEASE CHECK WWW.MOLEX.COM FOR LATEST PART INFORMATION