

ROLINE LCD Monitor Stand Pneumatic, Wall Mount, Pivot, 2 Joints

Product No. 17.03.1178
Manufacturer ROLINE
Manufacturer No. 17.03.1178
EAN (single piece) 7611990132348

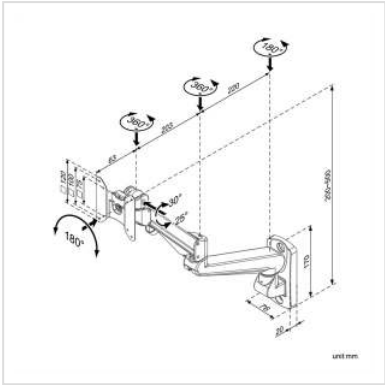

- Delicate and streamlined design
- Made of high quality aluminum alloy
- Gas spring integrated allows users to move the LCD panel in most positions at will
- Meets VESA 75 (75x75 mm) or VESA 100 (100x100 mm)
- Special feature: Pivot function - screen is 90 degrees rotatable
- Wall Mount
- A clever cable management is built into the rear arm

Specifications:

- Arm extension: ~ 486 mm
- Lift: 200 ~ 500 mm
- Monitor pivot: 180°
- Rotation: 360° (arm & display)
- Loading capacity: 3 ~ 8 kg

| Technical specifications | |
|--------------------------|--------------------------|
| Manufacturer | ROLINE |
| Product group | LCD-Monitor arms |
| Product type | Monitor Arms, wall mount |
| Colour | silver |
| Load capacity | 3-8 kg |

| | |
|-------------------------|---------------------|
| Quantity of pivots | 4 |
| Fixing | Wall Mount |
| Maximal arm length | 486 mm |
| Adjustments | Gas spring |
| VESA 75 x 75 mm | Yes |
| VESA 100 x 100 mm | Yes |
| Technical particularity | Pivot functionality |