

## 7/8" Mini-Receptacle Connectors, Front Mount, IEC Color Code

RSF.../11 | RSF.../13.5 | RKF.../11 | RKF.../13.5



### Male, 2-, 3-, 4-, and 5-Pole

Receptacle connector, 7/8"-A body, male 2-, 3-, 4-, and 5-pole for front mounting, assembled stranded wire, potted with epoxy, chassis side thread PG11 or PG13.5, screw connection (panel nut RSKF 11 or RSKF 13.5).

RSF.../11

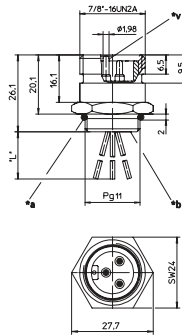

\*a O-ring enclosed separately  
 \*b solder contacts potted with epoxy  
 \*L 0.3 m

RSF.../13.5

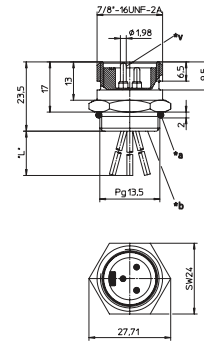

\*a O-ring enclosed separately  
 \*b solder contacts potted with epoxy  
 \*V center contact leading  
 \*L 0.3 m



### Female, 2-, 3-, 4-, and 5-Pole

Receptacle connector, 7/8"-A body, female 2-, 3-, 4-, and 5-pole for front mounting, assembled stranded wire, potted with epoxy, chassis side thread PG11 or PG13.5, screw connection (panel nut RSKF 11 or RSKF 13.5).

RKF.../11

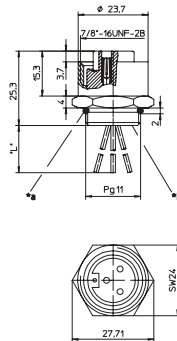

\*a O-ring enclosed separately  
 \*b solder contacts potted with epoxy  
 \*L 0.3 m

RKF.../13.5

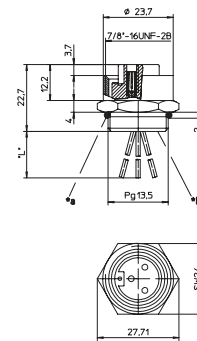

\*a O-ring enclosed separately  
 \*b solder contacts potted with epoxy  
 \*L 0.3 m

### Pin Assignments

Face Views, 7/8"-Male / Female

2 pole

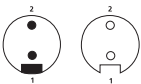

1 = brown  
 2 = blue

3 pole

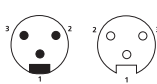

1 = brown  
 2 = black  
 3 = blue

4 pole

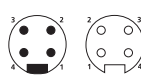

1 = brown  
 2 = white  
 3 = blue  
 4 = black

5 pole

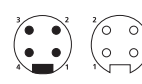

1 = black  
 2 = blue  
 3 = green/yellow  
 4 = brown  
 5 = white



# Be Certain with Belden

## 7/8" Mini-Receptacle Connectors, Front Mount, IEC Color Code

RSF.../11 | RSF.../13.5 | RKF.../11 | RKF.../13.5

### Technical Data

#### Environmental









Degree of protection IP 68 / NEMA 6P  
 Operating temperature range -25°C (-13°F) / +90°C (+194°F)

#### Mechanical

Housing / Molded body CuZn, nickel-plated  
 Insert TPU, self-extinguishing  
 Contact CuZn, silver-plated and 0.3 microns gold-plated

#### Electrical

Contact resistance  $\leq 5 \text{ m}\Omega$   
 Nominal current at 40°C  
     2-3 poles 12 A  
     4-5 poles 9 A  
 Nominal voltage 240 V  
 Rated voltage 250 V  
 Test voltage  
     3-4 poles 2.5 kV eff. / 60 s  
     5 poles 1.5 kV eff. / 60 s  
 Insulation resistance  $> 10^9 \Omega$   
 Pollution degree 3

Part Number				Pins	Lead (mm <sup>2</sup> )	Characteristics
Male PG11	Male PG13.5	Female PG11	Female PG13.5			
RSF 20/11-03	RSF 20/13.5-03	RKF 20/11-03	RKF 20/13.5-03	2	0.75	 
RSF 30/11-01	RSF 30/13.5-01	RKF 30/11-01	RKF 30/13.5-01	3	0.75	 
RSF 30/11-05	RSF 30/13.5-05	RKF 30/11-05	RKF 30/13.5-05		0.75	 
RSF 40/11-02	RSF 40/13.5-02	RKF 40/11-02	RKF 40/13.5-02	4	0.5	 
RSF 50/11-04	RSF 50/13.5-04	RKF 50/11-04	RKF 50/13.5-04	5	0.5	