



MI Rocker Switch Circuit Breaker



The **TECHNA MI** offers a compact thermal circuit breaker in a rocker switch design, with or without illumination.

Standard Product

M1 Non-illuminated: Black Base • Black/Red 2-Colour Rocker • 0.25 Quick Connect Tabs • 250VAC • Marked 'Reset-off'

M1L Illuminated: Black Base • Red Rocker • 0.25 Quick Connect Tabs • 250VAC • Marked 'Reset-off'

Current Ratings

5, 6, 7, 8, 10, 12, 15, 16 & 20A

DE-RATING MULTIPLICATION FACTORS FOR AMBIENT TEMPERATURES								
Current Rating (A)	Temperature							
	°F	+50	+68	+77	+86	+104	+122	+140
	°C	+10	+20	+25	+30	+40	+50	+60
5 to 15A	Factor	.90	.95	1.00	1.10	1.32	1.61	2.15

For example

Your circuit draws a 10A current and is operating at an ambient temperature of 10°C.

From the table above at 10°C the multiplication factor is 0.9.

10A x 0.9 = 9 so you should use a 9A breaker for a 10A load operating at 10°C.

MI & M2 Ordering Scheme

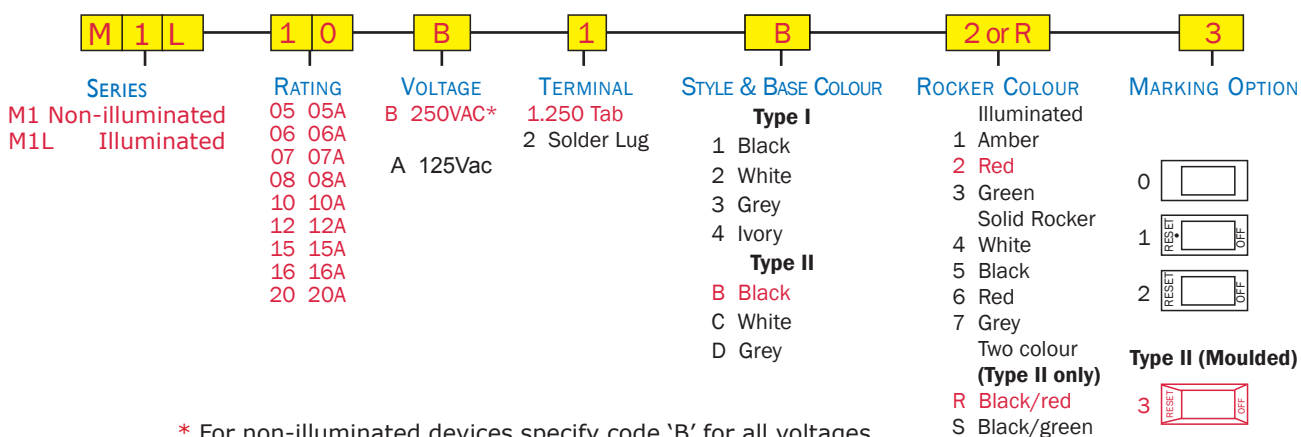

* For non-illuminated devices specify code 'B' for all voltages

Trip Curves

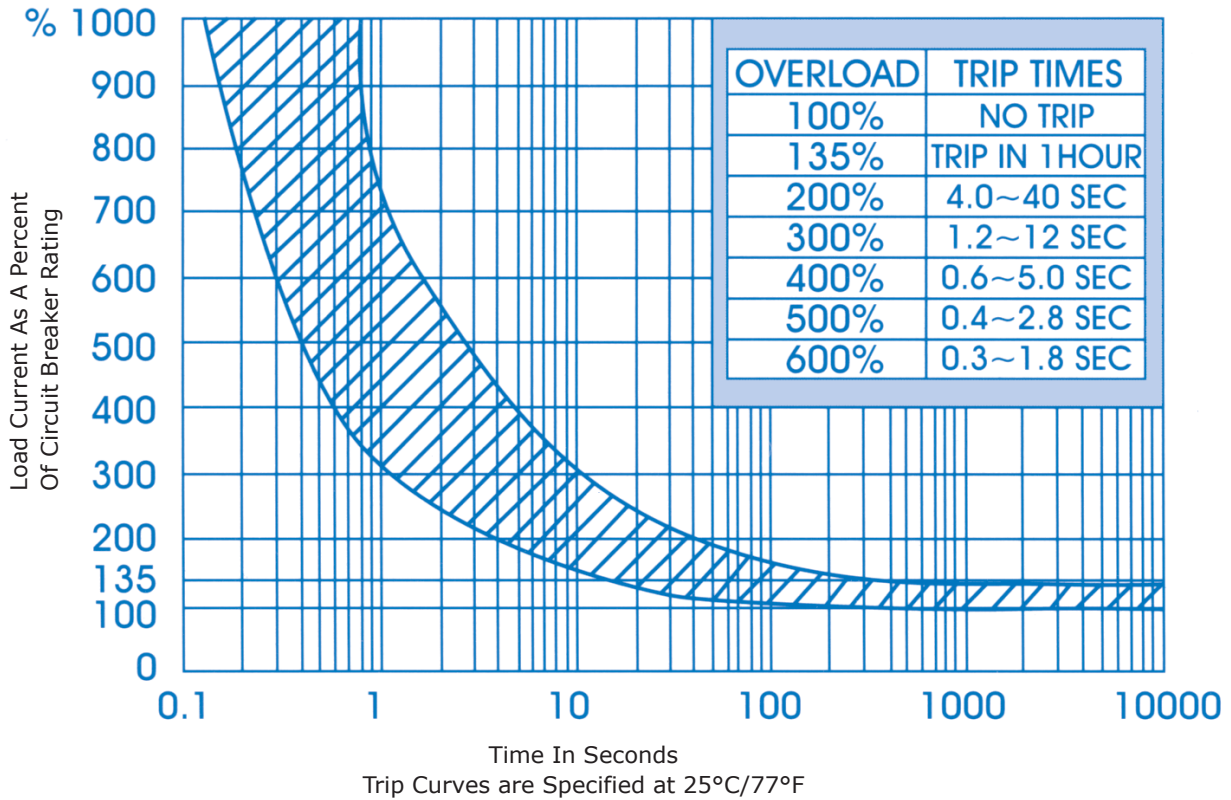

STRAIGHT
TYPE I

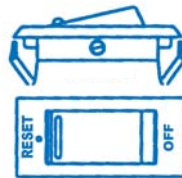

CURVED
TYPE II

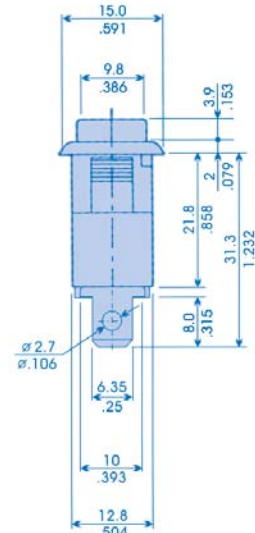
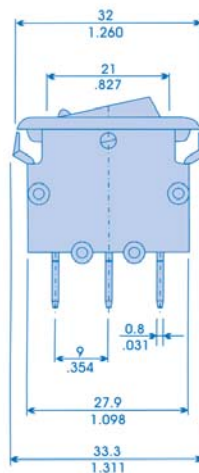
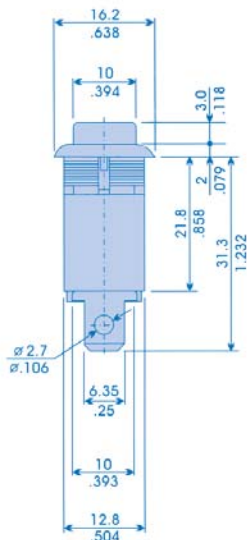

MI Technical Specification

MI SINGLE-POLE NON-ILLUMINATED	Black Base • Black/Red 2-Colour Rocker •
	0.25 Quick Connect Tabs • 250VAC • Marked 'Reset-off'
MI L SINGLE-POLE ILLUMINATED	Black Base • Red Rocker
	0.25 Quick Connect Tabs • 250VAC • Marked 'Reset-off'
CURRENT RATINGS	5, 6, 7, 8, 10, 12, 15, 16 & 20A
VOLTAGE DROP	Less than 0.25V
INTERRUPTING CAPACITY	1000A
TEMPERATURE RISE AT TERMINAL BLOCK	Less than 65°C (117°F)
RESETTABLE OVERLOAD CAPACITY	10 times rated current at 100% of rated current applied continuously at 25°C (70°F)
DIELECTRIC STRENGTH:	1,500Vac 1 minute
BASE MATERIAL:	Nylon 66 UL 94-V2
INSULATION RESISTANCE:	100 MΩ
ACTUATOR MATERIAL:	Polycarbonate (PC) UL 94-V2
CERTIFICATIONS:	UL1077