

Icons: 1/2 (two people), $\phi 5$ (pencil), \checkmark (correct), \times (incorrect), 1 (ruler), 70kg (weight), 5 OH, 6 OH, 7 OH (shelf heights), Innen-Eckregal (product name).

(8x)	(2x)	(1x)	(12x)	(6x)	(1x)	(1x)
(8x)	(4x)	(2x)	(1x)	(1x)		

5 OH	4x	16x	4x	8x
6 OH	5x	20x	8x	16x
7 OH	6x	24x	8x	16x

1. Attaching the top rail to the side panels using screws.

2. Attaching the bottom rail to the side panels using brackets (2.1) and screws (2.2).

3. Inserting shelves (3.2) into the side panels and securing them with brackets (3.1) and screws (4.1).

4. Mounting the unit to the wall using brackets and screws, ensuring it is level and angled at 135°.

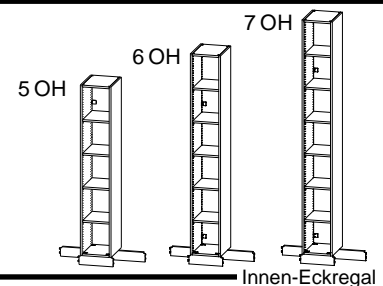
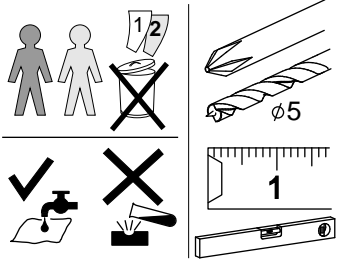

5.

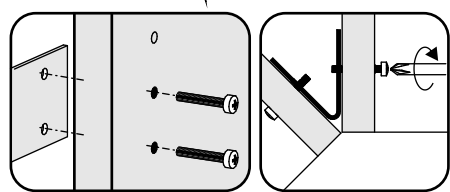
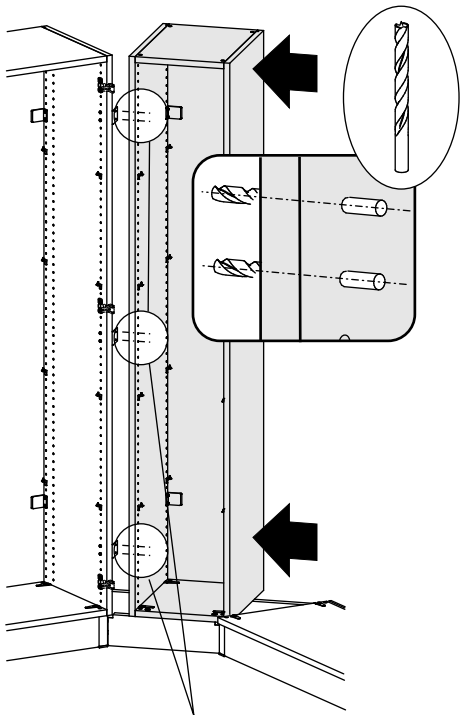

6.

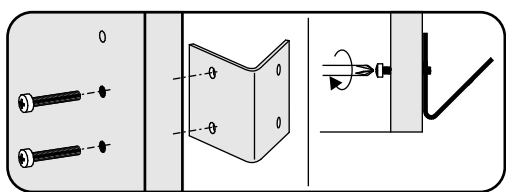
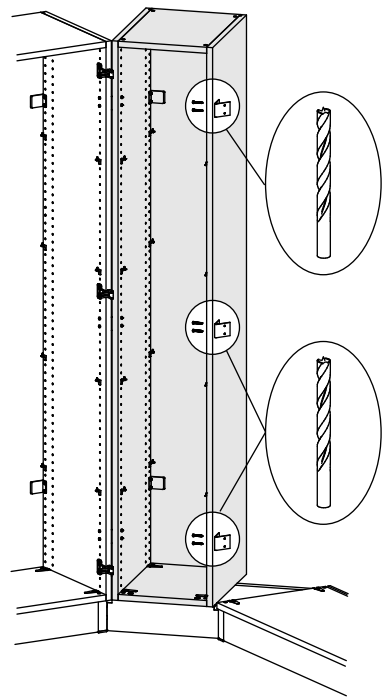

7.

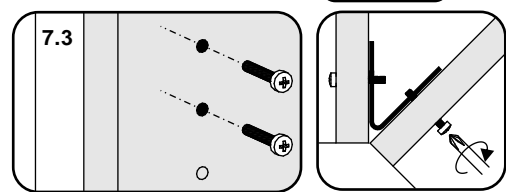
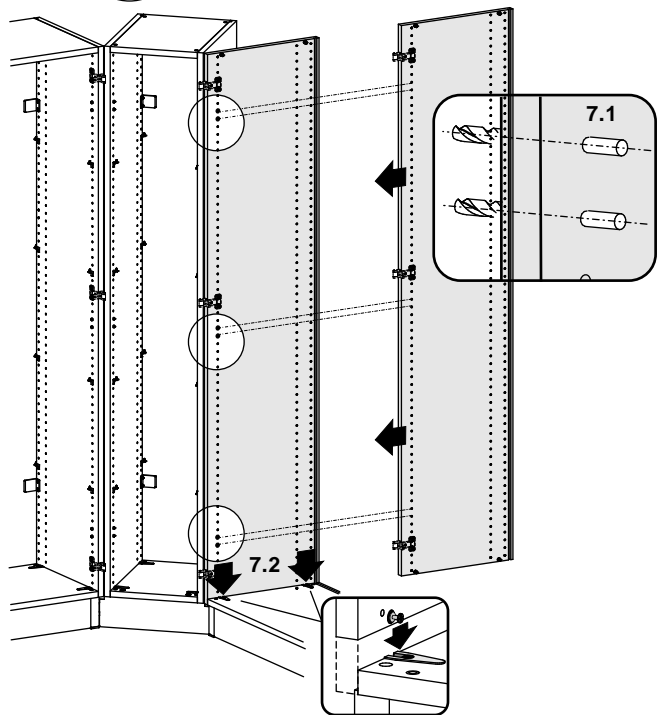

8.

