

## Diamond® Drop Hardware

### Drop Wire Clamps for CATV and Telephone Cable



#### Universal Messenger Cable Drop Wire Clamp



- Permits cable to “float” free, fully protected from strain and chafing.
- Drop clamp for the suspension of a messengered drop cable between the pole, midspan and house.
- For use with RG59, RG6 and other cables
- Stainless steel bail wire and aluminum body.

Part Number	Description	Inner Pack	Outer Pack
SC02MFA-SS	Universal Messenger Drop Wire Clamp	--	125

#### Installation:

1. Begin separation of the messenger wire from the cable using the end-edge of the SC02MFA-SS Drop Clamp.  
**Note:** Never use a knife or other sharp tool to separate messenger and cable.
2. Fit the cable and messenger wire into the SC02MFA-SS Drop Clamp as shown, so that the Clamp Bail is between the two.
3. Grasp the separated end of the messenger and cable with one hand and grip the Clamp Body, as shown, with your other hand. Then, pull the SC02MFA-SS back, in a straight line, separating the length of messenger wire needed to make the wrap; about 15 to 18-inches.
4. Pull the messenger wire around the center of the bearing surface as shown, toward the rear or drop-side of the Clamp.  
**Note:** If at the house end of the drop, this will be done while tensioning or “sagging” the drop.
5. Pass the messenger wire through the “L” Slots and begin the wrap about the SC02MFA-SS body, as shown.
6. Continue the messenger wire wrap for two full turns.
7. Pass the messenger wire through the “L” Slot, as shown, to the drop-side of the SC02MFA-SS and cut the excess wire away, or ground it to the strand.

**Note:** For drop cable with larger messenger wire, one wrap is sufficient. Wrap the end of the wire around the end of the SC02MFA-SS and bring it back up the “L” Slots, then cut away the excess, or ground it to the strand.

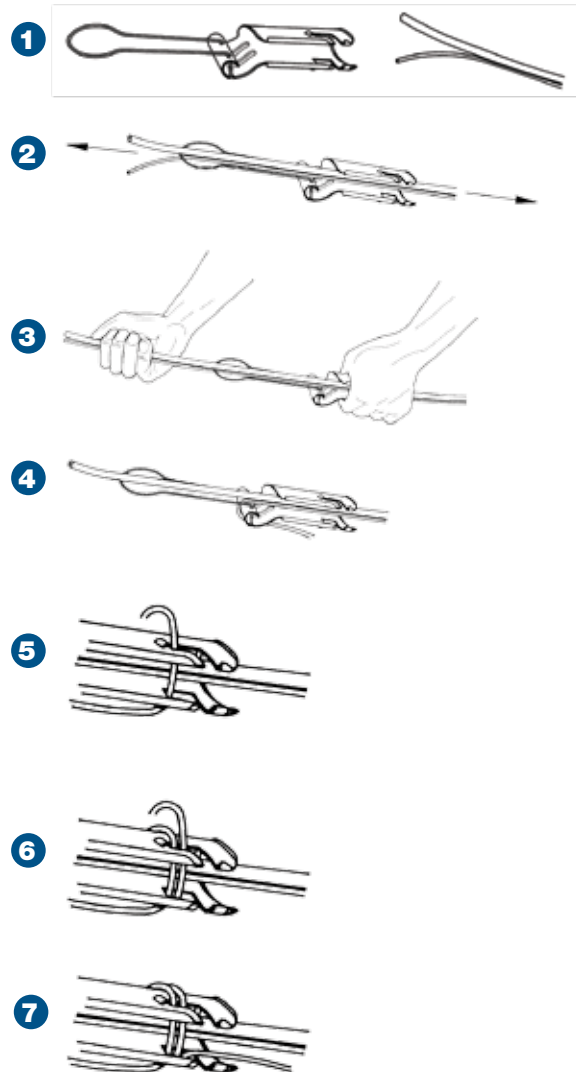



## Diamond® Drop Hardware

Drop Wire Clamps for CATV and Telephone Cable



### "B" Drop Wire Clamp



- Used to support both ends of telephone drop, at strand and building.
- Suitable for 1-2 pair .200" max. height and .410' max. width.
- 6 pair version: .300" max. height and .500" max. width.
- Stainless steel bailwire on all versions.
- Special Packages available. Please check with your PPC/Belden Representative.

Part Number	Description	Material	Pair	Shim Type	Inner Pack	Outer Pack
23-44441	"B" Drop Wire Clamp	Aluminum	1-2	Serrated	--	500
23-44444	"B" Drop Wire Clamp (Bell Packaging)	Aluminum	1-2	Serrated	25	500
23-44445	"B" Drop Wire Clamp	Aluminum	1-2	Serrated	2	250
23-82350	"B" Drop Wire Clamp	Aluminum	6	Dimpled	1	75
23-82351	"B" Drop Wire Clamp	Aluminum	6	Dimpled	25	150
23-88881	"B" Drop Wire Clamp (Bulk Packaging)	Stainless Steel	1-2	Serrated	25	500
23-88885	"B" Drop Wire Clamp	Stainless Steel	1-2	Serrated	2	250

### Installation:

1. Lay cable in shell.
2. Place shim on top of cable with raised embossings against cable.
3. Insert wedge in shell (on top of shim) and pull to engage. (Small end of wedge should be initially engaged in track of large end of shell).
4. Place bailwire on "B" drop wire hook (ram's horn) with wedge loose. Pull drop wire through clamp until proper sidewalk/alley clearance is achieved.
5. Grasp clamp (bailwire still on ram's horn) and pull tightly to secure.

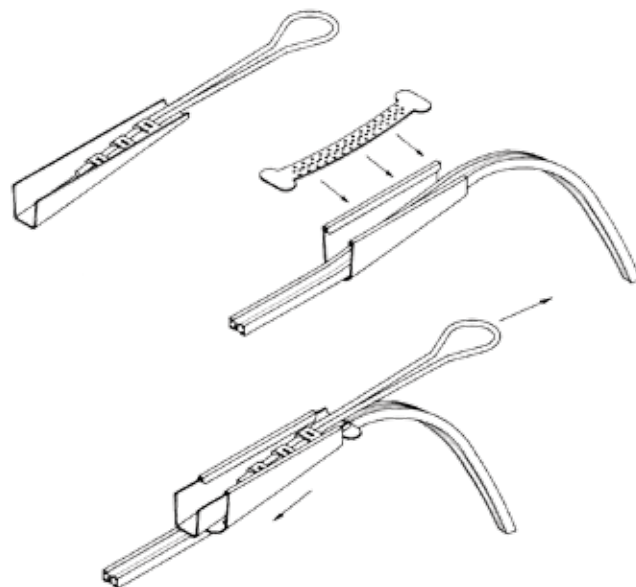

## Diamond® Drop Hardware

### Span Clamps



#### "Q" Span Clamp



- Provides drop wire take offs at mid-span.
- Steel components mechanically galvanized ASTM B695.

Part Number	Description	Material	Clamp Range	PigTail Diameter	Inner Pack	Outer Pack
27-00185	"Q" Span Clamp	Steel	1/4"-7/16"	1/4"	--	100
2700185-LA	"Q" Span Clamp for P3 Cable w/Messenger	Plates - Aluminum Pigtail - Steel	<1/4"	1/4"	--	100

#### "O" Span Clamp



- Provides drop wire take offs at mid-span.
- Steel components mechanically galvanized ASTM B695.

Part Number	Description	Material	Clamp Range	PigTail Diameter	Inner Pack	Outer Pack
27-00860	"O" Span Clamp	Plates - Aluminum Pigtail - Steel	1/4"-3/8"	3/8"	--	50

#### "E" Span Clamp

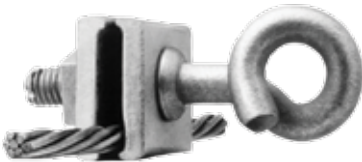

- Provides drop wire take offs at mid-span.
- Steel components mechanically galvanized ASTM B695.

Part Number	Description	Material	Clamp Range	PigTail Diameter	Inner Pack	Outer Pack
27-00865	"E" Span Clamp	Steel	1/4"-7/16"	3/8"	5	100

#### "C" Span Clamp



- Provides drop wire take offs at mid-span.
- Steel components mechanically galvanized ASTM B695.

Part Number	Description	Material	Clamp Range	PigTail Diameter	Inner Pack	Outer Pack
27-00869	"C" Span Clamp	Plates - Aluminum Hook - Steel	1/4"-3/8"	3/8"	--	50



## Diamond® Drop Hardware

### Span Clamps



#### Figure 8 Span Clamp



- Provides drop wire take offs at mid-span.
- Steel components mechanically galvanized ASTM B695.

Part Number	Description	Material	Clamp Range	PigTail Diameter	Inner Pack	Outer Pack
28-09800	Fig 8 (.109-.134")	Plates - Aluminum Hook - Steel	1/4"-7/16"	3/8"	--	50
28-09850	Fig 8 (.148-.250")	Plates - Aluminum Hook - Steel	1/4"-7/16"	3/8"	--	25

#### Econospan Span Clamp



- Multi directional clamp for messengered and non-messengered drop cable used for dead-end or mid-span application.
- Mechanically galvanized ASTM B695.

Part Number	Description	Inner Pack	Outer Pack
SC03E	Clamp will Accept 1/4" (6.6MM) Steel Strand	--	100

#### Multi-Directional Span Clamp

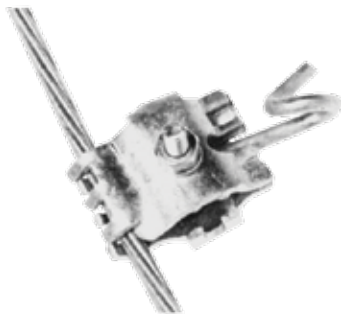

- Multi-directional span clamp used for drop cables at mid-span location.
- Unique claw design locks in between steel strand lays to prevent rotation.
- Mechanically galvanized ASTM B695.

Part Number	Description	Hook Load Capacity	Inner Pack	Outer Pack
SC03-1	Single Pigtail Hook for 1/4" Steel Strand	400 lbs.	--	100
SC03-2	Double Pigtail Hook for 1/4" Steel Strand	400 lbs.	--	75

## Diamond® Drop Hardware

### Clamps



#### One Hole Clamps



- Used to support cable, conduit or pipe.
- Mechanically galvanized steel ASTM B695.

Part Number	Description	Size	Pipe or Cable Size	Stock Size	Hole Diameter	Inner Pack	Outer Pack
24-80003	One Hole Clamp	L3	3/16"	.035" x 1/2"	7/32"	500	7,500
24-80004	One Hole Clamp	L4	1/4"	.035" x 1/2"	7/32"	500	5,000
24-80005	One Hole Clamp	L5	5/16"	.035" x 1/2"	7/32"	500	5,000
24-80006	One Hole Clamp	L6	3/8"	.048" x 1/2"	7/32"	500	5,000
24-80007	One Hole Clamp	L7	7/16"	.048" x 1/2"	7/32"	300	2,400
24-80008	One Hole Clamp	L8	1/2"	.048" x 1/2"	7/32"	--	500
24-80009	One Hole Clamp	L9	9/16"	.048" x 1/2"	7/32"	--	500
24-80010	One Hole Clamp	L10	5/8"	.048" x 1/2"	7/32"	--	500
24-80011	One Hole Clamp	L11	11/16"	.062" x 5/8"	9/32"	--	500
24-80012	One Hole Clamp	L12	3/4"	.062" x 11/16"	9/32"	--	500
24-80014	One Hole Clamp	L14	7/8"	.062" x 11/16"	9/32"	--	500
24-80016	One Hole Clamp	L16	1"	.080" x 3/4"	9/32"	--	250
24-80018	One Hole Clamp	L18	1-1/8"	.080" x 3/4"	9/32"	--	250
24-80020	One Hole Clamp	L20	1-1/4"	.115" x 7/8"	9/32"	--	100

#### One Hole Offset Clamps



- Used to secure telephone cable runs.
- Offset provides a grip on multi-size cable.
- Mechanically galvanized steel ASTM B695.

Part Number	Description	Cable Size	Stock Size	Hole Diameter	Inner Pack	Outer Pack
23-80403	One Hole Offset Clamp	5/32" - 7/32"	.048" x 5/16"	9/64"	500	5,000
23-80405	One Hole Offset Clamp	1/4" - 5/16"	.048" x 5/16"	9/64"	500	7,500
23-80406	One Hole Offset Clamp	5/16" - 3/8"	.048" x 1/2"	7/32"	500	5,000
23-80407	One Hole Offset Clamp	3/8" - 1/2"	.048" x 1/2"	7/32"	500	5,000



# Diamond® Drop Hardware

## Clamps



### Two Hole Clamps

- Used to support cable, conduit or pipe.
- Offset provides a grip on multi-size cable.
- Mechanically galvanized steel ASTM B695.



Part Number	Description	Size	Pipe or Cable Size	Stock Size	Hole Diameter	Inner Pack	Outer Pack
25-80070	Two Hole Clamp	#7	7/16"	.048" x 1/2"	13/64"	--	600
25-80100	Two Hole Clamp	#10	5/8"	.048" x 1/2"	7/32"	--	500
25-80110	Two Hole Clamp	#11	11/16"	.062" x 5/8"	9/32"	--	250
25-80120	Two Hole Clamp	#12	3/4"	.062" x 11/16"	9/32"	--	250
25-80140	Two Hole Clamp	#14	7/8"	.062" x 11/16"	9/32"	--	250
25-80160	Two Hole Clamp	#16	1"	.080" x 3/4"	9/32"	--	300
25-80180	Two Hole Clamp	#18	1-1/8"	.080" x 3/4"	9/32"	--	300
25-80200	Two Hole Clamp	#20	1-1/4"	1/8" x 7/8"	9/32"	--	100
25-80240	Two Hole Clamp	#24	1-1/2"	1/8" x 7/8"	9/32"	--	50
25-80260	Two Hole Clamp	#26	1-5/8"	1/8" x 7/8"	9/32"	--	50
25-80300	Two Hole Clamp	#30	1-7/8"	1/8" x 7/8"	9/32"	--	50
25-80360	Two Hole Clamp	#36	2-1/4"	1/8" x 1"	11/32"	--	75
25-80400	Two Hole Clamp	#40	2-1/2"	1/8" x 1"	11/32"	--	50
25-80420	Two Hole Clamp	#42	2-5/8"	1/8" x 1"	11/32"	--	50
25-80560	Two Hole Clamp	#56	3-1/2"	1/8" x 1"	11/32"	--	50



## Diamond® Drop Hardware Brackets

### Drop Wire Mast Bracket



- Mechanically galvanized steel ASTM B695.
- Mast capacity 2-1/2" to 3" diameter.

Part Number	Description	Inner Pack	Outer Pack
40-00540	Drop Wire Mast Bracket	--	50

### House Bracket



- Multi-dwelling drop cable bracket.
- Attach to building with drive screws or wood screws (1/4" dia.).
- Attach insulator in 7/16" dia. mounting hole.
- Mechanically galvanized steel ASTM B695.

Part Number	Description	Inner Pack	Outer Pack
40-00200	House Bracket 1-3/4" Wide x 3-1/2" High x 3" Horizontal Leg	--	50

### Corner Wall Bracket

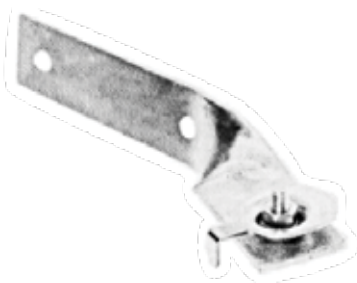

- Corner wall bracket used to dead-end a messenger drop cable or a steel strand at the building.
- Mechanically galvanized ASTM B695.

Part Number	Description	Inner Pack	Outer Pack
SC53-2	For Messengered Drop Cable with .051" to .072" Steel Messenger Wire	--	50





## Diamond® Drop Hardware Hooks



### Drop Wire Hook (Ram's Horn)



- Used to attach bail wire type drop wire clamp to building.
- Mechanically galvanized ASTMB695.

Part Number	Description	Inner Pack	Outer Pack
<b>30-01732</b>	Ram's Horn Type Drop Wire Hook	50	600

### "Omni" House Hook



- Omni house hook used to dead-end a messengered drop cable at the house.
- Retainer provides a 1" diameter wrap to messenger steel wire keeping the messenger intact for bonding at the ground block.
- Mechanically galvanized ASTM B695.

Part Number	Description	Inner Pack	Outer Pack
<b>SC26-1</b>	Omni Directional Signal Retainer	--	100
<b>SC26-1L</b>	Omni Directional Signal Retainer - Extra Long	--	100

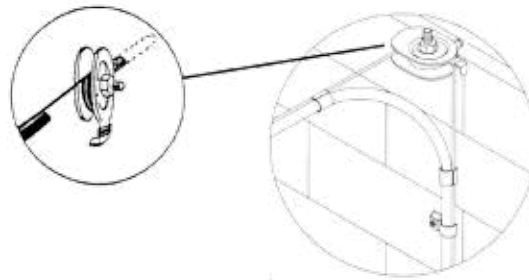

### "P" House Hook



- Used to secure coaxial cable drop installations at the building.
- Accepts bailwire dropwire clamps, wire grips or messenger wraps.
- Mechanically galvanized steel ASTM B695.

Part Number	Description	Overall Length (inches)	Screw Diameter (inches)	Inner Pack	Outer Pack
<b>31-00809</b>	Regular House Hook	3-3/4	1/4	--	200
<b>31-10809</b>	Long House Hook	4-1/2	1/4	--	200
<b>31-00800</b>	Wrench P House Hook	3-3/4	1/4	*	*
<b>31-00801</b>	Wrench P House Hook	4-1/2	1/4	*	*

\* ( Ask PPC/Belden Representative ).



## Diamond® Drop Hardware

Hooks, Rings, Screw Fixtures



### Dead End Strap



- Dead-end strap made of high quality G90 pre-galvanized steel used to dead-end a drop cable at the house service mast.

Part Number	Description	Inner Pack	Outer Pack
SC11-1	From 1" to 4" Diameter Mast	--	100

### Bridle Rings



- Used to support cable runs and electrical wiring.
- Mechanically galvanized ASTMB695.

Part Number	Description	Style	Eye Dia.	Thread Size	Max. Load	Inner Pack	Outer Pack
31-00810	Wood Screw Bridle Ring	A	1-5/8"	#14	75 lbs.	--	100
31-00812	Wood Screw Bridle Ring	C	1-1/4"	#14	75 lbs.	--	100
31-00819	Wood Screw Bridle Ring	G	7/8"	#10	50 lbs.	25	100
31-00821	Machine Screw Bridle Ring	K	3/4"	#10-24	50 lbs.	100	1,000
31-00823	Machine Screw Bridle Ring	M	1-1/4"	#10-24	50 lbs.	--	100
31-00824	Machine Screw Bridle Ring	P	1-3/4"	#10-24	50 lbs.	--	100
31-00825	Machine Screw Bridle Ring	Q	1-1/4"	1/4"-20	50 lbs.	--	100
31-00827	Machine Screw Bridle Ring	R	1-5/8"	#10-24	50 lbs.	--	100

### Angle Screw Fixture



- Used to attach bail wire type drop wire clamp to building.
- Mechanically galvanized ASTMB695.

Part Number	Description	Wood Screw Diameter	Shank Diameter Length	Machine Thread Length	Insulator Shank Length	Inner Pack	Outer Pack
33-00840	Angle Screw Fixture	5/16" (18)	9/32" x 2-1/4"	1"	1-1/2"	--	150
33-00841	Angle Screw Fixture	3/8"	3/8" x 2"	1-1/8"	2-1/2"	--	100



## Diamond® Drop Hardware

### Cable Clips



#### "S" Cable Clip - Telephone



- Used to secure telephone drip loop to "B" drop wire hook (Ram's horn).
- Ribs provide positive grip on drop wire.
- Aluminum "S" clip to be secured with lineman's pliers.

Part Number	Description	Maximum Cable Size	Inner Pack	Outer Pack
23-80261	2-3 Pair "S" Clip	.225" x .375"	25	500
23-80262	6 Pair "S" Clip	.300" x .500"	--	500
23-80366	1-2 Pair "S" Clip	.160" x .300"	25	500

#### "S" Cable Clip - Coaxial



- Used to prevent separation of two cables or a messenger steel wire from a drop cable.

Part Number	Description	Inner Pack	Outer Pack
SC10-1	Made of Soft Aluminum for Easy Finger Forming Accepts Up to Series 7 Cable	--	500

#### Dual Cable Clip



- Secures dual coaxial cable and telephone six pair cable runs.
- Mechanically galvanized steel ASTM B695.

Part Number	Description	Inner Pack	Outer Pack
22-12121	Dual Cable Clip - Series 6	500	5,000

## Diamond® Drop Hardware

### Cable Clips



#### "U" Cable Clip



- Pre-formed aluminum cable clip used to secure drop cables and ground wires to either wood or masonry surfaces using self-tapping screws.

Part Number	Description	Inner Pack	Outer Pack
<b>SC19-1</b>	"U" Cable Clip RG59- 6MM	500	10,000
<b>SC20-1</b>	"U" Cable Clip for Series 6 Cable -7MM	500	10,000
<b>SC20-D6</b>	"U" Cable Clip for Dual RG-6 Cable	400	8,000
<b>SC21-1</b>	"U" Cable Clip for #12AWG to #14AWG Ground Wire.	500	10,000
<b>SC21-2</b>	U" Cable Clip for #6AWG to #10AWG Ground Wire.	500	10,000
<b>SC22-1</b>	"U" Cable Clip RG11 - 10MM	400	8,000

#### Screw and Snap® Clips (Patented)

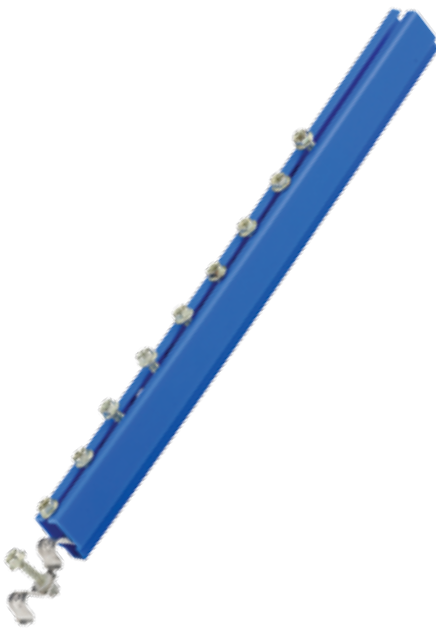

- Used to secure coaxial cable and ground wire runs to wood, masonry, stucco, brick or concrete.
- For concrete or brick drill .138" pilot hole. Screw will cut threads in hole.
- Convenient strips of ten clips snap off after installation.
- Cable size stamped on clips (aluminum).
- Screw hardened and treated for 500 hour salt spray resistance. ASTM B117.
- Plastic plugs secure screws to strip and prevent torquing.
- Handy holder included in every 30 strip carton.

Part Number	Description	Screw Size	Cable Size	Inner Pack	Outer Pack
<b>24-88013</b>	Screw & Snap Clips	#8 x 3/4"	Series 6	30	300
<b>24-88014</b>	Screw & Snap Clips	#8 x 3/4"	Series 59	30	300
<b>24-88016</b>	Screw & Snap Clips	#8 x 3/4"	10-14 AWG	30	300
<b>24-88017</b>	Screw & Snap Clips	#8 x 3/4"	Series 6Q	30	300
<b>24-88027</b>	Screw & Snap Clips	#8 x 3/4"	Series 11	30	300

\*Screw N Snap can be used to attach cable to wood, masonry and concrete when a .138" pilot hole is drilled and fitted with a Diamond Plastic Screw Anchor, Diamond part number, 12-08210.



## Diamond® Drop Hardware

### Cable Clips



#### SAXXIT® Cable Clips (Patented)



- “Galvalume” steel cable clip used on concrete, mortar, stucco or wood with a pre-inserted, self-tapping screw or a drive pin.

Part Number	Description	Inner Pack	Outer Pack
SC16-19	SAXXIT Cable Clip for 6mm Cable with No. 8 x 1" Screw 1/4" Hex Head Indented "Phillips"	250	5,000
SC16-26	SAXXIT Cable Clip for 7mm Cable with No. 8 x 1" Screw 1/4" Hex Head Indented "Phillips"	250	5,000
SC16-3Q	SAXXIT Cable Clip for 8mm Cable with No. 8 x 1" Screw 1/4" Hex Head Indented "Phillips"	250	5,000
SC16-411	SAXXIT Cable Clip for 10mm Cable with No. 8 x 1" Screw 1/4" Hex Head Indented "Phillips"	250	5,000
SC16DP-19	SAXXIT Cable Clip for 6mm Cable with 1" Drive Pin	250	5,000
SC16DP-26	SAXXIT Cable Clip for 7mm Cable with 1" Drive Pin	250	5,000
SC16DP-3Q	SAXXIT Cable Clip for 8mm Cable with 1" Drive Pin	250	5,000



#### SAXXON® Cable Clips

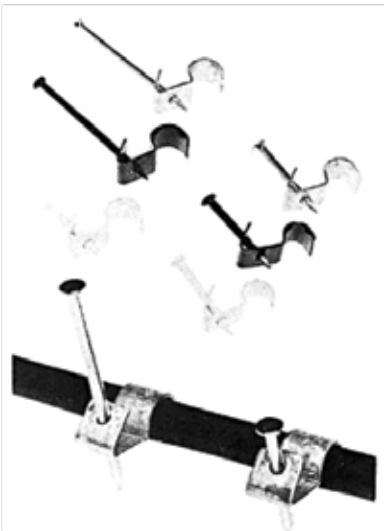

- “Galvalume” steel cable clip used on wood, stucco or mortar with a 1” hardened pre-inserted nail.

Part Number	Description	Inner Pack	Outer Pack
SC18-19	SAXXON Cable Clip for 6mm Cable	500	10,000
SC18-26	SAXXON Cable Clip for 7mm Cable	500	10,000
SC18-3Q	SAXXON Cable Clip for 8mm Cable	500	10,000
SC18L-26	SAXXON Cable Clip for 7mm Cable with 1.625" Hardened Nail	300	3,600
SC18P-26BLACK	SAXXON Cable Clip for 7mm Cable, Painted Black	500	10,000
SC18P-26WHITE	SAXXON Cable Clip for 7mm Cable, Painted White	500	10,000

## Diamond® Drop Hardware

Cable Clips, Cable Clamps,



### Siding Clips

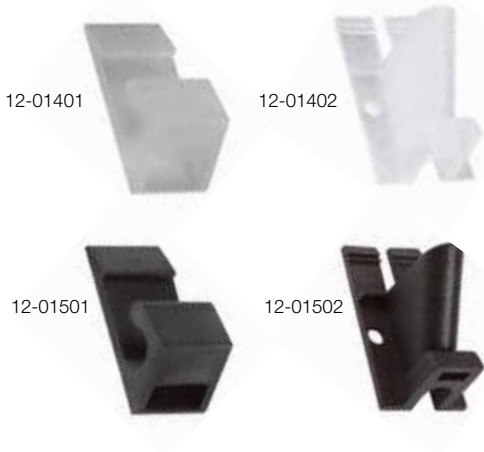

- Secures coaxial cable runs to aluminum, vinyl or steel siding.
- High density UV stabilized outdoor polypropylene.
- Available in natural (clear) or black.

Part Number	Description	Inner Pack	Outer Pack
<b>12-01401</b>	Horizontal Siding Clip - Natural	100	1,000
<b>12-01402</b>	Vertical Siding Clip - Natural	100	1,000
<b>12-01501</b>	Horizontal Siding Clip - Black	100	1,000
<b>12-01502</b>	Vertical Siding Clip - Black	100	1,000

### "E" Drop Wire Clamp



- Used to secure telephone drop wire cable runs.
- Mechanically galvanized ASTM B695.
- Transverse ribs grip cable to prevent abrasion.

Part Number	Description	Inner Pack	Outer Pack
<b>23-80361</b>	"E" Drop Wire Clamp, One Pair, Steel	50	2,000
<b>23-80363</b>	"E" Drop Wire Clamp, One Pair, Steel, Box of 50	1	40
<b>23-80370</b>	"E" Drop Wire Clamp, Two Pair, Steel	50	2,000
<b>23-83361</b>	"E" Drop Wire Clamp, Six Pair, Steel	50	2,000
<b>40-80365</b>	"E" Drop Wire Clamp, Coax, Aluminum	--	500



## Diamond® Drop Hardware

Cable Ties, Cable Bushings



### Cable Ties - Aluminum

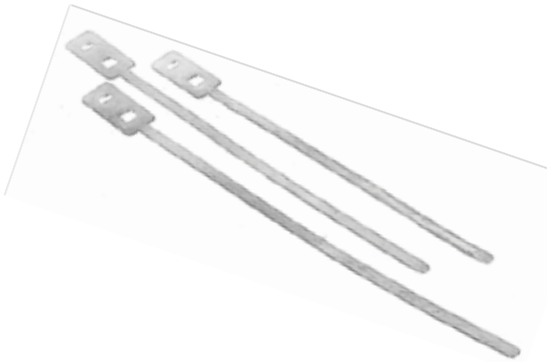

- Reusable strap with integral buckle made of malleable aluminum, corrosion resistant, used to support drop cables on the strand, pedestal, lock box and along the wall.
- No sharp edges to cut hands or damage cable.

Part Number	Description	Inner Pack	Outer Pack
SC053-1	7" Long, 1/4" Band - Reusable Aluminum Tie	400	8,000
SC053-2	10" Long, 1/4" Band - Reusable Aluminum Tie	100	1,500
SC28-1*	ID Tag, 3-1/4" long, plain for scribe on	400	8,000
SC28-2	ID Tag, 3-1/4" long with random 6 digit number	400	8,000
SC28-3	ID Tag, 3-1/4" long, with pre-stamped 4 letters and 2 banks of numbers from 0-9	400	8,000
SC28-4	ID Tag, 7" long, plain to scribe on	--	200
SC28-4SCATV	ID Tag, 7" long, pre-stamped CATV	--	200
SC28-5	ID Tag, 10" long, plain for scribe on	--	500
SC28-6	ID Tag, 16" long, plain for scribe on	--	500
SC28-8	Id Tag, 3-1/4" long with single large digit number or letter	400	800
SC28-GT	Id Tag, 2-1/2" X 1-1/4" grounding tag with warning message. Optional cable system name and telephone number	400	800

\* Different colors available: Green, Red, Yellow

### Feed Thru Bushing



- Protects coaxial cable entry into subscriber's building.
- Available in black or natural (clear).
- High density UV stabilized outdoor polypropylene.

Part Number	Description	Color	Cable Size	Inner Pack	Outer Pack
34-08052	Feed Thru Bushing	Black	Series 6, 6Q	100	1,000
34-08053	Feed Thru Bushing	Natural	Series 6, 6Q	100	1,000
34-08057	Feed Thru Bushing - Dual RG6	Black	Series 6, 6Q	100	1,000
34-08058	Feed Thru Bushing - Dual RG6	Natural	Series 6, 6Q	100	1,000
34-08059	Feed Thru Bushing - 15° Angle	Black	Series 6, 6Q	100	1,000
34-08060	Feed Thru Bushing - 15° Angle	Natural	Series 6, 6Q	100	1,000

## Diamond® Drop Hardware

### Drive Rings, Wire Loops



#### Drive Rings



- Used to support cable runs and electrical wiring.
- Mechanically galvanized steel ASTM B695.

Part Number	Description	Eye Size	Nail Length (in)	Maximum Load (lbs)	Inner Pack	Outer Pack
30-00801	Drive Ring	1/2"	2.062	50	50	2,500
30-00804	Drive Ring	5/8"	2.250	75	25	1,000
30-00805	Drive Ring	7/8"	2.563	100	25	500
30-00807	Drive Ring	1-1/4"	2.938	125	20	120
30-01801*	Drive Ring - Long	1/2"	2.438	50	50	2,500
30-01804*	Drive Ring - Long	5/8"	2.750	75	25	1,000
30-01805*	Drive Ring - Long	7/8"	3.062	100	25	500
30-01807*	Drive Ring - Long	1-1/4"	3.438	125	25	250

\* These sizes have longer nails for greater carrying capacity

#### Drive Rings



- Drive ring used for guiding cables.
- May be used at the pole or at the house.
- Double crimped loop on concrete nail facilitates installation.
- Mechanically galvanized ASTM B695.

Part Number	Description	Inner Pack	Outer Pack
SC17-1	5/8" Ring with 2-1/4" Concrete Nail	--	250
SC17-2	1-1/4" Ring with 2-1/2" Concrete Nail	--	200

#### Wire Loops and Wire Loop Drive Pins



- Used to attach drop wire runs to masonry with wire loop drive pins.
- Wire loops mechanically galvanized steel ASTM B695.
- Wire loop drive pins zinc plated steel ASTM B633.

Part Number	Description	Inner Pack	Outer Pack
15-00120	Wire Loop 1/2"	100	1,000
15-00121	Wire Loop 5/8"	100	1,500
15-00122	Wire Loop 7/8"	70	560
15-00123	Wire Loop 1-1/4"	100	1,000
15-10101	Wire Loop Drive Pin, 1-1/2" Long	100	1,500
15-10102	Wire Loop Drive Pin, 1-3/4" Long	100	1,500





## Diamond® Drop Hardware

Drive Pins, Drive Tools



### Drive Pins



- Used to secure clamps to masonry surface.
- Zinc plated steel ASTM B633.

Part Number	Description	Inner Pack	Outer Pack
15-10041	Drive Pin - 1/4" Head x 3/4" Long, Metal Washer	100	1,500
15-10042	Drive Pin - 1/4" Head x 1" Long, Metal Washer	100	1,500
15-10043	Drive Pin - 1/4" Head x 1-1/4" Long, Metal Washer	100	1,500
15-10044	Drive Pin - 1/4" Head x 1-1/2" Long, Metal Washer	100	1,500

WARNING: Do not use powder actuated tools