

# EAO – Your Expert Partner for Human Machine Interfaces

## 704.927.9 - E-stop protective shroud

### 704.927.9 - E-stop protective shroud



*Attention: The preview is based on a sample product. This can differ from your current configuration.*

#### Mounting

Design raised

#### Other Attributes

Material Plastic  
Colour yellow  
Dimension Ø 83 mm  
Standard SEMI S2-93/12.4.c  
Weight 0,067 kg

#### IP-Rating

Front protection IP65

# EAO – Your Expert Partner for Human Machine Interfaces

704.927.9 - E-stop protective shroud

## Dimensions

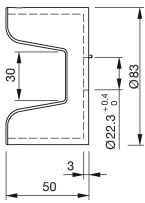

## Additional information

Use only for Part No. 704.064.2 und 704.066.2

The protection shroud is not suitable for a proper use of emergency-stop. It can obstruct a spontaneous operation of the emergency-stop

SEMI S2-93/12.4.c