

RJ45 socket insert - VS-08-BU-RJ45-10G/LH-1 - 1420401

Please be informed that the data shown in this PDF Document is generated from our Online Catalog. Please find the complete data in the user's documentation. Our General Terms of Use for Downloads are valid (<http://phoenixcontact.com/download>)



RJ45 socket insert, for PCB assembly, CAT6_A, 8-pos., shielded, with angled solder pins, 1x



Key Commercial Data

| | |
|--------------------------------------|--------------------------------|
| Packing unit | 1 STK |
| GTIN | |
| GTIN | 4046356547895 |
| Weight per Piece (excluding packing) | 4.840 g |
| Custom tariff number | 85366990 |
| Country of origin | Germany |
| Note | Made to Order (non-returnable) |

Technical data

Mechanical characteristics

| | |
|----------------------|--------|
| Number of positions | 8 |
| Number of slots | 1 |
| Connection profile | RJ45 |
| Degree of protection | IP20 |
| Design | Angled |

Electrical characteristics

| | |
|---|-------------------|
| Number of positions | 8 |
| Transmission characteristics (category) | CAT6 _A |

Environmental Product Compliance

| | |
|------------|---|
| China RoHS | Environmentally Friendly Use Period = 50 |
| | For details about hazardous substances go to tab "Downloads", Category "Manufacturer's declaration" |

RJ45 socket insert - VS-08-BU-RJ45-10G/LH-1 - 1420401

Drawings

Dimensional drawing

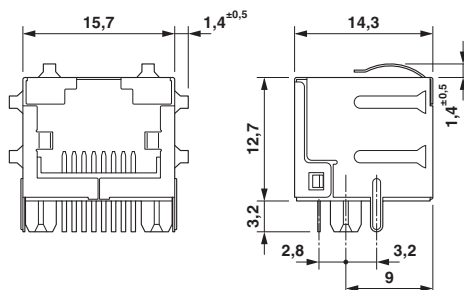

RJ45 socket insert

Classifications

eCl@ss

| | |
|------------|----------|
| eCl@ss 4.0 | 27140816 |
| eCl@ss 4.1 | 27260701 |
| eCl@ss 5.0 | 27260701 |
| eCl@ss 5.1 | 27260701 |
| eCl@ss 6.0 | 27260705 |
| eCl@ss 7.0 | 27440309 |
| eCl@ss 8.0 | 27440205 |
| eCl@ss 9.0 | 27440205 |

ETIM

| | |
|----------|----------|
| ETIM 4.0 | EC002638 |
| ETIM 5.0 | EC000438 |
| ETIM 6.0 | EC000438 |

UNSPSC

| | |
|---------------|----------|
| UNSPSC 6.01 | 30211923 |
| UNSPSC 7.0901 | 39121522 |
| UNSPSC 11 | 39121522 |
| UNSPSC 12.01 | 39121522 |
| UNSPSC 13.2 | 39121522 |

Approvals

Approvals

Approvals

EAC

RJ45 socket insert - VS-08-BU-RJ45-10G/LH-1 - 1420401

Approvals

Ex Approvals

Approval details

| | | |
|-----|---|---------|
| EAC |  | B.01742 |
|-----|---|---------|
