

SPEEDY RJ45 Contractor grade Crimp Tool



SPEEDY RJ45 Contractor grade Crimp Tool (TRCSPDY4)

Our Contractor Grade ratchet crimp tool is designed for professional installers using **SPEEDY** RJ45 and similar feedthrough plugs. This high quality tool offers excellent value and has been specially designed to ensure that **SPEEDY** RJ45 terminations are not only faster than using conventional plugs but also consistent, reliable and repeatable.

Features

- Crimps **SPEEDY** RJ45 Category 5, 6 and 6A 8p8c plugs
- Crimps and trims surplus wires in a single operation, with a neat, flush finish
- Releasable ratchet action ensures consistent crimps
- Built in cutter and stripper caters for both flat and round cables
- Dual-colour grips enhance comfort and consistent terminations
- ALSO - crimps standard 8p8c (RJ45) Category 5 and 6 plugs

Note: It is recommended that the blade for trimming the surplus wires is replaced after 500 uses – see details of blades below

Specifications

- Materials
 - Tool body: heat-treated carbon steel
 - Blades: tool steel
 - Handles: thermoplastic rubber and polypropylene
- Colour: red/black
- Weight: 330g approx

Packaging

- Supplied in individual white box then in carton of 20



Replacement Blades (TBSPDY4)

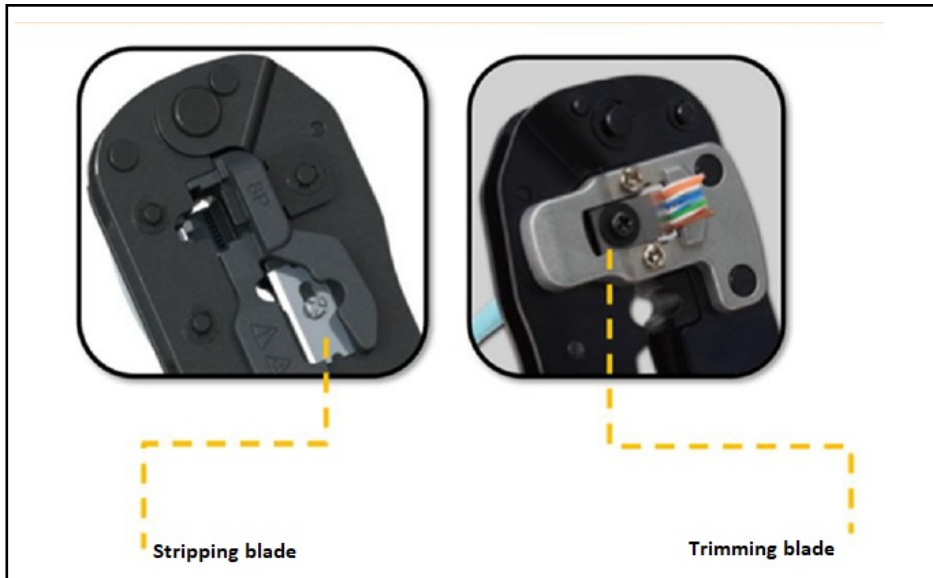

Supplied as a set of two blades, one for cutting and stripping cable and one for trimming-off surplus cores, this replacement blade kit ensures that crimping performance levels are maintained throughout the life of the **SPEEDY** RJ45 crimp tool. Note: It is recommended that the trimming blade is renewed after every 500 terminations

Features

- High performance trimming blade guarantees a flush wire trim of surplus conductors.
- Cutting and stripping blade enables convenient terminations without need for additional tooling.

Specifications

- Material: tool steel

Packaging

- Supplied in a set of 2 blades, then in packs of 10

EAN Number: 5055386509321

County of origin: Taiwan



SPEEDY RJ45

ROHS Compliant

Code: TRCSPDY4

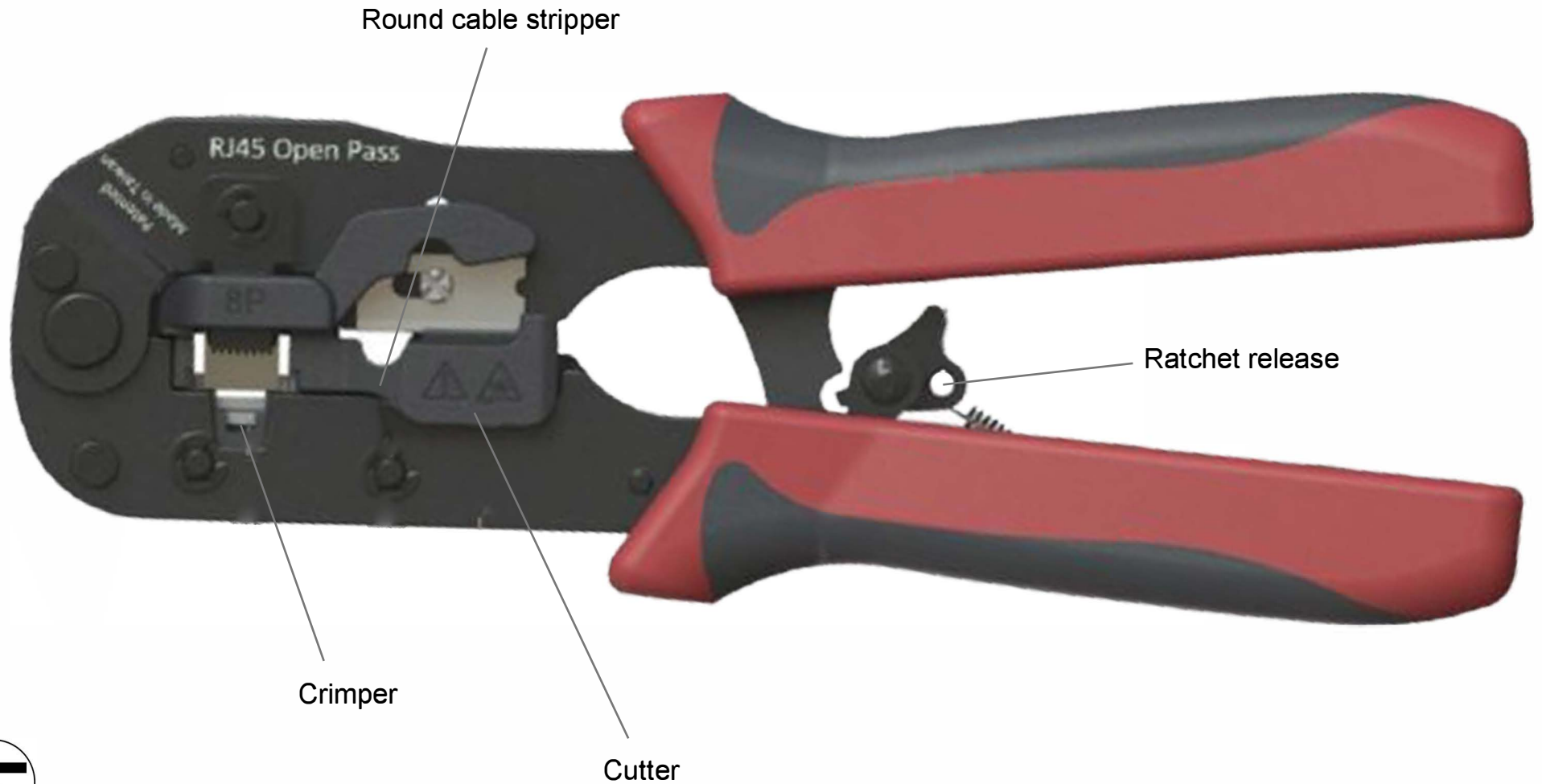

06/07/2021