

Subminiatursteckverbinder Serie 620 Subminiature connectors series 620

Bezeichnung
Description

Flanschstecker
Male socket

Flanschdose
Female socket

Abbildung
Figure



Maßzeichnung
Drawing

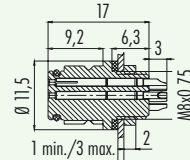
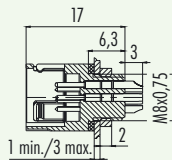

Bestell-Nr.
Ordering-No.

Polzahl Contacts	Bestell-Nr. Ordering-No.	Polzahl Contacts	Bestell-Nr. Ordering-No.
3	99-9207-00-03	3	99-9208-00-03
4	99-9211-00-04	4	99-9212-00-04
5	99-9215-00-05	5	99-9216-00-05
8	99-9227-00-08	8	99-9228-00-08

Technische Daten
Specifications

Polzahl	3	4	5	8	Number of contacts
Steckverbinder Verriegelung	schnapp/snap-in				Connector locking system
Anschlussart	löten/solder				Termination
Anschlussquerschnitt	max. 0,25 mm ² (max. AWG 24)				Wire gauge
Kabeldurchlass	3-5 mm				Cable outlet
Schutzart	IP67				Degree of protection
Mechanische Lebensdauer	> 500 Steckzyklen/> 500 mating cycles				Mechanical operation
Obere Grenztemperatur	+ 85 °C				Upper temperature
Untere Grenztemperatur	- 25 °C				Lower temperature
Bemessungsspannung	125 V			63 V	Rated voltage
Bemessungsstoßspannung	1500 V			800 V	Rated impulse voltage
Verschmutzungsgrad	2				Pollution degree
Überspannungskategorie	II				Overvoltage categorie
Isolierstoffgruppe	II				Material group
Bemessungsstrom (40°C)	3 A	2,5 A	2 A	1 A	Rated current (40 °C)
Durchgangswiderstand	≤ 3 mΩ				Contact resistance
Material Kontakt	Stift/pin CuZn (Messing/brass), Buchse/socket CuSn (Bronze/bronze)				Material at contact
Kontaktoberfläche	Au (Gold/gold)				Contact plating
Material Kontaktkörper	PA (UL 94 V-0)				Material of contact body
Material Gehäuse	PA (UL 94 V-0)				Material of housing

Subminiatursteckverbinder Serie 620
Subminiature connectors series 620

Einzelteildarstellung
 Component part drawing

Kabelsteckverbinder
 Cable connectors

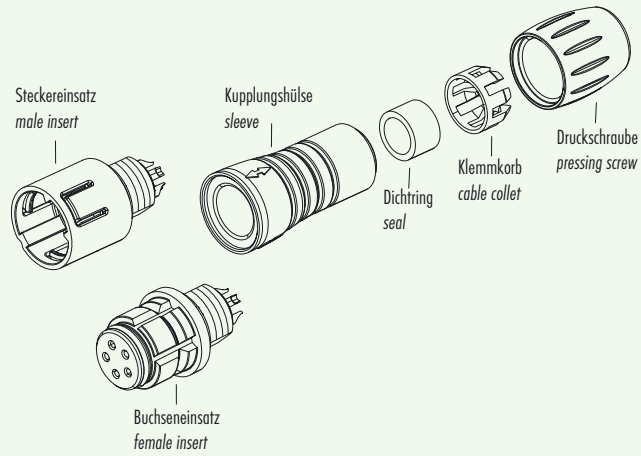

Flanschsteckverbinder
 Socket connectors

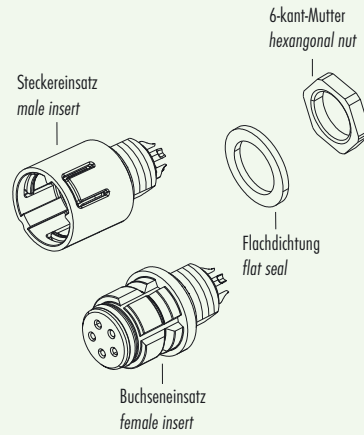

Adapter
 Adapter

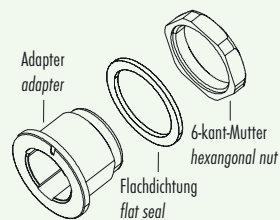

Adapter, von vorn verschraubt
 Adapter, front fastened

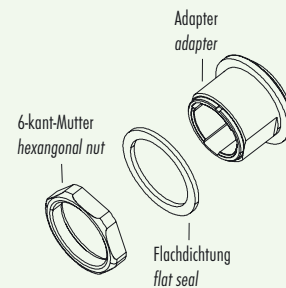

Subminiatursteckverbinder Serie 620 Subminiature connectors series 620

Polbilder
Contact arrangements

Stifteinsatz (Steckseite)
Male insert (mating side)

Buchseinsatz (Steckseite)
Female insert (mating side)

3 pol
3 contacts

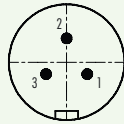

	X	Y
1	1,82	-1,05
2	0,00	2,10
3	-1,82	-1,05

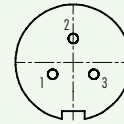

	X	Y
1	-1,82	-1,05
2	0,00	2,10
3	1,82	-1,05

4 pol
4 contacts

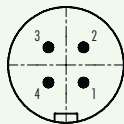

	X	Y
1	1,55	-1,55
2	1,55	1,55
3	-1,55	1,55
4	-1,55	-1,55

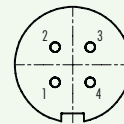

	X	Y
1	-1,55	-1,55
2	-1,55	1,55
3	1,55	1,55
4	1,55	-1,55

5 pol
5 contacts

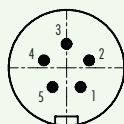

	X	Y
1	1,23	-1,70
2	2,00	0,65
3	0,00	2,10
4	-2,00	0,65
5	-1,23	-1,70

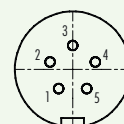

	X	Y
1	-1,23	-1,70
2	-2,00	0,65
3	0,00	2,10
4	2,00	0,65
5	1,23	-1,70

8 pol
8 contacts

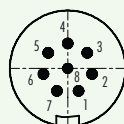

	X	Y
1	0,96	-1,98
2	2,15	-0,49
3	1,72	1,37
4	0,00	2,20
5	-1,72	1,37
6	-2,15	-0,49
7	-0,96	-1,98
8	0,00	0,00

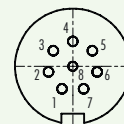

	X	Y
1	-0,96	-1,98
2	-2,15	-0,49
3	-1,72	1,37
4	0,00	2,20
5	1,72	1,37
6	2,15	-0,49
7	0,96	-1,98
8	0,00	0,00

Montageausschnitt
Panel cut out

Flanschsteckverbinder
Socket connectors

Adapter
Adapter

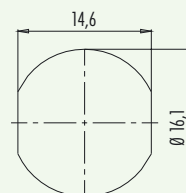
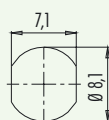

Subminiatursteckverbinder Serie 620
Subminiature connectors series 620

Bezeichnung
Description

Adapter für Flanschsteckverbinder
Adapter for sockets

Adapter für Flanschsteckverbinder,
von vorn verschraubt
Adapter for sockets,
front fastened

Abbildung
Figure



Maßzeichnung
Drawing

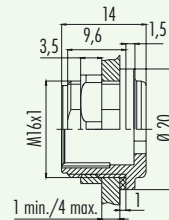
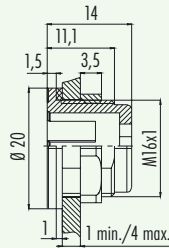

Bestell-Nr.
Ordering-No.

Bestell-Nr.
Ordering-No.

08-2636-000-001

Bestell-Nr.
Ordering-No.

08-2629-000-001

Technische Daten
Specifications

Polzahl	-	Number of contacts
Steckverbinder Verriegelung	-	Connector locking system
Anschlussart	-	Termination
Anschlussquerschnitt	-	Wire gauge
Kabeldurchlass	-	Cable outlet
Schutzart	-	Degree of protection
Mechanische Lebensdauer	-	Mechanical operation
Obere Grenztemperatur	-	Upper temperature
Untere Grenztemperatur	-	Lower temperature
Bemessungsspannung	-	Rated voltage
Bemessungsstoßspannung	-	Rated impulse voltage
Verschmutzungsgrad	-	Pollution degree
Überspannungskategorie	-	Overvoltage categorie
Isolierstoffgruppe	-	Material group
Bemessungsstrom (40°C)	-	Rated current (40 °C)
Durchgangswiderstand	-	Contact resistance
Material Kontakt	-	Material of contact
Kontaktoberfläche	-	Contact plating
Material Kontaktkörper	-	Material of contact body
Material Gehäuse	-	Material of housing