

COMBINATION D-SUB – MONTAGEARTEN

Lötstift – gewinkelt – 9,4 mm – gedrehte Kontakte – Metallwinkel

BESTELLDATEN

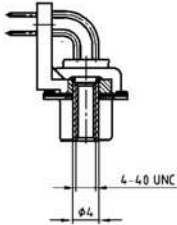

BUCHSENLEISTE		
Bauform	Montageart	Bestellnummer
5W1	Bolzen 4-40 UNC	3005W1SAU99H20X
7W2	Bolzen 4-40 UNC	3007W2SAU99H20X
11W1	Bolzen 4-40 UNC	3011W1SAU99H20X
9W4	Bolzen 4-40 UNC	3009W4SAU99H20X
13W3	Bolzen 4-40 UNC	3013W3SAU99H20X
17W2	Bolzen 4-40 UNC	3017W2SAU99H20X
21W1	Bolzen 4-40 UNC	3021W1SAU99H20X
13W6	Bolzen 4-40 UNC	3013W6SAU99H20X
17W5	Bolzen 4-40 UNC	3017W5SAU99H20X
21WA4	Bolzen 4-40 UNC	321WA4SAU99H20X
25W3	Bolzen 4-40 UNC	3025W3SAU99H20X
27W2	Bolzen 4-40 UNC	3027W2SAU99H20X
24W7	Bolzen 4-40 UNC	3024W7SAU99H20X
36W4	Bolzen 4-40 UNC	3036W4SAU99H20X
43W2	Bolzen 4-40 UNC	3043W2SAU99H20X
47W1	Bolzen 4-40 UNC	3047W1SAU99H20X

STIFBLEISTE		
Bauform	Montageart	Bestellnummer
5W1	Bolzen 4-40 UNC	3005W1PAU99H20X
7W2	Bolzen 4-40 UNC	3007W2PAU99H20X
11W1	Bolzen 4-40 UNC	3011W1PAU99H20X
9W4	Bolzen 4-40 UNC	3009W4PAU99H20X
13W3	Bolzen 4-40 UNC	3013W3PAU99H20X
17W2	Bolzen 4-40 UNC	3017W2PAU99H20X
21W1	Bolzen 4-40 UNC	3021W1PAU99H20X
13W6	Bolzen 4-40 UNC	3013W6PAU99H20X
17W5	Bolzen 4-40 UNC	3017W5PAU99H20X
21WA4	Bolzen 4-40 UNC	321WA4PAU99H20X
25W3	Bolzen 4-40 UNC	3025W3PAU99H20X
27W2	Bolzen 4-40 UNC	3027W2PAU99H20X
24W7	Bolzen 4-40 UNC	3024W7PAU99H20X
36W4	Bolzen 4-40 UNC	3036W4PAU99H20X
43W2	Bolzen 4-40 UNC	3043W2PAU99H20X
47W1	Bolzen 4-40 UNC	3047W1PAU99H20X

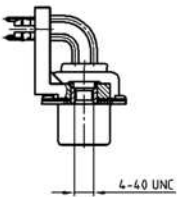

BUCHSENLEISTE		
Bauform	Montageart	Bestellnummer
5W1	Masseclip, Innengewinde 4-40 UNC	3005W1SAU99G40X
7W2	Masseclip, Innengewinde 4-40 UNC	3007W2SAU99G40X
11W1	Masseclip, Innengewinde 4-40 UNC	3011W1SAU99G40X
9W4	Masseclip, Innengewinde 4-40 UNC	3009W4SAU99G40X
13W3	Masseclip, Innengewinde 4-40 UNC	3013W3SAU99G40X
17W2	Masseclip, Innengewinde 4-40 UNC	3017W2SAU99G40X
21W1	Masseclip, Innengewinde 4-40 UNC	3021W1SAU99G40X
13W6	Masseclip, Innengewinde 4-40 UNC	3013W6SAU99G40X
17W5	Masseclip, Innengewinde 4-40 UNC	3017W5SAU99G40X
21WA4	Masseclip, Innengewinde 4-40 UNC	321WA4SAU99G40X
25W3	Masseclip, Innengewinde 4-40 UNC	3025W3SAU99G40X
27W2	Masseclip, Innengewinde 4-40 UNC	3027W2SAU99G40X
24W7	Masseclip, Innengewinde 4-40 UNC	3024W7SAU99G40X
36W4	Masseclip, Innengewinde 4-40 UNC	3036W4SAU99G40X
43W2	Masseclip, Innengewinde 4-40 UNC	3043W2SAU99G40X
47W1	Masseclip, Innengewinde 4-40 UNC	3047W1SAU99G40X

STIFBLEISTE		
Bauform	Montageart	Bestellnummer
5W1	Masseclip, Innengewinde 4-40 UNC	3005W1PAU99G40X
7W2	Masseclip, Innengewinde 4-40 UNC	3007W2PAU99G40X
11W1	Masseclip, Innengewinde 4-40 UNC	3011W1PAU99G40X
9W4	Masseclip, Innengewinde 4-40 UNC	3009W4PAU99G40X
13W3	Masseclip, Innengewinde 4-40 UNC	3013W3PAU99G40X
17W2	Masseclip, Innengewinde 4-40 UNC	3017W2PAU99G40X
21W1	Masseclip, Innengewinde 4-40 UNC	3021W1PAU99G40X
13W6	Masseclip, Innengewinde 4-40 UNC	3013W6PAU99G40X
17W5	Masseclip, Innengewinde 4-40 UNC	3017W5PAU99G40X
21WA4	Masseclip, Innengewinde 4-40 UNC	321WA4PAU99G40X
25W3	Masseclip, Innengewinde 4-40 UNC	3025W3PAU99G40X
27W2	Masseclip, Innengewinde 4-40 UNC	3027W2PAU99G40X
24W7	Masseclip, Innengewinde 4-40 UNC	3024W7PAU99G40X
36W4	Masseclip, Innengewinde 4-40 UNC	3036W4PAU99G40X
43W2	Masseclip, Innengewinde 4-40 UNC	3043W2PAU99G40X
47W1	Masseclip, Innengewinde 4-40 UNC	3047W1PAU99G40X

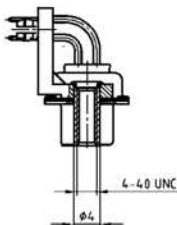

BUCHSENLEISTE		
Bauform	Montageart	Bestellnummer
5W1	Masseclip, Bolzen 4-40 UNC	3005W1SAU99H40X
7W2	Masseclip, Bolzen 4-40 UNC	3007W2SAU99H40X
11W1	Masseclip, Bolzen 4-40 UNC	3011W1SAU99H40X
9W4	Masseclip, Bolzen 4-40 UNC	3009W4SAU99H40X
13W3	Masseclip, Bolzen 4-40 UNC	3013W3SAU99H40X
17W2	Masseclip, Bolzen 4-40 UNC	3017W2SAU99H40X
21W1	Masseclip, Bolzen 4-40 UNC	3021W1SAU99H40X
13W6	Masseclip, Bolzen 4-40 UNC	3013W6SAU99H40X
17W5	Masseclip, Bolzen 4-40 UNC	3017W5SAU99H40X
21WA4	Masseclip, Bolzen 4-40 UNC	321WA4SAU99H40X
25W3	Masseclip, Bolzen 4-40 UNC	3025W3SAU99H40X
27W2	Masseclip, Bolzen 4-40 UNC	3027W2SAU99H40X
24W7	Masseclip, Bolzen 4-40 UNC	3024W7SAU99H40X
36W4	Masseclip, Bolzen 4-40 UNC	3036W4SAU99H40X
43W2	Masseclip, Bolzen 4-40 UNC	3043W2SAU99H40X
47W1	Masseclip, Bolzen 4-40 UNC	3047W1SAU99H40X

STIFBLEISTE		
Bauform	Montageart	Bestellnummer
5W1	Masseclip, Bolzen 4-40 UNC	3005W1PAU99H40X
7W2	Masseclip, Bolzen 4-40 UNC	3007W2PAU99H40X
11W1	Masseclip, Bolzen 4-40 UNC	3011W1PAU99H40X
9W4	Masseclip, Bolzen 4-40 UNC	3009W4PAU99H40X
13W3	Masseclip, Bolzen 4-40 UNC	3013W3PAU99H40X
17W2	Masseclip, Bolzen 4-40 UNC	3017W2PAU99H40X
21W1	Masseclip, Bolzen 4-40 UNC	3021W1PAU99H40X
13W6	Masseclip, Bolzen 4-40 UNC	3013W6PAU99H40X
17W5	Masseclip, Bolzen 4-40 UNC	3017W5PAU99H40X
21WA4	Masseclip, Bolzen 4-40 UNC	321WA4PAU99H40X
25W3	Masseclip, Bolzen 4-40 UNC	3025W3PAU99H40X
27W2	Masseclip, Bolzen 4-40 UNC	3027W2PAU99H40X
24W7	Masseclip, Bolzen 4-40 UNC	3024W7PAU99H40X
36W4	Masseclip, Bolzen 4-40 UNC	3036W4PAU99H40X
43W2	Masseclip, Bolzen 4-40 UNC	3043W2PAU99H40X
47W1	Masseclip, Bolzen 4-40 UNC	3047W1PAU99H40X

Masseclip (Snap In) für Lochdurchmesser 3,1 ± 0,10 mm und Leiterplattenstärke 1,6 mm