

# XCELL XP 7-12

## 12V 7AH (20 HOUR)



### XP 7-12



### Physical Specification

Part Number:	XP7-12
Length:	151 ± 3 mm
Width:	65 ± 2 mm
Container Height:	94 ± 2 mm
Total Height (with terminal):	99.5 ± 2 mm
Approx Weight:	Approx 2.2 kg

### Specifications

	Normal Voltage	12V
	Normal Capacity (20HR)	7AH
Terminal Type	Standard Terminal	F1
	Optional Terminal	F2
Container Material	Standard Option	ABS
	Flame Retardant Option (FR)	ABS (UL94:VO)
Rated Capacity	7.00 AH/0.350A	(20hr, 1.80V/cell, 25°C / 77°F)
	6.51 AH/0.651A	(10hr, 1.80V/cell, 25°C / 77°F)
	5.95 AH/1.19A	(5hr, 1.75V/cell, 25°C / 77°F)
	5.22 AH/1.74A	(3hr, 1.75V/cell, 25°C / 77°F)
	4.37 AH/4.37A	(1hr, 1.60V/cell, 25°C / 77°F)
Max Discharge Current	105A (5s)	
Internal Resistance	Approx 23mΩ	
Discharge Characteristics	Operating Temp. Range	Discharge: -15 ~ 50°C (5 ~ 122°F) Charge: -15 ~ 50°C (5 ~ 122°F) Storage: -15 ~ 40°C (5 ~ 104°F)
	Nominal Operating Temp. Range	25 ± 3°C (77 ± 5°F)
	Cycle Use	Initial Charging Current less than 21.A.Voltage 14.4V ~ 15.0V at 25°C (77°F) Temp. Coefficient -30mV/°C
	Standby Use	No limit on Initial Charging Current Voltage 13.5V ~ 13.8V at 25°C (77°F) Temp. Coefficient -20mV/°C
	Capacity affected by Temperature	40°C (104°F) 103% 25°C (77°F) 100% 0°C (32°F) 86%
Design Floating Life at 20°C	5 Years	
Self Discharge	XCELL batteries may be stored for up to 6 months at 25°C(°77F) and then a refresh charge is required. For higher temperatures the time interval will be shorter.	

### Dimensions

#### F1 Terminal

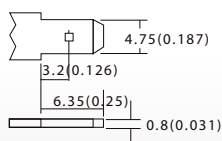

#### F2 Terminal

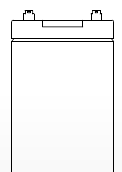
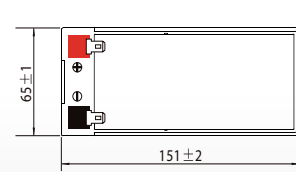
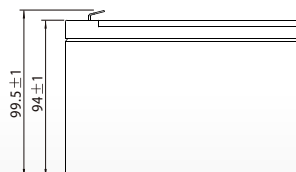
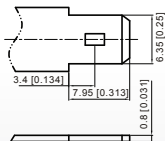

G 114098

