

### For installing wiring ducts into fixing holes

#### HelaDuct HTWD-R4 and HTWD-R6 Rivets

HTWD-R4 and HTWD-R6 are used to rapidly mount and secure wiring ducts into fixing holes without the use of screws.

#### Features and benefits

- Very good mechanical properties
- Good resistance to vibration
- Easily and rapidly applied with HTWD-RT4 and HTWD-RT6 rivet tools
- Colour-coded for easy identification for use with rivet tools

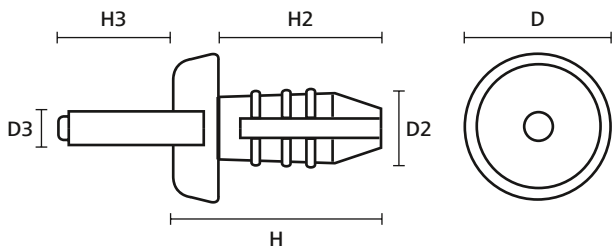

HTWD-R4, -R6



HTWD-R4 and HTWD-R6 Rivet.

<b>MATERIAL</b>	Polyamide 6 (PA6)
<b>Operating Temperature</b>	-40 °C to +80 °C
<b>Flammability</b>	UL94 V2



TYPE	Height (H)	Height (H2)	Height (H3)	Ø (D)	Ø (D2)	Ø (D3)	Colour	Pack Cont.	Article-No.
HTWD-R4	14.0	12.0	11.5	9.0	5.0	4.0	Blue (BU)	1,000 pcs.	181-42400
HTWD-R6	16.0	12.7	13.0	11	6.0	3.0	Black (BK)	250 pcs.	181-42600
	16.0	14.0	13.5	11	7.5	6.0	Orange (OG)	500 pcs.	181-42500

All dimensions in mm. Subject to technical changes.  
Minimum Order Quantity (MOQ) may differ from package content.

### For inserting R4 and R6 rivets

#### HelaDuct HTWD-RT4 and HTWD-RT6 Rivet Tools

HelaDuct HTWD-RT4 and HTWD-RT6 tools are used to insert HTWD-R4 and HTWD-R6 rivets into fixing holes and thus mounting ducts without the use of screws.

#### Features and benefits

- Durable and reliable
- Long aluminum body enables insertion even into very high ducts
- Soft plastic ergonomic handle
- Colour-coded for easy identification for use with correct rivets



Rivet Tools HTWD-RT4, -RT6.

<b>MATERIAL</b>	Metal (MET), Plastic (PL)
-----------------	---------------------------



TYPE	For Wiring Duct Rivets	Weight	Colour	Article-No.
HTWD-RT4	R4	0.5 kg	Blue (BU)	181-41542
HTWD-RT6	R6	0.5 kg	Orange (OG)	181-41564

All dimensions in mm. Subject to technical changes.