

HE. Oil level indicators

push-fit, polycarbonate



MATERIAL

Transparent high mechanical resistance polycarbonate. Not suitable for use with oils with additives and solvents. Avoid contact with alcohol or detergents containing alcohol.

CONTRAST SCREEN

White lacquered aluminium with red level line.

PACKING RING

NBR synthetic rubber O-Ring.

MAXIMUM CONTINUOUS WORKING TEMPERATURE

100°C.

FEATURES AND APPLICATIONS

The push-fit assembly is guaranteed by optimised ribbings. Sealing is guaranteed by the O-ring.

HE. oil level indicators push-fit are particularly suitable for assembly on reservoirs with limited pressure.

NOTE

For use with other fluids with special additives, please contact ELESAs Sales Department.

ASSEMBLY INSTRUCTIONS

Chamfer hole 1x45° and grease slightly the outside surface of the O-ring to make assembly easier.

GH. Nuts

Brass

MATERIAL

Brass.

FEATURES AND APPLICATIONS

GH. nuts can be used for fitting the following indicators to reservoirs with thin walls (thickness smaller than 5 mm):

- HGFT. (see page 1560)
- HGFT-EX (see page 1561)
- GN 743 (see page 1562)
- GN 743.1 (see page 1563)
- GN 743.2 (see page 1564)
- GN 743.3 (see page 1565)
- GN 743.4 (see page 1566)
- GN 743.5 (see page 1566)
- GN 743.6 (see page 1567)
- GN 7403 (see page 1570)
- HGFT-PR (see page 1571)
- HGFT-HT-PR (see page 1571)
- GN 744 (see page 1572)
- HFTX. (see page 1575)
- HFTX-EX (see page 1576)
- HFTX-PR (see page 1577)
- HFTR-PR (see page 1578)
- HCFE. (see page 1579)
- HCFE-C (see page 1579)
- HCFE-EX (see page 1580)



ELESAs Original design

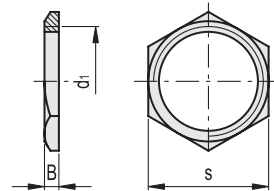
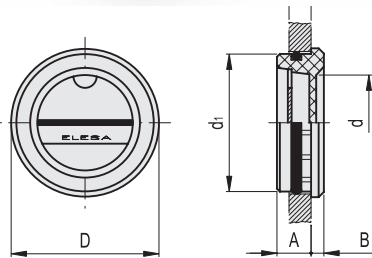

Code	Description	d1	A	B	D	d	Smin	Mounting hole d1 H11	⚖️
11401	HE.17	17	6.5	3	18	9	5	17	2
11501	HE.20	20	8	3	21	12	6	20	3
11601	HE.26	26	7.5	3.5	28	17	6	26	5
11701	HE.30	30	8	4	32	20	7	30	7
11801	HE.35	35	9	4	38	25	8	35	10
11901	HE.40	40	10	4.5	43	28	9	40	13
12001	HE.45	45	11	5.5	47	32	9	45	18

Code	Description	d1	B	s	⚖️
14991	GH. 1/4	G 1/4	6	19	9
15001	GH. 3/8	G 3/8	3	19	3
15011	GH. 1/2	G 1/2	4	26	8
15021	GH. 3/4	G 3/4	5	31	12
15031	GH. 1	G 1	4.5	37	14
15041	GH. 1¼	G1 1/4	5	46	23
15051	GH. 2	G 2	6	65	50