



Connectors > D-Shaped Connectors > D-Sub Accessories > Locking & Mounting



D-Shaped Connector Accessories: **Hardware Kits**

Screw Length: **6.35 mm [.25 in]**

Features

Product Type Features

Product Type	Accessory
D-Shaped Connector Accessories	Hardware Kits

Mechanical Attachment

Mounting Angle	Right Angle
Screw & Hole Thread Size	4-40 UNC
Screw Length	6.35 mm[.25 in]

Operation/Application

For Use With	180° Strain Relief Cover., ACTION PIN™ Connector, CHAMP Latch Low Profile Connectors, Right Angle PCB Connectors
--------------	--

Packaging Features

Packaging Quantity	1, 2
Packaging Method	Bag

Product Compliance

[For compliance documentation, visit the product page on TE.com>](#)

EU RoHS Directive 2011/65/EU	Compliant
EU ELV Directive 2000/53/EC	Compliant
China RoHS 2 Directive MIIT Order No 32, 2016	No Restricted Materials Above Threshold
EU REACH Regulation (EC) No. 1907/2006	Current ECHA Candidate List: JAN 2022 (223) Candidate List Declared Against: JAN 2022 (223)



	Does not contain REACH SVHC
Halogen Content	Low Halogen - Br, Cl, F, I < 900 ppm per homogenous material. Also BFR/CFR/PVC Free
Solder Process Capability	Not applicable for solder process capability

Product Compliance Disclaimer





This information is provided based on reasonable inquiry of our suppliers and represents our current actual knowledge based on the information they provided. This information is subject to change. The part numbers that TE has identified as EU RoHS compliant have a maximum concentration of 0.1% by weight in homogenous materials for lead, hexavalent chromium, mercury, PBB, PBDE, DBP, BBP, DEHP, DIBP, and 0.01% for cadmium, or qualify for an exemption to these limits as defined in the Annexes of Directive 2011/65/EU (RoHS2). Finished electrical and electronic equipment products will be CE marked as required by Directive 2011/65/EU. Components may not be CE marked. Additionally, the part numbers that TE has identified as EU ELV compliant have a maximum concentration of 0.1% by weight in homogenous materials for lead, hexavalent chromium, and mercury, and 0.01% for cadmium, or qualify for an exemption to these limits as defined in the Annexes of Directive 2000/53/EC (ELV). Regarding the REACH Regulation, the information TE provides on SVHC in articles for this part number is based on the latest European Chemicals Agency (ECHA) 'Guidance on requirements for substances in articles' posted at this URL: <https://echa.europa.eu/guidance-documents/guidance-on-reach>

Compatible Parts



TE Part # 229974-1
ASSY, PLUG, 50 POS, B SLOT

Also in the Series | CHAMP Docking Connectors

			
D-Sub Covers(28)	D-Sub Locking & Mounting(31)	Docking Connector Guide Hardware(5)	Docking Connectors(35)



IDC D-Sub Connectors(83)



PCB D-Sub Connectors(1)

Customers Also Bought

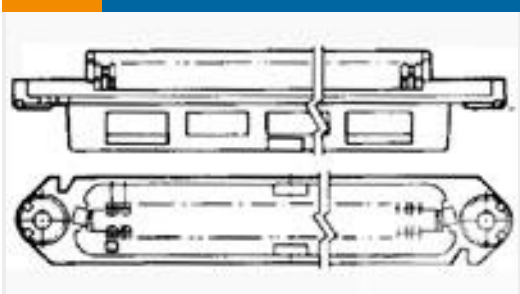

TE Part #552391-1
ASSY, RCPT, 50 POS, E SLOT



TE Part #485030-1
RING 18-14 AWG TPBR



TE Part #485043-4
SPLICE 4000-9000 .020 NPST

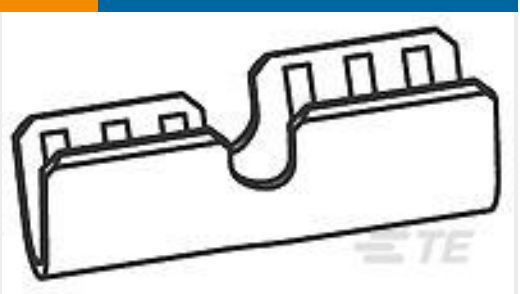

TE Part #61021-1
SPLICE 18-16 AWG .0126 NPST



TE Part #3-1418883-1
62.POS.MIXED REC.HSG



TE Part #2272975-1
6 Pos. Sealed MCON 1.2 Connect



TE Part #4-2103177-6
PLUG ASSY, KEY F, FA,CPA, HVA280-2PHI XE



TE Part #2840900-1
2POS,HC-STAK 25,REC OUTER HSG ASSY,PLUG

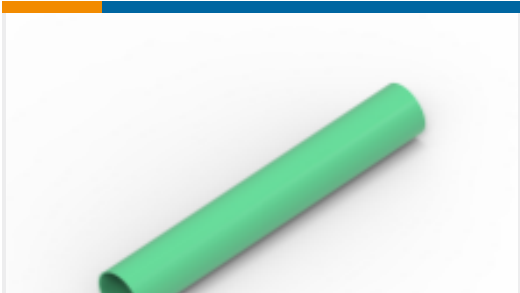

TE Part #NB20374001
VERSAFIT-3/16-5-SP

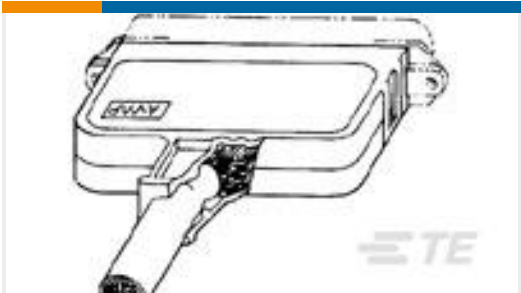

TE Part #3-552008-1
KIT, COVER, 180, 50 POS

Documents

Product Drawings
HWARE ASSY KIT

English

Product Environmental Compliance
TE Material Declaration

English