

## Magnets Accessories



■ Especially used for magnetic proximity sensors

### Dimensional drawings

MAG-1003-S (M1.0)

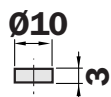

MAG-0625-A (M2.0)

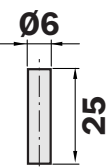

MAG-2006-B (M3.0)

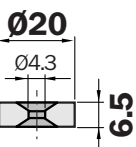

MAG-3010-B (M4.0)

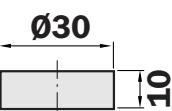

MAG-3015-B (M5.0)

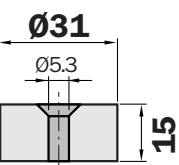

MAG-3515-B (M5.1)

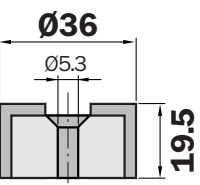

Technical data		MAG-	1003-S (M1.0)	0625-A (M2.0)	2006-B (M3.0)	3010-B (M4.0)	3015-B (M5.0)	3515-B (M5.1)				
<b>Magnet material</b>	Samarium-Cobalt SM2CO17		■									
	AlNiCo			■								
	Barium ferrite				■	■	■	■				
<b>Sheath material</b>	Polyamide PA6.6							■				
<b>Ambient temperature T<sub>A</sub></b>	-100 °C ... +450 °C			■								
	-50 °C ... +180 °C		■									
	-25 °C ... +130 °C				■	■	■					
	-25 °C ... +75 °C							■				

Order information	
Type	Order no.
MAG-1003-S (M1.0)	7 901 782
MAG-0625-A (M2.0)	7 901 783
MAG-2006-B (M3.0)	7 901 784
MAG-3010-B (M4.0)	7 901 785
MAG-3015-B (M5.0)	7 901 786
MAG-3515-B (M5.1)	7 902 086

**Great Britain**

Phone +44 (0)1727 83 11 21  
E-Mail: info@sick.co.uk

**USA**

Phone +1(952) 941-6780  
tollfree +1-800-325-7425  
E-Mail: info@sickusa.com

**Australia**

Phone +61 3 9497 4100  
tollfree +1800 33 48 02  
E-Mail: sales@sick.com.au

More representatives and agencies  
in all major industrial nations at  
[www.sick.com](http://www.sick.com)

**SICK**  
Waldkirch • Germany